

MAR 29 2000

SECTION

LAND CORNER RECORDATION CERTIFICATE
Filing Requirement of Act 74, Mich. P.A. 1970

Approved by Menominee County
Land Survey Remonumentation
Peer Group Under Act 345 Of
P.A. of 1990 On 12/28, 1999
Mc Davis RLS
Chairman

For corners in

MENOMINEE
(County)

Located In:

Corner Code #

- | | | |
|---------------------------------------|-----------------------------|-------------|
| 1. Public Land Survey | T <u>35</u> N R <u>28</u> W | <u>E-09</u> |
| | T ___ R ___ | _____ |
| | T ___ R ___ | _____ |
| | T ___ R ___ | _____ |
| 2. Property Controlling
in Section | S ___ T ___ R ___ | _____ |
| | S ___ T ___ R ___ | _____ |
| 3. Miscellaneous
Property in Sec. | S ___ T ___ R ___ | _____ |
| | S ___ T ___ R ___ | _____ |

BK. 6 Pg. 56

RECEIVED FOR RECORD
28 DEC 1999 3:56:09 PM
BARBARA MORRISON
REGISTER OF DEEDS
MENOMINEE, MI 49858

Register of Deeds Stamp & File Number

4. Lot No. _____, Recorded Plat _____
5. Private Claims _____

I, William Lenca, in a field survey on Nov., 1999 do hereby state that under requirements of P.A. 74, Michigan P.A. of 1970, the corner points mentioned in lines 1 and 2 above were in conformance with regulations and rules therefore as required in the current manual of survey instructions of the United States Department of the Interior, Bureau of Land Management or by a decree of a Court of Law and /or that the corner points mentioned in lines 3, 4 and 5 above were in conformance with the rules of the Michigan Board of Land Surveyors or by a Decree of a Court of Law; established, re-established, monumented, recovered, found as expressed below:

	A	B	C	D	E	F	G	H	I	J	K	L	M
1													
2		6		5		4		3		2		1	
3													
4		7		8		9		10		11		12	
5													
6		18		17		16		15		14		13	
7													
8		19		20		21		22		23		24	
9													
10		30		29		28		27		26		25	
11													
12		31		32		33		34		35		36	
13													

NOTE: Not more than 2 corners, all in the same town and range, may be recorded on this certificate.

A. Description of original monument and accessories and/or subsequent restoration:

- 1852: Original Survey by Francis Coleman - B.T.'s - Y. Pine, 24" - N26°W - 46 lks.; Y. Pine, 22" - S35°E - 12 lks. All original evidence for this corner has been destroyed by county road improvements.
1982: L.C.R.C. No. 551 by William Lenca states, "Set Railroad Spike in center of County Road No. 352 and in line with well established occupation north and south. This fits well with swamp tie to the west." TIES: Power Pole - N28°W - 49.72'; Power Pole - S60°E - 83.00';

B. Description of corner evidence found and/or method applied in restoring or reestablishing corner:

We recovered a railroad spike in the centerline of an East - West County Road in line with an ancient fence running North, and in a location matching with the ties described in LCRC No. 551 (see part "A"). This corner location fits well with existing lines of occupation, has been used by local surveyors for at least 17 years, and is accepted as the best available evidence of the position of the original corner.

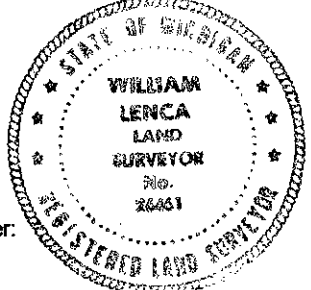

C. Description of monument for corner and accessories established to perpetuate locating the position of the corner:

Set 5/8" x 24" Iron Rod/3-1/4" dia. Alum. cap stamped for corner location in Monument Box:

- | | | | |
|--|---------|------------|-------------------------|
| 5/8" x 24" Iron Rod/2" Alum. cap marked WITNESS MARKER | N 08° E | 26.23 feet | 1' E of Fence Corner |
| 5/8" x 24" Iron Rod/2" Alum. cap marked WITNESS MARKER | S 42° E | 41.92 feet | 0.4' W. of F.N. W8895 |
| 5/8" x 24" Iron Rod/2" Alum. cap marked WITNESS MARKER | S 34° W | 39.18 feet | 0.5' W of F.N. W8901 |
| 5/8" x 24" Iron Rod/2" Alum. cap marked WITNESS MARKER | N 65° W | 53.00 feet | 0.5' S. of W. Gate Post |
| Metal Survey Sign Post | N 08° E | 26.6 feet | |

NOTE: All bearings are magnetic bearings. All distances are measured with steel tape. Distances to trees are to nail in side of tree.

Signed by William Lenca Date Nov. 23, 1999
Surveyor's Michigan License No. 26461

56