

**SURVEY &
REMONUMENTATION**

MAR 29 2000

SECTION

**LAND CORNER RECORDATION CERTIFICATE
Filing Requirement of Act 74, Mich. P.A. 1970**

Approved by Menominee County
Land Survey Remonumentation
Peer Group Under Act 345 Of
P.A. Of 1930 On 12/28, 1999
McDowell BLS
Chairman

For corners in

<u>MENOMINEE</u> (County)	Located In:	Corner Code #
1. Public Land Survey	T <u>35NR</u> R <u>28W</u>	<u>E-12</u>
	T <u> </u> R <u> </u>	<u> </u>
	T <u> </u> R <u> </u>	<u> </u>
	T <u> </u> R <u> </u>	<u> </u>
2. Property Controlling in Section	S <u> </u> T <u> </u> R <u> </u>	<u> </u>
	S <u> </u> T <u> </u> R <u> </u>	<u> </u>
3. Miscellaneous Property in Sec.	S <u> </u> T <u> </u> R <u> </u>	<u> </u>
	S <u> </u> T <u> </u> R <u> </u>	<u> </u>

BK. L Pg. 59

RECEIVED FOR RECORD
28 DEC 1999 3:56:09 PM
BARBARA MORRISON
REGISTER OF DEEDS
MENOMINEE, MI 49858

Register of Deeds Stamp & File Number

4. Lot No. _____, Recorded Plat _____
5. Private Claims _____

I, William Lenca, in a field survey on Nov., 1999 do hereby state that under requirements of P.A. 74, Michigan P.A. of 1970, the corner points mentioned in lines 1 and 2 above were in conformance with regulations and rules therefore as required in the current manual of survey instructions of the United States Department of the Interior, Bureau of Land Management or by a decree of a Court of Law and for that the corner points mentioned in lines 3, 4 and 5 above were in conformance with the rules of the Michigan Board of Land Surveyors or by a Decree of a Court of Law; established, re-established, monumented, recovered, found as expressed below:

NOTE: Not more than 2 corners, all in the same town and range, may be recorded on this certificate.

	A	B	C	D	E	F	G	H	I	J	K	L	M
1													
2	6		5		4		3		2		1		
3													
4	7		8		9		10		11		12		
5													
6	18		17		16		15		14		13		
7													
8	19		20		21		22		23		24		
9													
10	30		29		28		27		26		25		
11													
12	31		32		33		34		35		36		
13													

A. Description of original monument and accessories and/or subsequent restoration:

- 1852: Original Survey by Francis Coleman - B.T.'s - Sugar, 10" - N38°E - 20 lks.; Beech, 8" - S85°W - 19 lks. All original evidence for this corner has been destroyed by county road improvements.
- 1989: L.C.R.C. No. 858 by William Lenca states, "Set corner on line and midway between NE Corner and SE Corner of Section 32." Set 5/8" x 24" Iron Rod / Ident. cap. TIES: Maple, 14" - N49°E - 79.05'; Maple, 5" - S69°E - 60.56'; Maple, 8" - S43°W - 32.89'; W. Birch, 6" - N56°W - 36.89'.

B. Description of corner evidence found and/or method applied in restoring or reestablishing corner:

We recovered a 5/8 inch x 24 inch re-rod at a single proportional location between the NE Corner and the SE Corner of Section 32, T35N-R28W. We also found 4 B.T.'s as described in LCRC No. 858 (see part "A") fitting the corner location. The corner falls 6 feet West of the centerline of a North - South gravel surface County Road, and is accepted as a careful and faithful reestablishment of the position of the original corner.

C. Description of monument for corner and accessories established to perpetuate locating the position of the corner:

Set 2" dia. Aluminum Pipe 30" long/3-1/4" dia. Alum cap stamped for corner location:

Twin 14" dia. Maples	N49°E	79.05 feet	Scr. NBT
7" dia. Maple (Ex. B.T.)	S69°E	60.57 feet	Cross Cut in upper & lower blaze
9" dia. Maple (Ex. B.T.)	S43°W	32.89 feet	Cross Cut in upper & lower blaze
6" dia. Maple	N60°W	38.74 feet	Scr. NBT
Metal Survey Sign Post	East	31.35 feet	

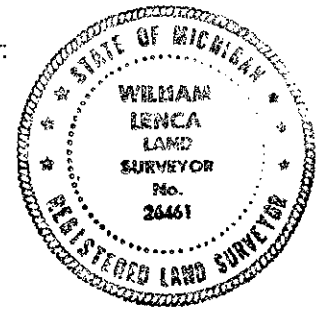

NOTE: All bearings are magnetic bearings. All distances are measured with steel tape. Distances to trees are to nail in side of tree.

Signed by William Lenca
Surveyor's Michigan License No. 26461

Date Dec. 3, 1999