

MAR 29 2000

SECTION

LAND CORNER RECORDATION CERTIFICATE  
Filing Requirement of Act 74, Mich. P.A. 1970

Approved by Menominee County  
Land Survey Remonumentation  
Peer Group Under Act 345 Of  
P.A. Of 1990 On 12/28 1999  
McL Davis BLS  
Chairman

For corners in

MENOMINEE (County)	Located In:	Corner Code #
1. Public Land Survey	T <u>35N</u> R <u>28W</u>	<u>F-09</u>
	T <u>    </u> R <u>    </u>	<u>    </u>
	T <u>    </u> R <u>    </u>	<u>    </u>
	T <u>    </u> R <u>    </u>	<u>    </u>
2. Property Controlling in Section	S <u>    </u> T <u>    </u> R <u>    </u>	<u>    </u>
	S <u>    </u> T <u>    </u> R <u>    </u>	<u>    </u>
3. Miscellaneous Property in Sec.	S <u>    </u> T <u>    </u> R <u>    </u>	<u>    </u>
	S <u>    </u> T <u>    </u> R <u>    </u>	<u>    </u>

Bk. 6 Pg. 60

RECEIVED FOR RECORD  
28 DEC 1999 3:56:09 PM  
BARBARA MORRISON  
REGISTER OF DEEDS  
MENOMINEE, MI 49858

Register of Deeds Stamp & File Number

4. Lot No. \_\_\_\_\_, Recorded Plat \_\_\_\_\_  
5. Private Claims \_\_\_\_\_

I, William Lenca, in a field survey on Nov., 1999 do hereby state that under requirements of P.A. 74, Michigan P.A. of 1970, the corner points mentioned in lines 1 and 2 above were in conformance with regulations and rules therefore as required in the current manual of survey instructions of the United States Department of the Interior, Bureau of Land Management or by a decree of a Court of Law and /or that the corner points mentioned in lines 3, 4 and 5 above were in conformance with the rules of the Michigan Board of Land Surveyors or by a Decree of a Court of Law; established, re-established, monumented, recovered, found as expressed below:

NOTE: Not more than 2 corners, all in the same town and range, may be recorded on this certificate.

	A	B	C	D	E	F	G	H	I	J	K	L	M
1													
2	6		5		4		3		2		1		
3													
4	7		8		9		10		11		12		
5													
6	18		17		16		15		14		13		
7													
8	19		20		21		22		23		24		
9													
10	30		29		28		27		26		25		
11													
12	31		32		33		34		35		36		
13													

A. Description of original monument and accessories and/or subsequent restoration:

- 1852: Original Survey by Francis Coleman - B.T.'s - Beech, 10" - N70°E - 13 lks.; Fir, 8" - S74°W - 10 lks. All original evidence for this corner has been destroyed by county road improvements.
- 1982: L.C.R.C. No. 550 by William Lenca states, "Set corner on line with Section corners to the east and west and in line with old fence line to the north." Set Railroad Spike in center of east - west County Road. TIES: Maple, 14" - N27°E - 49.33'; Maple, 10" - S10°W - 45.48'; Power Pole - N54°W - 103.29'.

B. Description of corner evidence found and/or method applied in restoring or reestablishing corner:

We recovered a railroad spike on line between the NE and NW Corners of Section 28, and in line with an old fence line to the North in a location matching with the ties described in LCRC No. 550 (see part "A"). The corner falls in the centerline of County Road G-12, fits well with measurements to other corners in the area, and is accepted as the best available evidence of the position of the original corner.

C. Description of monument for corner and accessories established to perpetuate locating the position of the corner:

Set 5/8" x 24" Iron Rod/3-1/4" dia. Alum. cap stamped for corner location in Monument Box:

14" dia. Maple (Ex. B.T.)	N27° E	49.47 feet	Scr. NBT
12" dia. White Pine	S38° E	94.69 feet	Scr. NBT
10" dia. Maple (Ex. B.T.)	S10° W	45.48 feet	Scr. NBT
9" dia. Cedar	S46° W	101.26 feet	Scr. NBT
Metal Survey Sign Post	South	34.75 feet	

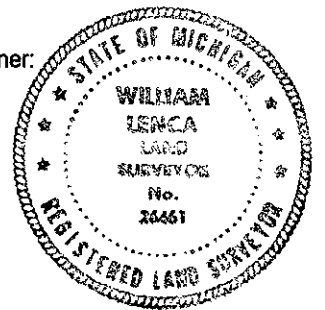

NOTE: All bearings are magnetic bearings. All distances are measured with steel tape. Distances to trees are to nail in side of tree.

Signed by William Lenca  
Surveyor's Michigan License No. 26461

Date Nov. 23, 1999