

APR 06 1999

SECTION

LAND CORNER RECORDATION CERTIFICATE
Filing Requirement of Act 74, Mich. P.A. 1970

Approved by Menominee County
Land Survey Remonumentation
Peer Group Under Act 345 Of
P.A. Of 1990 On 12/30, 1998
Mike Davis RLS
Chairman

For corners in

MENOMINEE
(County)

Located In:

Corner Code #

1. Public Land Survey

T 35N R 28W G-13

T _____ R _____

T _____ R _____

T _____ R _____

2. Property Controlling
in Section

S _____ T _____ R _____

S _____ T _____ R _____

3. Miscellaneous
Property in Sec.

S _____ T _____ R _____

S _____ T _____ R _____

RECEIVED FOR RECORD
99 JAN -6 AM 8:54
PAGE # 704 BKS
BARBARA MORRISON
REGISTER OF DEEDS
MENOMINEE, MI 49858

Register of Deeds Stamp & File Number

4. Lot No. _____, Recorded Plat _____

5. Private Claims _____

(SAME AS CORNER G-01, T34N - R28W.)

I, William Lenca, in a field survey on Nov. 20, 1998 do hereby state that under requirements of P.A. 74, Michigan P.A. of 1970, the corner points mentioned in lines 1 and 2 above were in conformance with regulations and rules therefore as required in the current manual of survey instructions of the United States Department of the Interior, Bureau of Land Management or by a decree of a Court of Law and/or that the corner points mentioned in lines 3, 4 and 5 above were in conformance with the rules of the Michigan Board of Land Surveyors or by a Decree of a Court of Law; established, re-established, monumented, recovered, found as expressed below:

NOTE: Not more than 2 corners, all in the same town and range, may be recorded on this certificate.

1	A	B	C	D	E	F	G	H	I	J	K	L	M
2		6		5		4		3		2		1	
3													
4		7		8		9		10		11		12	
5													
6		18		17		16		15		14		13	
7													
8		19		20		21		22		23		24	
9													
10		30		29		28		27		26		25	
11													
12		31		32		33		34		35		36	
13													

A. Description of original monument and accessories and/or subsequent restoration:

- 1848: Original Survey - Township Boundary - by H. Brevoort, Jr. - B.T.'s - Cedar, 10" - N43°E - 09 lks.; Cedar, 10" - N73°W - 05 lks. All original evidence for this corner has been destroyed by county road improvements.
- 1852: Original Survey - Sectional Subdivision - by Francis Coleman - B.T.'s - W. Birch, 10" - S71°E - 37 lks.; Cedar, 8" - S77°W - 04 lks. All original evidence for this corner has been destroyed by county road improvements.

B. Description of corner evidence found and/or method applied in restoring or reestablishing corner:

We set this corner in the centerline of an East - West county road and at the single proportionate distance between the Southeast corner of Section 34 and the Southwest corner of Section 33, T35N - R28W. This location fits reasonably well with GLO calls to swamp edges 165 feet West and 235 feet North, and is accepted as a careful and faithful re-establishment of the position of the original corner.

C. Description of monument for corner and accessories established to perpetuate locating the position of the corner:

Set 2" dia. Aluminum Pipe 30" long/3-1/4" dia. Alum. cap stamped for corner location:

12" dia. Cedar	S63°E	75.91 feet	"X" cut in upper and lower blazes
5" dia. Ironwood	S17°E	45.65 feet	"X" cut in upper and lower blazes
11" dia. Cedar	S42°W	56.73 feet	"X" cut in upper and lower blazes
7" dia. Cedar	S70°W	71.15 feet	"X" cut in upper and lower blazes
Metal Survey Sign Post	North	32.2 feet	

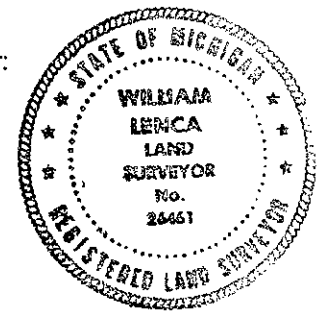

NOTE: All bearings are magnetic bearings. All distances are measured with steel tape. Distances to trees are to nail in side of tree.

Signed by William Lenca

Date Dec. 22, 1998

Surveyor's Michigan License No. 26461