

MAR 29 2000

SECTION

LAND CORNER RECORDATION CERTIFICATE
Filing Requirement of Act 74, Mich. P.A. 1970

Approved by Menominee County
Land Survey Remonumentation
Peer Group Under Act 345 Of
P.A. Of 1990 On 12/03 1999
McC. Anvil PLS
Chairman

For corners in

<u>MENOMINEE</u> (County)	Located In:	Corner Code #
1. Public Land Survey	T <u>35</u> N R <u>28</u> W	<u>H-07</u>
	T ___ R ___	_____
	T ___ R ___	_____
	T ___ R ___	_____
2. Property Controlling in Section	S ___ T ___ R ___	_____
	S ___ T ___ R ___	_____
3. Miscellaneous Property in Sec.	S ___ T ___ R ___	_____
	S ___ T ___ R ___	_____

BK. 6 Pg 66

RECEIVED FOR RECORD
28 DEC 1999 3:56:09 PM
BARBARA MORRISON
REGISTER OF DEEDS
MENOMINEE, MI 49858

Register of Deeds Stamp & File Number

4. Lot No. _____, Recorded Plat _____
5. Private Claims _____

I, William Lenca, in a field survey on Aug. 19 99 do hereby state that under requirements of P.A. 74, Michigan P.A. of 1970, the corner points mentioned in lines 1 and 2 above were in conformance with regulations and rules therefore as required in the current manual of survey instructions of the United States Department of the Interior, Bureau of Land Management or by a decree of a Court of Law and /or that the corner points mentioned in lines 3, 4 and 5 above were in conformance with the rules of the Michigan Board of Land Surveyors or by a Decree of a Court of Law; established, re-established, monumented, recovered, found as expressed below:

NOTE: Not more than 2 corners, all in the same town and range, may be recorded on this certificate.

	A	B	C	D	E	F	G	H	I	J	K	L	M
1													
2		6		5		4		3		2		1	
3													
4		7		8		9		10		11		12	
5													
6		18		17		16		15		14		13	
7								21		22		23	
8		19		20		21		22		23		24	
9													
10		30		29		28		27		26		25	
11													
12		31		32		33		34		35		36	
13													

A. Description of original monument and accessories and/or subsequent restoration:

- 1852: Original Survey by Francis Coleman - B.T.'s - Tamarack, 6" - N06°W - 34 lks.; Tamarack, 8" - S18°E - 44 lks. Long stub of original Tamarack B.T. (Tam, 6" - N06°W - 34 links) down and still in fair condition.
- 1960: L.C.R.C. No. 48 by Billy D. Buckler states corner was replaced from 2 Tamarack B.T.'s bearing N08°W, 32 lks, stub in excellent condition and S18°E, 44 lks, stump in poor condition. Corner lies on north bank of stream. Set 1" Pipe with 4" Brass Cap.

B. Description of corner evidence found and/or method applied in restoring or reestablishing corner:

We found 2 Cedar B.T.'s as described in LCRC No. 48, Volume 2 (see part "A" above), but were unable to recover the monument. The bank of the stream has eroded in this area and the action of the water and ice has destroyed the monument. The corner position was re-monumented from 2 Cedar B.T.'s as described in LCRC No. 48. The corner falls in the water on the North edge of a stream and on line with an old brush line running East and West. Since this corner was replaced from Original Bearing Trees, we accepted this location as a careful and faithful perpetuation of the position of the original corner.

C. Description of monument for corner and accessories established to perpetuate locating the position of the corner:

Set 3/4" dia. x 4' long aluminum rod/3-1/4" dia. Alum. cap stamped for corner inside a 1-1/2" x 40" Iron Pipe.

14" dia. Maple	N45°E	13.72 feet	Scr. NBT
7" dia. Cedar	S62°E	32.45 feet	Scr. NBT
10" dia. Cedar	S30°W	48.28 feet	Scr. NBT
10" dia. Maple	N56°W	28.67 feet	Scr. NBT
Metal Survey Sign Post	North	2.75 feet	

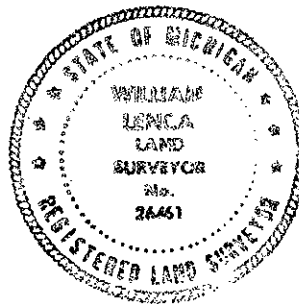

NOTE: All bearings are magnetic bearings. All distances are measured with steel tape. Distances to trees are to nail in side of tree.

Signed by William Lenca
Surveyor's Michigan License No. 24461

Date Aug. 31, 1999