

SURVEY & REMONUMENTATION

OCT 27 1999

SECTION

LAND CORNER RECORDATION CERTIFICATE
Filing Requirement of Act 74, Mich. P.A. 1970

Approved by Menominee County
Land Survey Remonumentation
Peer Group Under Act 345 Of

P.A. Of 1990 On 10/1, 1999

RECEIVED FOR RECORD
99 OCT 15 PM 1:40
Chairman
BARBARA MORRISON
REGISTER OF DEEDS
MENOMINEE, MI 49855

For corners in

MENOMINEE
(County)

Located In:

Corner Code #

1. Public Land Survey

T 36N R 28W I-13

T _____ R _____

T _____ R _____

T _____ R _____

2. Property Controlling in Section

S _____ T _____ R _____

3. Miscellaneous Property in Sec.

S _____ T _____ R _____

S _____ T _____ R _____

4. Lot No. _____, Recorded Plat _____

5. Private Claims _____

Register of Deeds Stamp & File Number

A	B	C	D	E	F	G	H	I	J	K	L	M
1												
2	6		5		4		3		2		1	
3												
4	7		8		9		10		11		12	
5												
6	18		17		16		15		14		13	
7												
8	19		20		21		22		23		24	
9												
10	30		29		28		27		26		25	
11												
12	31		32		33		34		35		36	
13												

SAME AS CORNER I-1, T35N-R28W

I, William Lenca, in a field survey on Feb, 1999 do hereby state that under requirements of P.A. 74, Michigan P.A. of 1970, the corner points mentioned in lines 1 and 2 above were in conformance with regulations and rules therefore as required in the current manual of survey instructions of the United States Department of the Interior, Bureau of Land Management or by a decree of a Court of Law and/or that the corner points mentioned in lines 3, 4 and 5 above were in conformance with the rules of the Michigan Board of Land Surveyors or by a Decree of a Court of Law; established, re-established, monumented, recovered, found as expressed below:

NOTE: Not more than 2 corners, all in the same town and range, may be recorded on this certificate.

A. Description of original monument and accessories and/or subsequent restoration:

1848: Original Survey by H. Brevoort - B.T.'s - Tamarack, 20" - N81°W - 17 lks; Cedar, 9" - N19°E - 30 lks. Evidence of Tamarack stump still visible - poor condition.

1953: L.C.R.C. No. 911 (Vol. 3) by Dean DeLamater, RLS, - This corner was pointed out to me by C. Limpert, District Forester. Three original B.T.'s still in place, good condition. Set 1" pipe/4" B.C. - B.T.'s: 8" W. Pine - S80°W - 15 lks; 8" Cedar - N02°E - 17 lks; 5" Cedar - S70°E - 12 lks.

B. Description of corner evidence found and/or method applied in restoring or reestablishing corner:

We found a 1 inch diameter iron pipe with a 4 inch diameter Brass Cap stamped for corner location along with a White Pine B.T. - S80°W - 15 links (9.9 feet) in location as described in L.C.R.C. No. 911, Volume 3 (see part "A"). Since this corner was perpetuated from original evidence, we accepted the position of the existing monument as a careful and faithful perpetuation of the position of the original corner.

C. Description of monument for corner and accessories established to perpetuate locating the position of the corner:

Accepted Existing 1 dia. Iron Pipe/4" Brass Cap stamped for corner location.

8" dia. Cedar	S64°E	7.68 feet	Scr. NBT
7" dia. Cedar	S02°E	18.87 feet	Scr. NBT
16" dia. White Pine (Ex. B.T.)	S80°W	10.53 feet	(9.9' R) Scr. NBT
7" dia. Cedar	N02°W	6.06 feet	Scr. NBT
Metal Survey Sign Post	West	1.1 feet	

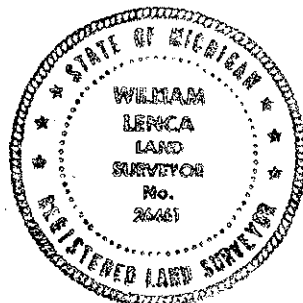

NOTE: All bearings are magnetic bearings. All distances are measured with steel tape. Distances to trees are to nail in side of tree.

Signed by William Lenca

Date Sep. 15, 1999

Surveyor's Michigan License No. 26461