

REM.

MAR 29 2000

SECTION

LAND CORNER RECORDATION CERTIFICATE  
Filing Requirement of Act 74, Mich. P.A. 1970

Approved by Menominee County  
Land Survey Recommendation  
Peer Group Under Act 345 Of  
P.A. Of 1999 On 12/28 1999  
McL Davis RLS  
Chairman

For corners in

MENOMINEE  
(County)

Located In:

Corner Code #

- 1. Public Land Survey      T 35NR 28W      I-12  
                                          T    R  
                                          T    R  
                                          T    R
- 2. Property Controlling    S    T    R  
    in Section                S    T    R
- 3. Miscellaneous            S    T    R  
    Property in Sec.         S    T    R

Bk. 6 Pg. 72

RECEIVED FOR RECORD  
28 DEC 1999 3:56:09 PM  
BARBARA MORRISON  
REGISTER OF DEEDS  
MENOMINEE, MI 49858

Register of Deeds Stamp & File Number

- 4. Lot No. \_\_\_\_\_, Recorded Plat \_\_\_\_\_
- 5. Private Claims \_\_\_\_\_

I, William Lenca, in a field survey on Dec., 19 99 do hereby state that under requirements of P.A. 74, Michigan P.A. of 1970, the corner points mentioned in lines 1 and 2 above were in conformance with regulations and rules therefore as required in the current manual of survey instructions of the United States Department of the Interior, Bureau of Land Management or by a decree of a Court of Law and /or that the corner points mentioned in lines 3, 4 and 5 above were in conformance with the rules of the Michigan Board of Land Surveyors or by a Decree of a Court of Law; established, re-established, monumented, recovered, found as expressed below:

NOTE: Not more than 2 corners, all in the same town and range, may be recorded on this certificate.

	A	B	C	D	E	F	G	H	I	J	K	L	M
1													
2		6		5		4		3		2		1	
3													
4		7		8		9		10		11		12	
5													
6		10		17		16		15		14		13	
7													
8		19		20		21		22		23		24	
9													
10		30		29		28		27		26		25	
11													
12		31		32		33		34		35		36	
13													

A. Description of original monument and accessories and/or subsequent restoration:

1852: Original Survey by Francis Coleman - B.T.'s - Y. Pine, 20" - N55°W - 43 lks.; Sugar, 6" - S64°E - 43 lks. All original evidence for this corner has been destroyed by county road improvements.

B. Description of corner evidence found and/or method applied in restoring or reestablishing corner:

In a retracement of the East Line of Section 34, T35N-R28W, we found no evidence of the original corner or subsequent restoration. There is no evidence of old fences at the 1/4 corner position or at the 1/16 corners to the North and South of this position. We therefore set the corner at a single proportional location between the NE Corner and the SE Corner of said Section 34, and accepted this location as a careful and faithful reestablishment of the position of the original corner.

C. Description of monument for corner and accessories established to perpetuate locating the position of the corner:

Set 2" dia. Aluminum Pipe 30" long/3-1/4" dia. Alum cap stamped for corner location:

- 8" dia. Maple                    N43°E      91.61 feet      Scr. NBT
- 8" dia. Maple                    S58°E      76.39 feet      Scr. NBT
- 7" dia. Maple                    S42°W      60.75 feet      Scr. NBT
- 7" dia. Maple                    N48°W      45.71 feet      Not Blazed
- Metal Survey Sign Post        East        52.60 feet

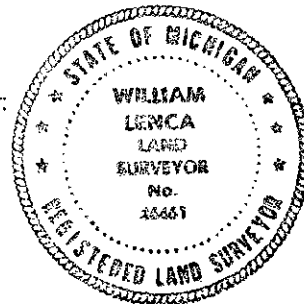

NOTE: All bearings are magnetic bearings. All distances are measured with steel tape. Distances to trees are to nail in side of tree.

Signed by William Lenca  
Surveyor's Michigan License No. 26461

Date Dec. 3, 1999