

Approved by Menominee County
Land Survey Remuneration
Peer Group Under Act 345 of

P.A. of 1990 On 9/25, 19996
McLain RLS
Chairman

LAND CORNER RECORDATION CERTIFICATE
Filing Requirement of Act 74, Mich. P.A. 1970

For corners in

MENOMINEE
(County)

Located In:	Corner Code #
T35N R 28W	105
T R	
T R	
T R	
S T R	
S T R	
S T R	
S T R	

- Public Land Survey
- Property Controlling in Section
- Miscellaneous Property in Sec.

REGISTERED FOR RECORD
96 OCT -7 PM 3:26
PAGE # 359 BH 4
BARBARA MORTISON
ADMINISTRATOR
REGISTER OF DEEDS
MICHIGAN

Register of Deeds Stamp & File Number

- Lot No. _____, Recorded Plat _____
- Private Claims _____

I, William Lenca, in a field survey on May 28, 1996 do hereby state that under requirements of P.A. 74, Michigan P.A. of 1970, the corner points mentioned in lines 1 and 2 above were in conformance with regulations and rules therefore as required in the current manual of survey instructions of the United States Department of the Interior, Bureau of Land Management or by a decree of a Court of Law and/or that the corner points mentioned in lines 3, 4 and 5 above were in conformance with the rules of the Michigan Board of Land Surveyors or by a Decree of a Court of Law; established, re-established, monumented, recovered, found as expressed below:

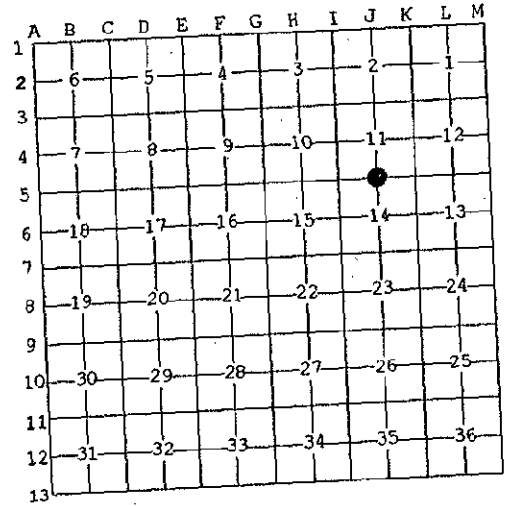

NOTE: Not more than 2 corners, all in the same town and range, may be recorded on this certificate.

A. Description of original monument and accessories and/or subsequent restoration:
1852: Original Survey by Francis Coleman - B.T.'s - Cedar, 12" - N50°W - 07 lks; W. Pine, 18" - S41°E - 38 lks. All original evidence for this corner has been destroyed by county road improvements.

B. Description of corner evidence found and/or method applied in restoring or reestablishing corner:
This corner was re-established by single proportionate measurement between the Southwest Corner (I-5) and the Southeast Corner (K-5) of Section 11. The corner thus established falls in the centerline of a gravel surface county road running East - West, and is accepted as a careful and faithful reestablishment of the position of the original corner.

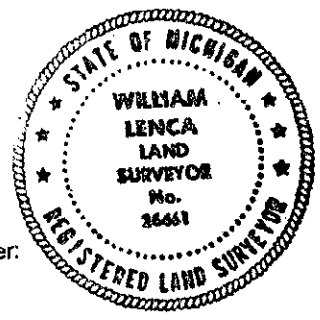

C. Description of monument for corner and accessories established to perpetuate locating the position of the corner:
Set 5/8" x 24" Iron Rod/3-1/4" dia. Alum. cap stamped for corner location:
10" dia. White Ash S69°E 47.58 feet Scr. NBT
9" dia. Elm S46°W 19.02 feet Scr. NBT
5/8" x 24" Iron/2" Alum. cap marked "WITNESS MARKER" N48°W 58.46 feet 1' E. of County Road sign post
Nothing else nearby

NOTE: All bearings are magnetic bearings. All distances are measured with steel tape. Distances to trees are to nail in side of tree.

Signed by William Lenca
Surveyor's Michigan License No. 26461

Date May 31, 1996

259