

MAR 29 2000

SECTION

LAND CORNER RECORDATION CERTIFICATE
Filing Requirement of Act 74, Mich. P.A. 1970

Approved by Menominee County
Land Survey Remonumentation
Peer Group Under Act 345 Of
P.A. of 1988 On 12/28 1999
Mc Davis BLS
Chairman

For corners in

MENOMINEE
(County)

Located In: Corner Code #

- | | | |
|------------------------------------|-----------------------------|-------------|
| 1. Public Land Survey | T <u>35</u> N R <u>28</u> W | <u>I-11</u> |
| | T ___ R ___ | _____ |
| | T ___ R ___ | _____ |
| | T ___ R ___ | _____ |
| 2. Property Controlling in Section | S ___ T ___ R ___ | _____ |
| | S ___ T ___ R ___ | _____ |
| 3. Miscellaneous Property in Sec. | S ___ T ___ R ___ | _____ |
| | S ___ T ___ R ___ | _____ |

Bk. 6 Pg. 73

RECEIVED FOR RECORD
28 DEC 1999 3:56:09 PM
BARBARA MORRISON
REGISTER OF DEEDS
MENOMINEE, MI 49858

Register of Deeds Stamp & File Number

4. Lot No. _____, Recorded Plat _____
5. Private Claims _____

I, William Lenca, in a field survey on Dec., 1999 do hereby state that under requirements of P.A. 74, Michigan P.A. of 1970, the corner points mentioned in lines 1 and 2 above were in conformance with regulations and rules therefore as required in the current manual of survey instructions of the United States Department of the Interior, Bureau of Land Management or by a decree of a Court of Law and /or that the corner points mentioned in lines 3, 4 and 5 above were in conformance with the rules of the Michigan Board of Land Surveyors or by a Decree of a Court of Law; established, re-established, monumented, recovered, found as expressed below:

A	B	C	D	E	F	G	H	I	J	K	L	M
1												
2	6	5	4	3	2	1						
3												
4	7	8	9	10	11	12						
5												
6	18	17	16	15	14	13						
7												
8	19	20	21	22	23	24						
9												
10	30	29	28	27	26	25						
11												
12	31	32	33	34	35	36						
13												

NOTE: Not more than 2 corners, all in the same town and range, may be recorded on this certificate.

A. Description of original monument and accessories and/or subsequent restoration:

1852: Original Survey by Francis Coleman - B.T.'s - W. Pine, 24" - N74°E - 47 lks.; W. Pine, 12" - S58°W - 40 lks. All original evidence for this corner has been destroyed by logging activities.

B. Description of corner evidence found and/or method applied in restoring or reestablishing corner:

We computed the single proportional location for this corner, traversed in to it and searched the area. We found no evidence of the original corner accessories, or evidence of subsequent restoration. The single proportional location fits well with a GLO call to a stream 3 chains West, and is accepted as a careful and faithful reestablishment of the position of the original corner.

C. Description of monument for corner and accessories established to perpetuate locating the position of the corner:

Set 1/2" x 8" Iron Rod with 3-1/4" dia. Alum. cap stamped for corner location in stump of 20" dia. Oak:

Stump of 15" twin Oaks	N10°W	32.04 feet	Scr. NBT
5" dia. Maple	S72°E	21.40 feet	Scr. NBT
7" dia. Maple	S12°E	59.21 feet	Scr. NBT
9" dia. Black Ash	N72°W	84.22 feet	Scr. NBT
Metal Survey Sign Post	North	1.6 feet	

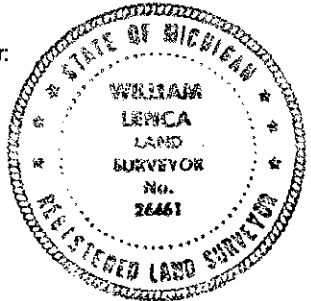

NOTE: All bearings are magnetic bearings. All distances are measured with steel tape. Distances to trees are to nail in side of tree.

Signed by William Lenca
Surveyor's Michigan License No. 26461

Date Dec. 17, 1998