

SURVEY & REMONUMENTATION

JAN 09 2001

SECTION

LAND CORNER RECORDATION CERTIFICATE Filing Requirement of Act 74, Mich. P.A. 1970

Approved by Menominee County
Land Survey Remonumentation
Peer Group Under Act 345 of
P.A. of 1990 On 12/22, 2000
Mr. Davis RLS
Chairman

Bk. 6 Pg. 217

RECEIVED FOR RECORD
28 DEC 2000 2:31:31 PM
BARBARA MORRISON
REGISTER OF DEEDS
MENOMINEE, MI 49858

Register of Deeds Stamp & File Number

For corners in
MENOMINEE

(County)

Located In: Corner Code #

	35N	27W	A-03
1. Public Land Survey	T	R	
	T	R	
	T	R	
	T	R	
2. Property Controlling in Section	S	T	R
	S	T	R
3. Miscellaneous Property in Sec.	S	T	R
	S	T	R

4. Lot No. _____, Recorded Plat _____

5. Private Claims
(SAME AS CORNER M-03 T35N - R28W)

William Lenca, Nov. 00
I, _____, in a field survey on _____, 19____ do hereby state that under requirements of P.A. 74, Michigan P.A. of 1970, the corner points mentioned in lines 1 and 2 above were in conformance with regulations and rules therefore as required in the current manual of survey instructions of the United States Department of the Interior, Bureau of Land Management or by a decree of a Court of Law and/or that the corner points mentioned in lines 3, 4 and 5 above were in conformance with the rules of the Michigan Board of Land Surveyors or by a Decree of a Court of Law, established, re-established, monumented, recovered, found as expressed below:

NOTE: Not more than 2 corners, all in the same town and range, may be recorded on this certificate.

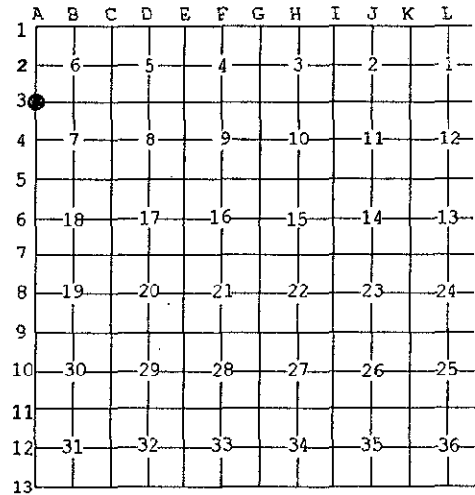

A. Description of original monument and accessories and/or subsequent restoration:

- 1847: Original Survey by H. Floyd - B.T.'s - W. Birch, 10" - N40°W - 23 lks.; Spruce, 12" - S53°W - 32 lks. All original evidence for this corner has been destroyed by logging activities.
- 1848: Original Survey (Sec. Subd.) by James H. Mullett - B.T.'s - Beech, 10" - N74°E - 14 lks.; W. Pine, 18" - S30°E - 24 lks. All original evidence for this corner has been destroyed by logging activities.
- 1986: Certified Survey No. 468 by William Lenca, RLS No. 26461, shows this corner as it relates to other corners in Section 12, T35N-R28W. My field notes indicate that we set an HDR5' aluminum rod monument with 3-1/4" alum. cap at an ancient fence corner. TIES: 18" W. Pine - N68°E - 16.85'; Maple, 5" - S40°E - 57.35'; Maple, 8" - N38°W - 38.30'; Maple, 8" - S40°W - 33.41'.

B. Description of corner evidence found and/or method applied in restoring or reestablishing corner:

We found an HDR5' aluminum rod monument with 3-1/4 inch diameter cap and 4 B.T.'s in place as described in my 1986 survey (see part A). The corner falls at an ancient fence corner with fences running North and West and a newer single strand fence running East. This position fits well with measurements to other corners in the area, and is accepted as the best available evidence of the position of the original corner.

C. Description of monument for corner and accessories established to perpetuate locating the position of the corner:

Accepted existing 3/4" x 5' long aluminum rod/3-1/4" dia. Alum. cap stamped for corner:

22" dia. White Pine	N68°E	16.85 feet	Scr. NBT
7" dia. Maple	S40°E	57.35 feet	Scr. NBT
10" dia. Maple	S40°W	33.41 feet	Scr. NBT
10" dia. Maple	N38°W	38.20 feet	Scr. NBT
Carsonite Marker	North	0.8 feet	

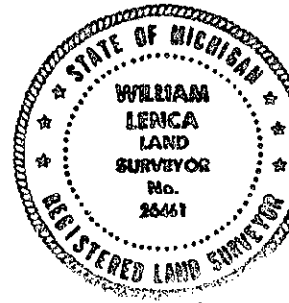

NOTE: All bearings are magnetic bearings. All distances are measured with steel tape. Distances to trees are to nail in side of tree.

Signed by William Lenca
Surveyor's Michigan License No. 26461

Date Dec. 21, 2000