

LAND CORNER RECORDATION CERTIFICATE
 Filing Requirement of Act 74, Mich. P.A. 1970

For corners in

MENOMINEE (County)	Located In:	Corner Code #
1. Public Land Survey	T35N R. 29W	J-5
	T R	
	T R	
	T R	
2. Property Controlling in Section	S T R	
	S T R	
3. Miscellaneous Property in Sec.	S T R	
	S T R	

REGISTERED FOR RECORD
 97 JUL 23 PM 3:34
 PAGE # 494 BK 5
 BARBARA HARRISON
 REGISTER OF DEEDS
 MENOMINEE, MICHIGAN
 Register of Deeds Stamp & File Number

4. Lot No. _____, Recorded Plat _____
 5. Private Claims _____

I, William Lenca, in a field survey on June 26, 19 97 do hereby state that under requirements of P.A. 74, Michigan P.A. of 1970, the corner points mentioned in lines 1 and 2 above were in conformance with regulations and rules therefore as required in the current manual of survey instructions of the United States Department of the Interior, Bureau of Land Management or by a decree of a Court of Law and /or that the corner points mentioned in lines 3, 4 and 5 above were in conformance with the rules of the Michigan Board of Land Surveyors or by a Decree of a Court of Law, established, re-established, monumented, recovered, found as expressed below:

NOTE: Not more than 2 corners, all in the same town and range, may be recorded on this certificate.

1	A	B	C	D	E	F	G	H	I	J	K	L	M
2		6		5		4		3		2		1	
3													
4		7		8		9		10		11		12	
5										●			
6		10		17		16		15		14		13	
7													
8		19		20		21		22		23		24	
9													
10		30		29		28		27		26		25	
11													
12		31		32		33		34		35		36	
13													

A. Description of original monument and accessories and/or subsequent restoration:

- 1852: Original Survey by Francis Coleman - B.T.'s - Spruce Pine, 10" - N76°E - 12 lks.; Spruce Pine, 10" - S47°W - 12 lks. All original evidence for this corner has been destroyed by county road improvements.
- 1963: L.C.R.C. No. 414 (Vol. 2) by Billy D. Buckler, states "3/8" x 16" iron bar buried in road according to testimony of Robert Olsen." B.T.'s: 10" Jack Pine - S88°W - 64.5 lks; 9" Red Oak - S56°W - 57 lks; 9" Jack Pine - S59°E - 56 lks.

B. Description of corner evidence found and/or method applied in restoring or reestablishing corner:

We found a railroad spike on the Westerly edge of the asphalt in a curve in the county road, falling in line with the centerline of the road running to the North. We also found a 14" dia. Jack Pine scribed "1/4 S NBT" bearing S88°W, 64.5 links (42.57 feet) from the railroad spike. This matches the B.T. described in L.C.R.C. No. 414 (Vol. 2). This corner has been accepted and used by local surveyors for more than 35 years, and is accepted as the best available evidence of the position of the original corner.

C. Description of monument for corner and accessories established to perpetuate locating the position of the corner:
 Set 2" dia. Aluminum Pipe/3-1/4" dia. Alum cap stamped for corner location:

14" dia. Jack Pine (Ex. B.T.)	S73°W	42.57 feet	Scr. NBT
12" dia. Jack Pine	N35°E	102.09 feet	Scr. NBT
9" dia. Jack Pine	S52°E	63.97 feet	Scr. NBT
10" dia. Norway Pine	N15°W	123.68 feet	Scr. NBT
Metal Survey Sign Post	West	29.9 feet	

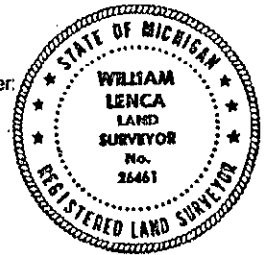

NOTE: All bearings are magnetic bearings. All distances are measured with steel tape. Distances to trees are to nail in side of tree.

Signed by William Lenca Date Jul. 09, 1997
 Surveyor's Michigan License No. 26461

REMONUMENTATIO:

DEC 28 1997

COMMISSION

494