

LAND CORNER RECORDATION CERTIFICATE
Filing Requirement of Act 74, Mich. P.A. 1970

P.A. of 1990 Ch. 783, 199 2
Mc Davis RLS
Chairman

For corners in
MENOMINEE
(County)

Located in: Corner Code #

1. Public Land Survey T5N R 29W K-8
T R
T R
T R

2. Property Controlling
in Section S T R
S T R

3. Miscellaneous
Property in Sec. S T R
S T R

4. Lot No. , Recorded Plat

5. Private Claims

REGISTERED FOR RECORD
97 JUL 23 PM 3:34
PAGE # 496 RLS
BARBARA MORRISON
REGISTER OF DEEDS
MENOMINEE, WISCONSIN

Register of Deeds Stamp & File Number

I, William Lenca, in a field survey on June 26, 1997 do hereby state that under requirements of P.A. 74, Michigan P.A. of 1970, the corner points mentioned in lines 1 and 2 above were in conformance with regulations and rules therefore as required in the current manual of survey instructions of the United States Department of the Interior, Bureau of Land Management or by a decree of a Court of Law and for that the corner points mentioned in lines 3, 4 and 5 above were in conformance with the rules of the Michigan Board of Land Surveyors or by a Decree of a Court of Law, established, re-established, monumented, recovered, found as expressed below:

NOTE: Not more than 2 corners, all in the same town and range, may be recorded on this certificate.

A	B	C	D	E	F	G	H	I	J	K	L	M
1												
2	6		5		4		3		2		1	
3												
4	7		8		9		10		11		12	
5												
6	10		17		16		15		14		13	
7												
8	19		20		21		22		23		24	
9												
10	30		29		28		27		26		25	
11												
12	31		32		33		34		35		36	
13												

A. Description of original monument and accessories and/or subsequent restoration:

- 1852: Original Survey by Francis Coleman - B.T.'s - Y. Pine, 18" - N60°E - 60 lks.; Y. Pine, 20" - S70°W - 72 lks. All original evidence for this corner has been destroyed by county road improvements.
- 1945: Record of Survey by M.S. McNabb, in his capacity as Deputy County Surveyor, established an iron bolt & wood stake on line and midway between Section Corners. B.T.'s: 8" Oak - N48°E - 20'; 7" Oak - S42°W - 21' (see page 9, County Surveyors Record Book.)
- 1987: L.C.R.C. No. 784 by William Lenca, RLS No. 26461, states "Found Iron Bolt set by M.S. McNabb in 1945 Survey." B.T.'s: 30" Oak - N70°E - 80.00'; 8" Oak - S72°W - 28.96'; Power Pole - N05°E - 41.04'; 4" dia. Iron Post (S. Gate Post) - West - 1.8'.

B. Description of corner evidence found and/or method applied in restoring or reestablishing corner:

We recovered a 1 inch square Iron Bolt in position matching closely with M.S. McNabb's record distances to Section Corners 1/2 mile North and 1/2 mile South. We also recovered the following B.T.'s from L.C.R.C. No. 784: 30" Oak - N70°E - 80.00'; 8" Oak - S72°W - 28.96'; 4" dia. Iron Gate Post - West - 1.8'. This corner has been used by local surveyors for over 50 years, and is accepted as the best available evidence of the position of the original corner.

C. Description of monument for corner and accessories established to perpetuate locating the position of the corner:
Set 2" dia. Aluminum Pipe/3-1/4" dia. Alum cap stamped for corner location over existing Iron Bolt:

30" dia. Oak (Existing B.T.)	N70°E	80.00 feet	Scr. NBT
5/8" x 24" Iron Rod/2" dia. Alum. cap marked "WITNESS MARKER"	S12°W	13.72 feet	
9" dia. Oak (Existing B.T.)	S73°W	28.96 feet	Scr. NBT
18" dia. Oak	N27°W	66.54 feet	Scr. NBT
Metal Survey Sign Post	S12°W	14.3 feet	

NOTE: All bearings are magnetic bearings. All distances are measured with steel tape. Distances to trees are to nail in side of tree.

Signed by William Lenca Date Jul, 09, 1997
Surveyor's Michigan License No. 26461

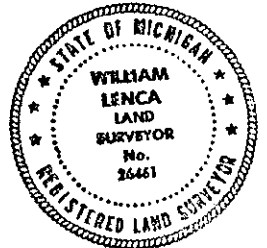

REMONUMENTATION

DEC 28 1997
COMMISSION

496