

Mr. Davis RLS
Chairman

LAND CORNER RECORDATION CERTIFICATE
Filing Requirement of Act 74, Mich. P.A. 1970

For corners in

MENOMINEE
(County)

Located In:

Corner Code #

1. Public Land Survey

T36N R 24W	G01
T R	
T R	
T R	
T R	

2. Property Controlling
in Section

S T R	
S T R	
S T R	
S T R	

3. Miscellaneous
Property in Sec.

S T R	
S T R	

RECEIVED FOR RECORD
96 OCT -7 PM 3:26
PAGE # 355
BARBARA MORRISON
REGISTER OF DEEDS
K.K.P.

Register of Deeds Stamp & File Number

4. Lot No. _____, Recorded Plat _____

5. Private Claims _____

(SAME AS CORNER G13, T37N-R24W)

I, William Lenca, in a field survey on Apr. 23, 1996 do hereby state that under requirements of P.A. 74, Michigan P.A. of 1970, the corner points mentioned in lines 1 and 2 above were in conformance with regulations and rules therefore as required in the current manual of survey instructions of the United States Department of the Interior, Bureau of Land Management or by a decree of a Court of Law and/or that the corner points mentioned in lines 3, 4 and 5 above were in conformance with the rules of the Michigan Board of Land Surveyors or by a Decree of a Court of Law; established, re-established, monumented, recovered, found as expressed below:

NOTE: Not more than 2 corners, all in the same town and range, may be recorded on this certificate.

1	A	B	C	D	E	F	G	H	I	J	K	L
2		6		5		4		3		2		1
3												
4		7		8		9		10		11		12
5												
6		18		17		16		15		14		13
7												
8		19		20		21		22		23		24
9												
10		30		29		28		27		26		25
11												
12		31		32		33		34		35		36
13												

A. Description of original monument and accessories and/or subsequent restoration:

- 1848: Original Survey (Twp Boundary) by John Mullett - B.T.'s - Hemlock, 8" - N63°W - 25 lks.; Hemlock, 12" - N56°E - 38 lks. All original evidence for this corner position has been destroyed by county road improvements.
- 1848: Original Survey (Section Subdivisions) by James H. Mullett - B.T.'s - Hemlock, 14" - S28°E - 36 lks; Hemlock, 6" - S21°W - 25 lks. All original evidence for this corner has been destroyed by clearing and building activities.
- 1950: Michigan State Highway Department Plat for Highway M-35 shows ties to this corner from the new highway centerline.
- 1960: L.C.R.C. No. 693 (Vol. 3) by
- 1979: Certified Survey No. 153 by George B. Wilson, RLS No. 17607, describes this corner as a "pipe" and shows its position in relation to other corners in Section 4, T36N-R24W.

B. Description of corner evidence found and/or method applied in restoring or reestablishing corner:

We found a 1-1/2" diameter iron pipe in a location which matches closely with the 1950 Highway ties from the centerline of Highway M-35. This position also matches ties to the E1/4 Corner and the E1/16 corner on the North Line of Section 4, as shown in Certified Survey No. 153. This corner has been accepted and used by local surveyors for over 40 years, and is accepted as the best available evidence of the position of the original corner.

C. Description of monument for corner and accessories established to perpetuate locating the position of the corner:
Set 2" dia. Aluminum Pipe/3-1/4" dia. Alum. cap stamped for corner location:

24" dia. Hemlock	N47°E	51.11 feet	
NE Corner of House Foundation	S27°W	61.13 feet	
24" dia. Hemlock	S84°W	113.67 feet	
12" dia. Cedar	N36°W	75.58 feet	Scr. NBT
Metal Survey Sign Post	North	27.5 feet	

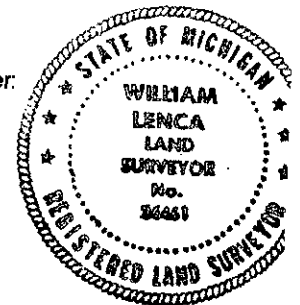

NOTE: All bearings are magnetic bearings. All distances are measured with steel tape. Distances to trees are to nail in side of tree.

Signed by William Lenca
Surveyor's Michigan License No. 26461

Date Apr. 27, 1996