

Approved by Menominee County  
 Land Survey Remuneration  
 Peer Group Under Act 345 Of  
 P.A. of 1990 On 9/25, 19996  
Mc Davis BLS  
 Chairman

LAND CORNER RECORDATION CERTIFICATE  
 Filing Requirement of Act 74, Mich. P.A. 1970

For corners in

MENOMINEE  
 (County)

Located In: Corner Code #

- |                                    |  |              |
|------------------------------------|--|--------------|
| 1. Public Land Survey              | T <u>37</u> N R <u>25</u> W            | <u>B13</u>   |
|                                    | T <u>36</u> R <u>25</u>                | <u>B-1</u> ✓ |
|                                    | T <u>   </u> R <u>   </u>              | <u>   </u>   |
| 2. Property Controlling in Section | S <u>   </u> T <u>   </u> R <u>   </u> | <u>   </u>   |
|                                    | S <u>   </u> T <u>   </u> R <u>   </u> | <u>   </u>   |
| 3. Miscellaneous Property in Sec.  | S <u>   </u> T <u>   </u> R <u>   </u> | <u>   </u>   |
|                                    | S <u>   </u> T <u>   </u> R <u>   </u> | <u>   </u>   |

RECEIVED FOR RECORD  
 96 OCT -7 PM 3:27  
 PAGE # 373  
 BARBARA MORRISON  
 REGISTER OF DEEDS  
 REGISTERED LAND SURVEYOR  
 REGISTERED IN 1988  
 Register of Deeds Stamp & File Number

4. Lot No. \_\_\_\_\_, Recorded Plat \_\_\_\_\_  
 5. Private Claims \_\_\_\_\_

SAME AS CORNER B-1 T36N-R25W ✓

I, William Lenca, in a field survey on Sep. 09, 19 96 do hereby state that under requirements of P.A. 74, Michigan P.A. of 1970, the corner points mentioned in lines 1 and 2 above were in conformance with regulations and rules therefore as required in the current manual of survey instructions of the United States Department of the Interior, Bureau of Land Management or by a decree of a Court of Law and/or that the corner points mentioned in lines 3, 4 and 5 above were in conformance with the rules of the Michigan Board of Land Surveyors or by a Decree of a Court of Law; established, re-established, monumented, recovered, found as expressed below:

NOTE: Not more than 2 corners, all in the same town and range, may be recorded on this certificate.

|    |   |    |   |    |   |    |   |    |   |    |   |    |
|----|---|----|---|----|---|----|---|----|---|----|---|----|
| 1  | A | B  | C | D  | E | F  | G | H  | I | J  | K | L  |
| 2  |   | 6  |   | 5  |   | 4  |   | 3  |   | 2  |   | 1  |
| 3  |   |    |   |    |   |    |   |    |   |    |   |    |
| 4  |   | 7  |   | 8  |   | 9  |   | 10 |   | 11 |   | 12 |
| 5  |   |    |   |    |   |    |   |    |   |    |   |    |
| 6  |   | 18 |   | 17 |   | 16 |   | 15 |   | 14 |   | 13 |
| 7  |   |    |   |    |   |    |   |    |   |    |   |    |
| 8  |   | 19 |   | 20 |   | 21 |   | 22 |   | 23 |   | 24 |
| 9  |   |    |   |    |   |    |   |    |   |    |   |    |
| 10 |   | 30 |   | 29 |   | 28 |   | 27 |   | 26 |   | 25 |
| 11 |   |    |   |    |   |    |   |    |   |    |   |    |
| 12 |   | 31 |   | 32 |   | 33 |   | 34 |   | 35 |   | 36 |
| 13 |   |    |   |    |   |    |   |    |   |    |   |    |

A. Description of original monument and accessories and/or subsequent restoration:

1847: Original Survey by James H. Mullett - B.T.'s - Hemlock, 10" - N67°E - 17 lks.; Hemlock, 10" - N70°W - 05 lks. All original evidence for this corner has been destroyed by logging activities and fire.

B. Description of corner evidence found and/or method applied in restoring or reestablishing corner:

This corner was reestablished on line and proportionately between the Southwest Corner of Section 31 (A-13) and the South Quarter Corner of Section 32 (D-13), and is accepted as a careful and faithful reestablishment of the position of the original corner.

C. Description of monument for corner and accessories established to perpetuate locating the position of the corner:  
 Set 2" dia. Aluminum Pipe/3-1/4" dia. Alum cap stamped for corner location:

|                        |       |            |          |
|------------------------|-------|------------|----------|
| 8" dia. Maple          | N55°E | 27.42 feet | Scr. NBT |
| 8" dia. Maple          | S85°E | 42.64 feet | Scr. NBT |
| 8" dia. Maple          | S62°W | 38.47 feet | Scr. NBT |
| 7" dia. Maple          | N67°W | 5.36 feet  | Scr. NBT |
| Metal Survey Sign Post | S26°W | 1.5 feet   |          |

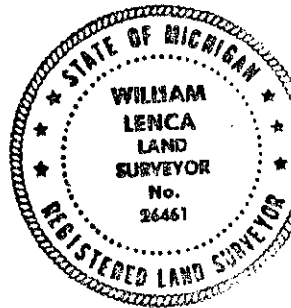

NOTE: All bearings are magnetic bearings. All distances are measured with steel tape. Distances to trees are to nail in side of tree.

Signed by William Lenca  
 Surveyor's Michigan License No. 26461

Date Sep. 24, 1996