

LAND CORNER RECORDATION CERTIFICATE
 Filing Requirement of Act 74, Mich. P.A. 1970

Mc Davis BLS
 Chairman

For corners in

<u>MENOMINEE</u> (County)	Located In:	Corner Code #
1. Public Land Survey	T <u>36</u> N R <u>26</u> W	<u>A-4</u>
	T ___ R ___	___
	T ___ R ___	___
	T ___ R ___	___
2. Property Controlling in Section	S ___ T ___ R ___	___
	S ___ T ___ R ___	___
3. Miscellaneous Property in Sec.	S ___ T ___ R ___	___
	S ___ T ___ R ___	___

RECEIVED FOR RECORD
 95 DEC 27 PM 3:30
 PAGE # 287 BK 1
 BARBARA MONTGOMERY
 REGISTERED LAND SURVEYOR
 MENOMINEE, MICHIGAN

Register of Deeds Stamp & File Number

4. Lot No. _____, Recorded Plat _____
 5. Private Claims _____
 (SAME AS CORNER M-4 T36N R27W)

	A	B	C	D	E	F	G	H	I	J	K	L	M
1													
2	6	5	4	3	2	1							
3													
4	7	8	9	10	11	12							
5													
6	10	17	16	15	14	13							
7													
8	19	20	21	22	23	24							
9													
10	30	29	28	27	26	25							
11													
12	31	32	33	34	35	36							
13													

I, William Lenca, in a field survey on Apr 12, 1995, do hereby state that under requirements of P.A. 74, Michigan P.A. of 1970, the corner points mentioned in lines 1 and 2 above were in conformance with regulations and rules therefore as required in the current manual of survey instructions of the United States Department of the Interior, Bureau of Land Management or by a decree of a Court of Law and /or that the corner points mentioned in lines 3, 4 and 5 above were in conformance with the rules of the Michigan Board of Land Surveyors or by a Decree of a Court of Law; established, re-established, monumented, recovered, found as expressed below:

NOTE: Not more than 2 corners, all in the same town and range, may be recorded on this certificate.

A. Description of original monument and accessories and/or subsequent restoration:

1848: Original Survey by James H. Mullett - B.T.'s - W. Pine, 30" - S40°W - 50 lks; W. Pine, 30" - N58°W - 25 lks. Found both B.T.'s badly decayed. We were unable to distinguish scribe marks, however, the stumps are in proper location and correct position to fit original calls.

B. Description of corner evidence found and/or method applied in restoring or reestablishing corner:

In a retracement of the West Line of Section 7, T36N-R26W (also being the West Line of the Township), we found 2 original White Pine B.T.'s. The B.T.'s are very near to an ancient North - South Fence, and place the corner in a position which would come within 4 feet of splitting the distance between the Northwest and Southwest Section Corners. We set the corner from the 2 White Pine B.T.'s, and accepted the position thus arrived at as a careful and faithful perpetuation of the position of the original corner.

C. Description of monument for corner and accessories established to perpetuate locating the position of the corner:
 Set A1NBF30 Berntsen Monument stamped for corner from Original B.T.'s:

12" dia. Balsam	N12°E	28.40 feet	Scr. NBT
10" dia. Maple	S81°E	42.01 feet	Scr. NBT
8" dia. Maple	S04°W	46.51 feet	Scr. NBT
7" dia. Maple	S81°W	14.90 feet	Scr. NBT
Survey Sign Post	S77°W	1.4 feet	

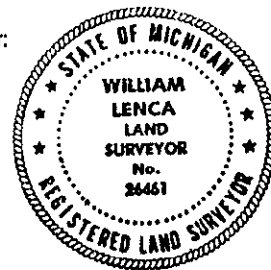

NOTE: All bearings are magnetic bearings. All distances are measured with a steel tape. Distances to trees are to nail in side of tree.

Signed by William Lenca
 Surveyor's Michigan License No. 26461

Date May 24, 1995