

P.A. Of 1990 On 10/11/96 1996

LAND CORNER RECORDATION CERTIFICATE
Filing Requirement of Act 74, Mich. P.A. 1970

William Lenca
Chairman

For corners in

<u>MENOMINEE</u> (County)	Located In:	Corner Code #
1. Public Land Survey	T <u>36N</u> R <u>26W</u>	<u>C01</u>
	T _____ R _____	_____
	T _____ R _____	_____
2. Property Controlling in Section	S _____ T _____ R _____	_____
	S _____ T _____ R _____	_____
3. Miscellaneous Property in Sec.	S _____ T _____ R _____	_____
	S _____ T _____ R _____	_____

RECEIVED FOR RECORD
96 DEC 20 AM 9:31
PAGE # 391, BK 4
BARBARA JOHNSON
REGISTER OF DEEDS
MICHIGAN

Register of Deeds Stamp & File Number

4. Lot No. _____, Recorded Plat _____
5. Private Claims _____

SAME AS CORNER C-13 T37N-R26W

I, William Lenca, in a field survey on Nov. 06, 1996 do hereby state that under requirements of P.A. 74, Michigan P.A. of 1970, the corner points mentioned in lines 1 and 2 above were in conformance with regulations and rules therefore as required in the current manual of survey instructions of the United States Department of the Interior, Bureau of Land Management or by a decree of a Court of Law and /or that the corner points mentioned in lines 3, 4 and 5 above were in conformance with the rules of the Michigan Board of Land Surveyors or by a Decree of a Court of Law; established, re-established, monumented, recovered, found as expressed below:

NOTE: Not more than 2 corners, all in the same town and range, may be recorded on this certificate.

	A	B	C	D	E	F	G	H	I	J	K	L
1												
2	6		5		4		3		2		1	
3												
4	7		8		9		10		11		12	
5												
6	18		17		16		15		14		13	
7												
8	19		20		21		22		23		24	
9												
10	30		29		28		27		26		25	
11												
12	31		32		33		34		35		36	
13												

A. Description of original monument and accessories and/or subsequent restoration:

- 1847: Original Survey (Twp Bdy) by James H. Mullett - B.T.'s - Hemlock, 10" - N52°E - 20 lks; Sugar, 12" - N15°W - 15 lks. All original evidence for this corner has been destroyed by county road improvements.
- 1852: Original Survey (Sec. Subd.) by Francis Coleman - B.T.'s - Cedar, 10" - S75°E - 16 lks; Cedar, 10" - S34°W - 24 lks. All original evidence for this corner has been destroyed by county road improvements.

B. Description of corner evidence found and/or method applied in restoring or reestablishing corner:

We found a P.K. nail set in the centerline of county roads running East - West and North. We found that the position of this nail fit very closely with GLO record distances to corners East, West and South. This position also fit well with long standing lines of occupation, and is accepted as the best available evidence of the position of the original corner.

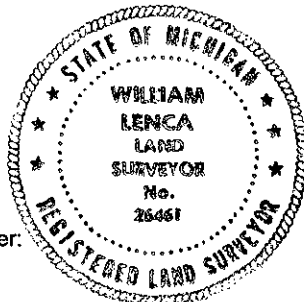

C. Description of monument for corner and accessories established to perpetuate locating the position of the corner:
Set 5/8" x 24" Iron Rod/3-1/4" dia. Alum. cap stamped for corner location in Monument Box:

5/8" x 24" Iron Rod/2" dia. Alum. cap marked "WITNESS MARKER"	N41°E	50.52 feet	0.5' W. of Tel Box
5/8" x 24" Iron Rod/2" dia. Alum. cap marked "WITNESS MARKER"	S35°E	42.23 feet	1.0' W. of Power Pole
5/8" x 24" Iron Rod/2" dia. Alum. cap marked "WITNESS MARKER"	N45°W	49.43 feet	
Metal Survey Sign Post	N45°W	59.9 feet	

NOTE: All bearings are magnetic bearings. All distances are measured with steel tape. Distances to trees are to nail in side of tree.

Signed by William Lenca
Surveyor's Michigan License No. 26461

Date Nov. 30, 1996