

Approved by Menominee County  
 Land Survey Reorganization  
 Four Group Under Act 345 Of  
 P.A. Of 1989 On 10/26 1995  
Mac Davis RLS  
 Chairman

LAND CORNER RECORDATION CERTIFICATE  
 Filing Requirement of Act 74, Mich. P.A. 1970

or corners in

MENOMINEE Located In: Corner Code C-4  
 (County)

Public Land Survey T 36N R 26W  
 T \_\_\_\_\_ R \_\_\_\_\_  
 T \_\_\_\_\_ R \_\_\_\_\_  
 T \_\_\_\_\_ R \_\_\_\_\_

Property Controlling S \_\_\_\_\_ R \_\_\_\_\_  
 in Section S \_\_\_\_\_ T \_\_\_\_\_ R \_\_\_\_\_  
 Miscellaneous S \_\_\_\_\_ T \_\_\_\_\_ R \_\_\_\_\_  
 Property in Sec. S \_\_\_\_\_ T \_\_\_\_\_ R \_\_\_\_\_

REGISTERED FOR RECORD  
 95 NOV -8 AM 11:32  
 PAGE # 351 BK 4  
 BANDATA MENOMINEE  
 REGISTER OF DEEDS  
 REGISTERED DEEDS  
 REGISTERED DEEDS  
 REGISTERED DEEDS

Register of Deeds Stamp & File Number

Lot No. \_\_\_\_\_, Recorded Plat \_\_\_\_\_  
 Private Claims \_\_\_\_\_

William Lenca, in a field survey on Apr. 28, 1995  
 hereby certify that under requirements of P.A. 74, Michigan P.A. of 1970, the corner points mentioned  
 in lines 1 and 2 above were in conformance with regulations and rules therefore as required in the  
 current manual of survey instructions of the United States Department of the Interior, Bureau of Land  
 Management or by a decree of a Court of Law and/or that the corner points mentioned in lines 3, 4 and 5  
 above were in conformance with the rules of the Michigan Board of Land Surveyors or by a Decree of a  
 Court of Law; established, re-established, monumented, re-monumented, recovered, found as  
 expressed below:

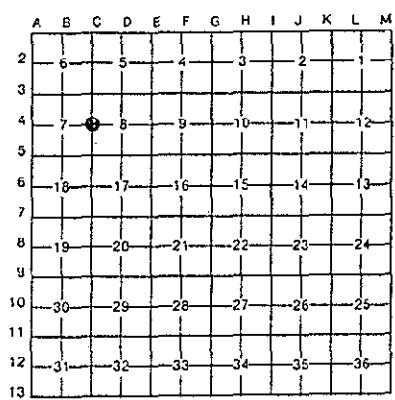

NOTE: Not more than 4 corners, all in the same town and range, may be recorded  
 on this certificate.

Description of original monument and accessories and/or subsequent restoration:

1852: Original Survey by Francis Coleman - B.T.'s - S. Maple, 10" - N28°E - 11 lks; S. Maple, 12" - S22°W - 15 lks. All  
 original evidence has been destroyed by farming activities.

Description of corner evidence found and/or method applied in restoring or reestablishing corner:

The corner position was located on line with an ancient fence line running South from this location and midway between the  
 Northeast and Southeast Section Corners, and is accepted as the best available evidence of the position of the original corner.

Description of monument for corner and accessories established to perpetuate locating the position of the corner:

Set 2" dia. Aluminum Pipe 30" long w/3 1/4" Alum. Cap stamped for corner:

8" dia. Ironwood	N07°W	19.81 feet	Scr. NBT
6" dia. Ironwood	S84°E	22.82 feet	Scr. NBT
9" dia. Maple	S04°E	9.38 feet	Scr. NBT
8" dia. Ironwood	S81°W	3.33 feet	Scr. NBT
Metal Survey Sign Post	S51°E	1.8 feet	

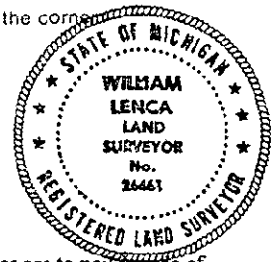

NOTE: All bearings are magnetic bearings. All distances are measured with a steel tape. Distances to trees are to nail in side of  
 tree.

Signed by William Lenca Date May 24, 1995  
 Surveyor's Michigan License No. 26461

SURVEY &  
 RECORDATION  
 DEC 01 1995