

APR 06 1999

Approved by Menominee County
Land Survey Remonumentation
Peer Group Under Act 345 Of

PA. Of 1990 On 12/14 1998
Lawrence J. Wain P.S.
Chairman

SECTION

LAND CORNER RECORDATION CERTIFICATE
Filing Requirement of Act 74, Mich. P.A. 1970

For corners in

MENOMINEE

(County)

Located In:

Corner Code #

- | | | | |
|------------------------------------|-------|-----------------------------|-------|
| 1. Public Land Survey | | T <u>36</u> N R <u>26</u> W | C-11 |
| | | T ___ R ___ | _____ |
| | | T ___ R ___ | _____ |
| | | T ___ R ___ | _____ |
| 2. Property Controlling in Section | S ___ | T ___ R ___ | _____ |
| | S ___ | T ___ R ___ | _____ |
| 3. Miscellaneous Property in Sec. | S ___ | T ___ R ___ | _____ |
| | S ___ | T ___ R ___ | _____ |

RECEIVED FOR RECORD
99 DEC 14 PM 3:22
PAGE # 681 BK 5
BUREAU OF LAND SURVEY
REGISTER OF DEEDS
MENOMINEE COUNTY

Register of Deeds Stamp & File Number

4. Lot No. _____, Recorded Plat _____
5. Private Claims _____

I, William Lenca, in a field survey on Sept. 01, 1998 do hereby state that under requirements of P.A. 74, Michigan P.A. of 1970, the corner points mentioned in lines 1 and 2 above were in conformance with regulations and rules therefore as required in the current manual of survey instructions of the United States Department of the Interior, Bureau of Land Management or by a decree of a Court of Law and /or that the corner points mentioned in lines 3, 4 and 5 above were in conformance with the rules of the Michigan Board of Land Surveyors or by a Decree of a Court of Law; established, re-established, monumented, recovered, found as expressed below:

NOTE: Not more than 2 corners, all in the same town and range, may be recorded on this certificate.

	A	B	C	D	E	F	G	H	I	J	K	L	M
1													
2	6		5		4		3		2		1		
3													
4	7		8		9		10		11		12		
5													
6	18		17		16		15		14		13		
7													
8	19		20		21		22		23		24		
9													
10	30		29		28		27		26		25		
11													
12	31		32		33		34		35		36		
13													

A. Description of original monument and accessories and/or subsequent restoration:

1852: Original Survey by Francis Coleman - B.T.'s - Cedar, 10" - N20°W - 17 lks.; Cedar, 12" - S81°E - 12 lks. All original evidence for this corner has been destroyed by county road improvements.

B. Description of corner evidence found and/or method applied in restoring or reestablishing corner:

We set this corner in the centerline of an East - West county road and in line with old fences North and South. This corner location falls on the edge of a swamp per GLO call, fits well with corners East, West and North, and is accepted as the best available evidence of the position of the original corner.

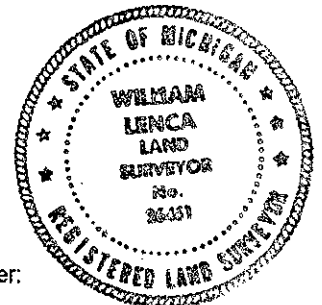

C. Description of monument for corner and accessories established to perpetuate locating the position of the corner:

Set 5/8" x 24" Iron Rod/3-1/4" dia. Alum. cap stamped for corner location:

- | | | | |
|---|-------|------------|--------------------|
| 12" dia. Tamarack | N57°E | 53.37 feet | Scr. NBT |
| 5" dia. Cedar | S45°E | 61.10 feet | Scr. NBT |
| 5/8" x 24" Iron Rod/2" dia. Alum. cap marked "WITNESS MARKER" | S34°W | 26.09 feet | 1' W. of 22" Cedar |
| 24" dia. Maple | N38°W | 35.17 feet | Scr. NBT |
| Metal Survey Sign Post | North | 28.4 feet | |

NOTE: All bearings are magnetic bearings. All distances are measured with steel tape. Distances to trees are to nail in side of tree.

Signed by William Lenca
Surveyor's Michigan License No. 26461

Date Dec. 11, 1998