

Approved by Menominee County
Land Survey Remonumentation
Peer Group Under Act 345 Of

1990 On 12/12, 1996
Mr. Davis
Chairman

LAND CORNER RECORDATION CERTIFICATE
Filing Requirement of Act 74, Mich. P.A. 1970

For corners in

| MENOMINEE (County) | Located In: | Corner Code # |
|---------------------------------------|---------------------------|---------------|
| 1. Public Land Survey | T <u>36N</u> R <u>26W</u> | <u>D01</u> |
| | T ___ R ___ | _____ |
| | T ___ R ___ | _____ |
| | T ___ R ___ | _____ |
| 2. Property Controlling in Section | S ___ T ___ R ___ | _____ |
| | S ___ T ___ R ___ | _____ |
| 3. Miscellaneous Property in Sec. | S ___ T ___ R ___ | _____ |
| | S ___ T ___ R ___ | _____ |

RECEIVED FOR RECORD
95 DEC 20 AM 9:31
PAGE 393 BK 4
BARBARA MORRISON
REGISTERED PROFESSIONAL SURVEYOR
NO. 16461

Register of Deeds Stamp & File Number

4. Lot No. _____, Recorded Plat _____
5. Private Claims _____

SAME AS CORNER D-13 T37N-R26W

I, William Lenca, in a field survey on Oct. 29, 1996 do hereby state that under requirements of P.A. 74, Michigan P.A. of 1970, the corner points mentioned in lines 1 and 2 above were in conformance with regulations and rules therefore as required in the current manual of survey instructions of the United States Department of the Interior, Bureau of Land Management or by a decree of a Court of Law and /or that the corner points mentioned in lines 3, 4 and 5 above were in conformance with the rules of the Michigan Board of Land Surveyors or by a Decree of a Court of Law; established, re-established, monumented, recovered, found as expressed below:

NOTE: Not more than 2 corners, all in the same town and range, may be recorded on this certificate.

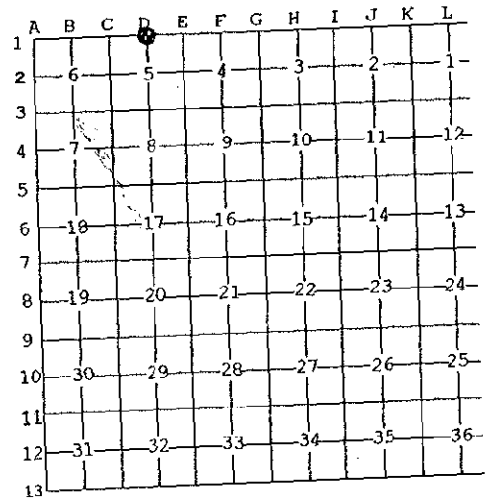

A. Description of original monument and accessories and/or subsequent restoration:

1847: Original Survey (Twp Bdy) by James H. Mullett - B.T.'s - Hemlock, 12" - N60°W - 40 lks; Hemlock, 16" - N30°E - 26 lks. All original evidence for this corner has been destroyed by county road improvements.

B. Description of corner evidence found and/or method applied in restoring or reestablishing corner:

We set this corner in the centerline of an East - West County Road and midway between the Northwest Corner (C-1) and the Northeast Corner (E-1) of Section 5. This position fits well with a GLO Terrain call (swamp edge 0.5 chains East) and with long standing lines of occupation, and is accepted as a careful and faithful reestablishment of the position of the original corner. The corner position thus established falls 92 feet West of the centerline of a county road running South.

C. Description of monument for corner and accessories established to perpetuate locating the position of the corner:
Set 5/8" x 24" Iron Rod/3-1/4" dia. Alum. cap stamped for corner location in Monument Box:

| | | | |
|---|-------|------------|----------------------|
| 10" dia. Cedar | N48°E | 59.75 feet | Scr. NBT |
| 5/8" x 24" Iron Rod/2" dia. Alum. cap marked "WITNESS MARKER" | S57°E | 64.24 feet | 0.5' N of Power Pole |
| 10" dia. Tamarack | S43°W | 81.16 feet | Scr. NBT |
| 5/8" x 24" Iron Rod/2" dia. Alum. cap marked "WITNESS MARKER" | North | 33.36 feet | |
| Metal Survey Sign Post | North | 33.8 feet | |

NOTE: All bearings are magnetic bearings. All distances are measured with steel tape. Distances to trees are to nail in side of tree.

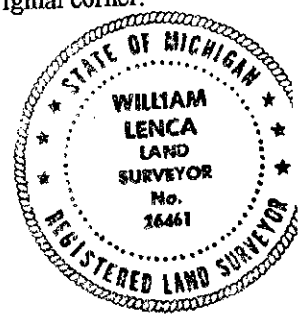

Signed by William Lenca
Surveyor's Michigan License No. 26461

Date Nov. 30, 1996