

REMONUMENTATION

JAN 09 2001

SECTION

LAND CORNER RECORDATION CERTIFICATE
Filing Requirement of Act 74, Mich. P.A. 1970

Approved by Menominee County
Land Survey Remonumentation
Peer Group Under Act 345 of
P.A. of 1990 On 7/13, 2000
Me. Davis RLS
Chairman

Book 6 Page 143

For corners in MENOMINEE (County)	Located In:	Corner Code #
1. Public Land Survey	T <u>35N</u> R <u>26W</u>	<u>D-01</u>
	T <u> </u> R <u> </u>	<u> </u>
	T <u> </u> R <u> </u>	<u> </u>
	T <u> </u> R <u> </u>	<u> </u>
2. Property Controlling in Section	S <u> </u> T <u> </u> R <u> </u>	<u> </u>
	S <u> </u> T <u> </u> R <u> </u>	<u> </u>
3. Miscellaneous Property in Sec.	S <u> </u> T <u> </u> R <u> </u>	<u> </u>
	S <u> </u> T <u> </u> R <u> </u>	<u> </u>

RECEIVED FOR RECORD
13 DEC 2000 10:16:09 F
BARBARA MORRISON
REGISTER OF DEEDS
MENOMINEE, MI 49858

Register of Deeds Stamp & File Number

4. Lot No. _____, Recorded Plat _____

5. Private Claims _____

SAME AS CORNER D-13 T36N-R26W

I, William Lenca, in a field survey on May 25, 19 do hereby state that under requirements of P.A. 74, Michigan P.A. of 1970, the corner points mentioned in lines 1 and 2 above were in conformance with regulations and rules therefore as required in the current manual of survey instructions of the United States Department of the Interior, Bureau of Land Management or by a decree of a Court of Law and for that the corner points mentioned in lines 3, 4 and 5 above were in conformance with the rules of the Michigan Board of Land Surveyors or by a Decree of a Court of Law; established, re-established, monumented, recovered, found as expressed below:

	A	B	C	D	E	F	G	H	I	J	K	L	M
1				●									
2	6		5		4		3		2		1		
3													
4	7		8		9		10		11		12		
5													
6	18		17		16		15		14		13		
7													
8	19		20		21		22		23		24		
9													
10	30		29		28		27		26		25		
11													
12	31		32		33		34		35		36		
13													

NOTE: Not more than 2 corners, all in the same town and range, may be recorded on this certificate.

A. Description of original monument and accessories and/or subsequent restoration:

- 1848: Original Survey by James H. Mullett - B.T.'s - Cedar, 12" - N65°E - 19 lks.; Cedar, 12" - N79°W - 20 lks. All original evidence for this corner has been destroyed by county road improvements.
- 1987: L.C.R.C. No. 769 by William Lenca, RLS No. 26461 - Set Railroad Spike in centerline of Co. Rds E-W-N and in line with old fence South. B.T.'s: Power Pole - N40°W - 48.14'; W. Birch, 5" - South - 38.73'; W. Birch, 6" - S54°W - 63.25'.

B. Description of corner evidence found and/or method applied in restoring or reestablishing corner:

We found a Railroad Spike and 3 Witnesses as described in L.C.R.C. No. 769 (see part A). This position fits well with existing lines of occupation, has been accepted and used as control for surveys in the area, and is accepted as the best available evidence of the position of the original corner.

C. Description of monument for corner and accessories established to perpetuate locating the position of the corner:

Set 5/8" x 24" Iron Rod/3-1/4" dia. Alum. cap stamped for corner location in Monument Box:

8" dia. Elm	N34°E	75.06 feet	Scr. NBT
8" dia. Cedar	S27°E	37.85 feet	Scr. NBT
9" dia. Cedar	S52°W	62.85 feet	Scr. NBT
5/8" x 24" Iron Rod/plastic Ident. cap	N41°W	47.38 feet	1.0' E. of Power Pole
Metal Survey Sign Post	South	31.65 feet	

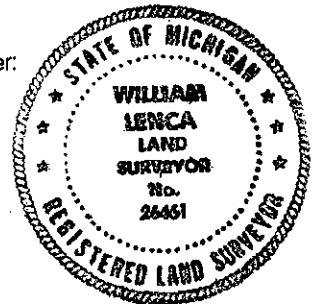

NOTE: All bearings are magnetic bearings. All distances are measured with steel tape. Distances to trees are to nail in side of tree.

Signed by William Lenca
Surveyor's Michigan License No. 26461

Date Aug. 8, 2000