

SURVEY & REMONUMENTATION

JAN 09 2001

SECTION

LAND CORNER RECORDATION CERTIFICATE
Filing Requirement of Act 74, Mich. P.A. 1970

Approved by Menominee County
Land Survey Remonumentation
Peer Group Under Act 345 of
P.A. Of 1990 On 7/13, 2000
W. D. Davis, RLS
Chairman

Book 6 Page 176

For corners in

MENOMINEE

(County)

Located In:

Corner Code #

| | | | | |
|------------------------------------|---|------|-----|-----|
| 1. Public Land Survey | T | 35NR | 26W | J-1 |
| | T | R | | |
| | T | R | | |
| | T | R | | |
| 2. Property Controlling in Section | S | T | R | |
| | S | T | R | |
| 3. Miscellaneous Property in Sec. | S | T | R | |
| | S | T | R | |

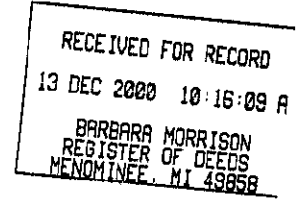

Register of Deeds Stamp & File Number

4. Lot No. _____, Recorded Plat _____

5. Private Claims _____

SAME AS CORNER J-13, T36N-R26W ✓

I, William Lenca, in a field survey on Jul., 1900 do hereby state that under requirements of P.A. 74, Michigan P.A. of 1970, the corner points mentioned in lines 1 and 2 above were in conformance with regulations and rules therefore as required in the current manual of survey instructions of the United States Department of the Interior, Bureau of Land Management or by a decree of a Court of Law and /or that the corner points mentioned in lines 3, 4 and 5 above were in conformance with the rules of the Michigan Board of Land Surveyors or by a Decree of a Court of Law; established, re-established, monumented, recovered, found as expressed below:

NOTE: Not more than 2 corners, all in the same town and range, may be recorded on this certificate.

| A | B | C | D | E | F | G | H | I | J | K | L | M |
|----|----|---|----|---|----|---|----|---|----|---|----|---|
| 1 | | | | | | | | | | | | |
| 2 | 6 | | 5 | | 4 | | 3 | | 2 | | 1 | |
| 3 | | | | | | | | | | | | |
| 4 | 7 | | 8 | | 9 | | 10 | | 11 | | 12 | |
| 5 | | | | | | | | | | | | |
| 6 | 18 | | 17 | | 16 | | 15 | | 14 | | 13 | |
| 7 | | | | | | | | | | | | |
| 8 | 19 | | 20 | | 21 | | 22 | | 23 | | 24 | |
| 9 | | | | | | | | | | | | |
| 10 | 30 | | 29 | | 28 | | 27 | | 26 | | 25 | |
| 11 | | | | | | | | | | | | |
| 12 | 31 | | 32 | | 33 | | 34 | | 35 | | 36 | |
| 13 | | | | | | | | | | | | |

A. Description of original monument and accessories and/or subsequent restoration:

- 1848: Original Survey by James H. Mullett - B.T.'s - Cedar, 3" - N57°E - 17 lks.; Cedar, 5" - S21°W - 7 lks.; All original evidence for this corner has been destroyed by County Road improvements.
- 1986: L.C.R.C. No. 740, Book 3, by William Lenca, RLS No, 26461 states "Set 30" long Aluminum Monument with 4" cap marked MENOMINEE COUNTY SURVEY MARKER in centerline of County Road East-West and in location indicated by existing lines of occupation to the East." TIES: c/1 White Birch 7", Scr. B.T., S4°E, 45.84'; c/1 White Birch 9", Scr. B.T., S48°W, 50.24'; c/1 Cedar 4", Scr. B.T., N5°W, 40.55'.

B. Description of corner evidence found and/or method applied in restoring or reestablishing corner:

Found Railroad Spike and 3 B.T.'s in place as described in L.C.R.C. No. 740 (see part A). This corner falls in the centerline of an East - West County Road and fits an old fence line 1/4 mile East, has been used as control for surveys in the area, and is accepted as the best available evidence of the position of the original corner.

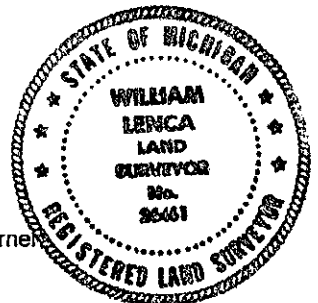

C. Description of monument for corner and accessories established to perpetuate locating the position of the corner:

Set 5/8" x 24" Iron Rod/3-1/4" dia. Alum. cap stamped for corner location in Monument Box:

| | | | |
|------------------------|-------|------------|----------|
| 5" dia. Tamarack | N34°E | 55.31 feet | Scr. NBT |
| 7" dia. Cedar | S48°E | 68.9 feet | Scr. NBT |
| 9" dia. Tamarack | S38°W | 68.14 feet | Scr. NBT |
| 7" dia. Elm | N46°W | 49.88 feet | Scr. NBT |
| Metal Survey Sign Post | S04°E | 29.4 feet | |

NOTE: All bearings are magnetic bearings. All distances are measured with steel tape. Distances to trees are to nail in side of tree.

Signed by William Lenca
Surveyor's Michigan License No. 26461

Date Aug. 8, 2000

176