

# SURVEY & REMONUMENTATION

JAN 09 2001

SECTION

## LAND CORNER RECORDATION CERTIFICATE

Filing Requirement of Act 74, Mich. P.A. 1970

Approved by Menominee County  
Land Survey Remonumentation  
Peer Group Under Act 345 of  
P.A. Of 1990 On 7/13, 2000  
W. David RLS  
Chairman

For corners in  
MENOMINEE  
(County)

Located In: Corner Code #

1. Public Land Survey	T <u>35N</u> R <u>26W</u>	<u>K-1</u>
	T ___ R ___	___
	T ___ R ___	___
	T ___ R ___	___
2. Property Controlling in Section	S ___ T ___ R ___	___
	S ___ T ___ R ___	___
3. Miscellaneous Property in Sec.	S ___ T ___ R ___	___
	S ___ T ___ R ___	___

Book 6 Page 179

RECEIVED FOR RECORD  
13 DEC 2000 10:16:09 A  
BARBARA MORRISON  
REGISTER OF DEEDS  
MENOMINEE, MI 49858

Register of Deeds Stamp & File Number

4. Lot No. \_\_\_\_\_, Recorded Plat \_\_\_\_\_  
5. Private Claims \_\_\_\_\_

SAME AS CORNER K-13, T36N-R26W

A	B	C	D	E	F	G	H	I	J	K	L	M
1												
2	6	5	4	3	2							
3												
4	7	8	9	10	11	12						
5												
6	18	17	16	15	14	13						
7												
8	19	20	21	22	23	24						
9												
10	30	29	28	27	26	25						
11												
12	31	32	33	34	35	36						
13												

I, William Lenca, in a field survey on Jul., 1900 do hereby state that under requirements of P.A. 74, Michigan P.A. of 1970, the corner points mentioned in lines 1 and 2 above were in conformance with regulations and rules therefore as required in the current manual of survey instructions of the United States Department of the Interior, Bureau of Land Management or by a decree of a Court of Law and for that the corner points mentioned in lines 3, 4 and 5 above were in conformance with the rules of the Michigan Board of Land Surveyors or by a Decree of a Court of Law; established, re-established, monumented, recovered, found as expressed below:

NOTE: Not more than 2 corners, all in the same town and range, may be recorded on this certificate.

A. Description of original monument and accessories and/or subsequent restoration:

- 1848: Original Survey by James H. Mullett - B.T.'s - Cedar, 12" - N69°E - 17 lks.; Spruce, 8" - N38-1/2°W - 17 lks.; Cedar, 10" - S39°E - 7 lks.; Cedar, 10" - S31°W - 20 lks. All original evidence for this corner has been destroyed by County Road improvements.
- 1986: L.C.R.C. No. 740, Book 3, by William Lenca, RLS No. 26461 states "Set 30" long aluminum monument with 4" cap marked MENOMINEE COUNTY SURVEY MARKER in line with centerlines of county roads North-South and East-West." TIES: c/1 Power Pole, N45°E, 42.71'; c/1 Power Pole, N36°W, 41.25'; 5/8" x 24" Iron pin/ident. cap, S45°W, 46.86'; c/1 Power Pole stump, S56°E, 50.23'.

B. Description of corner evidence found and/or method applied in restoring or reestablishing corner:

We found a W-1-B Berntsen Monument with the top sheared off by county snow plow. We verified its position with the ties as described in LCRC No. 740 - Book 3 (see part A), and found it to be in the proper location. The corner falls in the centerline of county roads running North - South - East and West, has been accepted and used by local surveyors, and is accepted as the best available evidence for the position of the original corner.

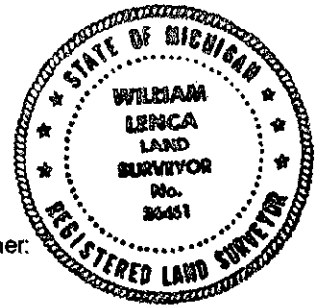

C. Description of monument for corner and accessories established to perpetuate locating the position of the corner:

Set 5/8" x 24" Iron Rod/3-1/4" dia. Alum. cap stamped for corner location in Monument Box:

6" dia. Elm	N45°E	79.35 feet	Scr. NBT
12" dia. Cedar	S37°E	82.86 feet	Scr. NBT
6" dia. Cedar	S43°W	96.48 feet	Scr. NBT
5/8" x 24" Iron Rod/2" dia. Alum. cap marked "WITNESS MARKER"	N41°W	35.74 feet	@ Survey Sign Post
Metal Survey Sign Post	N41°W	36.4 feet	

NOTE: All bearings are magnetic bearings. All distances are measured with steel tape. Distances to trees are to nail in side of tree.

Signed by William Lenca  
Surveyor's Michigan License No. 26461

Date Aug. 8, 2000