

APR 06 1999

Approved \_\_\_\_\_  
 Land Survey Remonumentation  
 Peer Group Under Act 345 Of  
 P.A. Of 1980 On 07/26, 1998  
W.L. Davis RLS  
 Chairman

**SECTION**

**LAND CORNER RECORDATION CERTIFICATE**  
 Filing Requirement of Act 74, Mich. P.A. 1970

For corners in

<u>MENOMINEE</u> (County)	Located In:	Corner Code #
1. Public Land Survey	T <u>36</u> NR <u>27</u> W	<u>A-03</u>
	T _____ R _____	_____
	T _____ R _____	_____
	T _____ R _____	_____
2. Property Controlling in Section	S _____ T _____ R _____	_____
	S _____ T _____ R _____	_____
3. Miscellaneous Property in Sec.	S _____ T _____ R _____	_____
	S _____ T _____ R _____	_____

RECEIVED FOR RECORD  
 98 DEC -4 PM 3:48  
 PAGE # 647  
 BARBARA MORRISON  
 REGISTER OF DEEDS  
 MENOMINEE, MI 49858

Register of Deeds Stamp & File Number

4. Lot No. \_\_\_\_\_, Recorded Plat \_\_\_\_\_  
 5. Private Claims \_\_\_\_\_

(SAME AS CORNER M-03 T36N - R28W)

I, William Lenca, in a field survey on June 01, 19 98 do hereby state that under requirements of P.A. 74, Michigan P.A. of 1970, the corner points mentioned in lines 1 and 2 above were in conformance with regulations and rules therefore as required in the current manual of survey instructions of the United States Department of the Interior, Bureau of Land Management or by a decree of a Court of Law and /or that the corner points mentioned in lines 3, 4 and 5 above were in conformance with the rules of the Michigan Board of Land Surveyors or by a Decree of a Court of Law; established, re-established, monumented, recovered, found as expressed below:

NOTE: Not more than 2 corners, all in the same town and range, may be recorded on this certificate.

A	B	C	D	E	F	G	H	I	J	K	L	M
1												
2	6		5		4		3		2		1	
3												
4	7		8		9		10		11		12	
5												
6	18		17		16		15		14		13	
7												
8	19		20		21		22		23		24	
9												
10	30		29		28		27		26		25	
11												
12	31		32		33		34		35		36	
13												

A. Description of original monument and accessories and/or subsequent restoration:

- 1848: Original Survey - Township Boundary - by H. Brevoort, Jr. - B.T.'s - Beech, 14" - S82°W - 27 lks.; Beech, 13" - N61°W - 42 lks. All original evidence for this corner has been destroyed by logging activities.
- 1852: Sectional Subdivision by Francis Coleman - B.T.'s - Sugar, 12" - N58°E - 57 lks.; Sugar, 10" - S35°E - 40 lks. All original evidence for this corner has been destroyed by logging activities.
- 1983: Certified Survey Number 334 by George B. Wilson, RLS No. 17607, shows this corner as it relates to other corners in the SE1/4 of Section 1, T36N-R28W. No B.T.'s are given and no monument is described.

B. Description of corner evidence found and/or method applied in restoring or reestablishing corner:

We found a 3/4" diameter Aluminum rod with a 3-1/4" Aluminum cap at an ancient fence corner with fences running North, East, and West. This position has been used for many years, fits existing lines of occupation, and is accepted as the best available evidence of the position of the original corner.

C. Description of monument for corner and accessories established to perpetuate locating the position of the corner:

Accepted existing 3/4" Aluminum Rod/3-1/4" dia. Aluminum cap - Stamped cap for corner location:

5" dia. Maple	N24°E	17.63 feet	Scr. NBT
9" dia. Maple	S72°E	9.88 feet	Scr. NBT
9" dia. Maple	S32°W	15.64 feet	Scr. NBT
5" dia. Maple	N53°W	36.14 feet	Scr. NBT
Metal Survey Sign Post	North	1.0 feet	

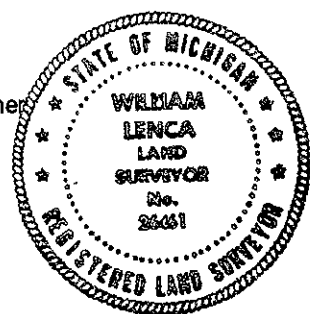

NOTE: All bearings are magnetic bearings. All distances are measured with steel tape. Distances to trees are to nail in side of tree.

Signed by William Lenca Date June 11, 1998  
 Surveyor's Michigan License No. 26461

647