

**SURVEY & REMONUMENTATION**

APR 06 1999

**LAND CORNER RECORDATION CERTIFICATE**  
Filing Requirement of Act 74, Mich. P.A. 1970

Approved by Menominee County  
Land Survey Remonumentation  
Peer Group Under Act 345 Of  
P.A. Of 1990 On 12/19 199 94  
MEZ DAVIS RLS  
16926 Chairman

**SECTION**

For corners in

MENOMINEE  
(County)

Located In:

Corner Code #

- |                                    |                           |             |
|------------------------------------|---------------------------|-------------|
| 1. Public Land Survey              | T <u>36N</u> R <u>28W</u> | <u>M-10</u> |
|                                    | T _____ R _____           | _____       |
|                                    | T _____ R _____           | _____       |
|                                    | T _____ R _____           | _____       |
| 2. Property Controlling in Section | S _____ T _____ R _____   | _____       |
|                                    | S _____ T _____ R _____   | _____       |
| 3. Miscellaneous Property in Sec.  | S _____ T _____ R _____   | _____       |
|                                    | S _____ T _____ R _____   | _____       |

REGISTERED FOR RECORD  
94 DEC 12 AM 8:58  
PAGE # 99 BX 1  
BARBARA KOCORPIS  
REGISTERED  
MICHIGAN  
Register of Deeds Stamp & File Number

4. Lot No. \_\_\_\_\_, Recorded Plat \_\_\_\_\_  
5. Private Claims \_\_\_\_\_

A-10 T36N-R27W

William Lenca June 14 1994

I, \_\_\_\_\_, in a field survey on \_\_\_\_\_, 19\_\_\_\_, do hereby certify that under requirements of P.A. 74, Michigan P.A. of 1970, the corner points mentioned in lines 1 and 2 above were in conformance with regulations and rules therefore as required in the current manual of survey instructions of the United States Department of the Interior, Bureau of Land Management or by a decree of a Court of Law and/or that the corner points mentioned in lines 3, 4 and 5 above were in conformance with the rules of the Michigan Board of Land Surveyors or by a Decree of a Court of Law; established, re-established, monumented, re-monumented, recovered, found as expressed below:

**NOTE: Not more than 4 corners, all in the same town and range, may be recorded on this certificate.**

	A	B	C	D	E	F	G	H	I	J	K	L	M
2	6		5		4		3		2		1		
3													
4	7		8		9		10		11		12		
5													
6	18		17		16		15		14		13		
7													
8	19		20		21		22		23		24		
9													
10	30		29		28		27		26		25		
11													
12	31		32		33		34		35		36		
13													

A. Description of original monument and accessories and/or subsequent restoration:

- 1848: Original Survey by H. Brevoort - B.T.'s - Hemlock, 4", S79°W, 11 lks & Hemlock, 6", N44.5°W, 27 lks. All original evidence for this corner has been destroyed by farming activities & road improvements.
- 1979: L.C.R.C. No. 215 recorded by David Babbitt, RLS No. 21558, states that a 1" dia. Iron Pipe/4" aluminum cap was set at an old gate post on the north side of a driveway and in line with an old fence N-S, based on the testimony of a Mr. Louis Berglin who recalls the corner being established in this position in a 1911 survey." B.T.'s - W. Pine - N19°W - 78.55'; Nail & Brass Cap in face of Power Pole - N36°W - 97.35'; Nail & Brass cap in face of P. Pole - S42°W - 117.7'; Centerline N-S Road - West - 101'.

3. Description of corner evidence found and/or method applied in restoring or reestablishing corner:

Found a 1" dia. Iron Pipe/4" dia. Alum. cap (Standard DNR Monument) and B.T.'s as described in L.C.R.C. No. 215 (see part "A"). This location has been accepted as the corner position for 80 years, and is accepted as the best available evidence of the position of the original corner.

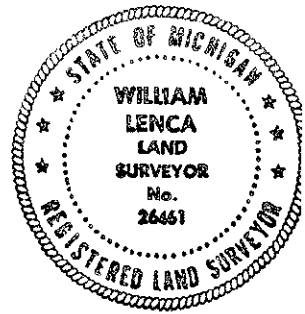

2. Description of monument for corner and accessories established to perpetuate locating the position of the corner:

Found 1" dia. Iron Pipe/4" dia. Alum. cap stamped for corner location (Standard DNR Monument):

10" dia. Norway Pine	N55°W	165.72 feet	Scr. NBT
5/8" x 24" Iron Rod/2" dia. Alum cap (WITNESS MARKER)	N51°E	5.75 feet	
5/8" x 24" Iron Rod/2" dia. Alum cap (WITNESS MARKER)	S17°W	31.57 feet	
14" dia. Norway Pine	S59°W	196.14 feet	Scr. NBT
Survey Sign Post	North	1.3 feet	

NOTE: All bearings are magnetic bearings. All distances are measured with steel tape. Distances to trees are to nail in side of tree.

Signed by W. Lenca Date Sep. 14, 1994  
Surveyor's Michigan License No. 26461