

SURVEY & REMONUMENTATION

FEB 11 1998

Approved by Menominee County
Land Survey Remonumentation
Peer Group Under Act 345 Of

P.A. Of 1990 On 10/31, 199 7

LAND CORNER RECORDATION CERTIFICATE Filing Requirement of Act 74, Mich. P.A. 1970

SECTION

For corners in

MENOMINEE
(County)

Located in:

Corner Code #

1. Public Land Survey

T 36 R 27 W

A-12

T 36 R 28

M-12

T R

T R

2. Property Controlling
in Section

S T R

S T R

3. Miscellaneous
Property in Sec.

S T R

S T R

4. Lot No. _____, Recorded Plat _____

5. Private Claims _____

SAME AS CORNER M-12 T36N-R28W

I, William Lenca, in a field survey on Sept 24, 1997 do hereby state that under requirements of P.A. 74, Michigan P.A. of 1970, the corner points mentioned in lines 1 and 2 above were in conformance with regulations and rules therefore as required in the current manual of survey instructions of the United States Department of the Interior, Bureau of Land Management or by a decree of a Court of Law and /or that the corner points mentioned in lines 3, 4 and 5 above were in conformance with the rules of the Michigan Board of Land Surveyors or by a Decree of a Court of Law; established, re-established, monumented, recovered, found as expressed below:

NOTE: Not more than 2 corners, all in the same town and range, may be recorded on this certificate.

REGISTERED FOR RECORD
 97 NOV 21 PM 3:17
 T36N R27W
 T36N R28W
 M-12
 A-12

Register of Deeds Stamp & File Number

1	A	B	C	D	E	F	G	H	I	J	K	L	M
2	6		5		4		3		2		1		
3													
4	7		8		9		10		11		12		
5													
6	18		17		16		15		14		13		
7													
8	19		20		21		22		23		24		
9													
10	30		29		28		27		26		25		
11													
12	31		32		33		34		35		36		
13													

A. Description of original monument and accessories and/or subsequent restoration:

1848: Original Survey by H. Brevort - B.T.'s - Tamarack, 3" - S39°W - 05 lks.; Cedar, 6" - N27°W - 06 lks. All original evidence for this corner has been destroyed by county road improvements.

B. Description of corner evidence found and/or method applied in restoring or reestablishing corner:

After a careful search of the corner area, we found no evidence of the original corner accessories, or evidence of subsequent restoration. We set the corner in the centerline of an east - west county road and in line with an ancient fence north and an old cut line to the south. This position fits well with other corners and occupation lines in Section 31, and is accepted as a careful and faithful reestablishment of the position of the original corner.

C. Description of monument for corner and accessories established to perpetuate locating the position of the corner:
Set 2" dia. Aluminum Pipe/3-1/4" dia. Alum cap stamped for corner location:

8" dia. Tamarack	N48°E	80.55 feet	Scr. NBT
9" dia. Tamarack	S24°E	33.87 feet	Scr. NBT
9" dia. Tamarack	S65°W	39.26 feet	Scr. NBT
7" dia. Cedar	N41°W	69.76 feet	Scr. NBT
Metal Survey Sign Post	North	33.0 feet	

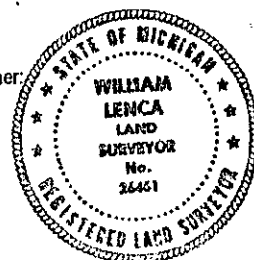

NOTE: All bearings are magnetic bearings. All distances are measured with steel tape. Distances to trees are to nail in side of tree.

Signed by William Lenca
Surveyor's Michigan License No. 26461

Oct. 13, 1997

Date _____

518.