

Approved by Menominee County
 Land Survey Remonumentation
 Peer Group Under Act 345 Of
 P.A. of 1990 On 12/13 1998
Mr. Hawk RLS
 Chairman

LAND CORNER RECORDATION CERTIFICATE
 Filing Requirement of Act 74, Mich. P.A. 1970

For corners in

MENOMINEE
 (County)

Located in: Corner Code #

- | | | |
|------------------------------------|---|-------------------------------|
| 1. Public Land Survey | <u>37N</u>
37N R <u>27W</u> | <u>B-13</u>
B-1 |
| | T R | |
| | T R 27 | |
| | T R | |
| 2. Property Controlling in Section | S T R | |
| | S T R | |
| 3. Miscellaneous Property in Sec. | S T R | |
| | S T R | |

RECEIVED FOR RECORD
 99 JAN - 6 AM 8:55
 PAGE # 727
 BARBARA MORRISON
 REGISTER OF DEEDS
 MENOMINEE MI 498258

Register of Deeds Stamp & File Number

4. Lot No. _____, Recorded Plat _____
 5. Private Claims _____

I, William Lenca, in a field survey on Dec. 17, 1998 do hereby state that under requirements of P.A. 74, Michigan P.A. of 1970, the corner points mentioned in lines 1 and 2 above were in conformance with regulations and rules therefore as required in the current manual of survey instructions of the United States Department of the Interior, Bureau of Land Management or by a decree of a Court of Law and /or that the corner points mentioned in lines 3, 4 and 5 above were in conformance with the rules of the Michigan Board of Land Surveyors or by a Decree of a Court of Law; established, re-established, monumented, recovered, found as expressed below:

NOTE: Not more than 2 corners, all in the same town and range, may be recorded on this certificate.

A	B	C	D	E	F	G	H	I	J	K	L	M
1												
2	6	5	4	3	2	1						
3												
4	7	8	9	10	11	12						
5												
6	18	17	16	15	14	13						
7												
8	19	20	21	22	23	24						
9												
10	30	29	28	27	26	25						
11	31	32	33	34	35	36						
12												
13												

A. Description of original monument and accessories and/or subsequent restoration:

- 1852: Original Survey by Henry Brevoort - B.T.'s - Hemlock, 14" - N60°E - 28 lks.; Lynn, 14" - N44°W - 29 lks. All original evidence for this corner has been destroyed by county road improvements.
 1982: L.C.R.C. No. 277 (Book 1) by David B. Babbitt RLS No. 21558 states, "Set in line with very old fence west and in the c/l of a N-S county road." Set 1" pipe, 4" aluminum cap. TIES: 4" H. Maple - N86°E - 41.55'; 6" H. Maple - S41°E - 68.60'; 8" Twin Maple - S49°W - 50.80'; 8" Twin H. Maple - S84°W - 40.70'.

B. Description of corner evidence found and/or method applied in restoring or reestablishing corner:

We found a 1 inch diameter iron pipe with a 4 inch diameter aluminum cap (D.N.R. Monument) along with 4 B.T.'s (as noted in part "C") in a location as indicated in Land Corner Recordation Certificate Number 277. The corner falls in the centerline of a North - South County Road and in line with an old fence line running West, and fits well with measurements to corners 1/2 mile East and 1/2 mile West. We accepted the existing monument as the best available evidence of the position of the original corner.

C. Description of monument for corner and accessories established to perpetuate locating the position of the corner:

Accepted existing 1" dia. Iron Pipe/4" dia. Aluminum cap (DNR monument) stamped for corner:

5" dia. Ironwood	N75°E	41.43 feet	"X" cut in upper & lower blazes
8" dia. H. Maple	S41°E	69.08 feet	Ex. B.T.
9" dia. H. Maple	S49°W	51.24 feet	Ex. B.T.
10" dia. Twin H. Maple	S84°W	41.22 feet	Ex. B.T.
Metal Survey Sign Post	West	27.0 feet	

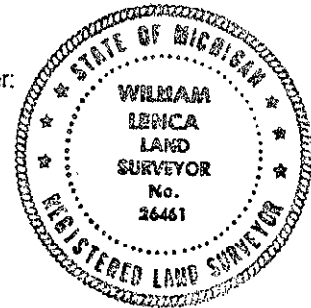

NOTE: All bearings are magnetic bearings. All distances are measured with steel tape. Distances to trees are to nail in side of tree.

Signed by William Lenca
 Surveyor's Michigan License No. 26461

Date Dec. 29, 1998