

APR 06 1999

SECTION

LAND CORNER RECORDATION CERTIFICATE
Filing Requirement of Act 74, Mich. P.A. 1970

Approved by Menominee County
Land Survey Reestablishment
Peer Group Under Act 245 of
P.A. of 1990 On 6/26/98 8
Mr. Davis RLS
Chairman

For corners in

MENOMINEE
(County)

Located in:

Corner Code #

1. Public Land Survey	T <u>36</u> NR <u>27</u> W	<u>B-05</u>
	T <u> </u> R <u> </u>	<u> </u>
	T <u> </u> R <u> </u>	<u> </u>
	T <u> </u> R <u> </u>	<u> </u>
2. Property Controlling in Section	S <u> </u> T <u> </u> R <u> </u>	<u> </u>
	S <u> </u> T <u> </u> R <u> </u>	<u> </u>
3. Miscellaneous Property in Sec.	S <u> </u> T <u> </u> R <u> </u>	<u> </u>
	S <u> </u> T <u> </u> R <u> </u>	<u> </u>

4. Lot No. _____, Recorded Plat _____
5. Private Claims _____

I, William Lenca, in a field survey on June 03, 19 98 do hereby state that under requirements of P.A. 74, Michigan P.A. of 1970, the corner points mentioned in lines 1 and 2 above were in conformance with regulations and rules therefore as required in the current manual of survey instructions of the United States Department of the Interior, Bureau of Land Management or by a decree of a Court of Law and/or that the corner points mentioned in lines 3, 4 and 5 above were in conformance with the rules of the Michigan Board of Land Surveyors or by a Decree of a Court of Law; established, re-established, monumented, recovered, found as expressed below:

NOTE: Not more than 2 corners, all in the same town and range, may be recorded on this certificate.

RECEIVED FOR RECORD
98 DEC -4 PM 3:48
PAGE # 651 RLS
BARBARA MORRISON
REGISTER OF DEEDS
MENOMINEE, MI 49858
Register of Deeds Stamp & File Number

1	A	B	C	D	E	F	G	H	I	J	K	L	M
2	6		5		4		3		2		1		
3													
4	7		8		9		10		11		12		
5													
6	18		17		16		15		14		13		
7													
8	19		20		21		22		23		24		
9													
10	30		29		28		27		26		25		
11													
12	31		32		33		34		35		36		
13													

A. Description of original monument and accessories and/or subsequent restoration:
1852: Original Survey by Francis Coleman - B.T.'s - Cedar, 16" - N55°W - 30 lks.; Fir, 10" - S41°E - 33 lks. All original evidence for this corner has been destroyed by county road improvements.
1991: Land Corner Recordation Certificate Number 901 by William Lenca RLS 26461 states, "Set corner in line with center of Co. Rd. N-S and in line with old fence lines E-W." Set 5/8" x 24" Iron Rod/Ident. cap: Nail in 12" Cedar, N38°E, 87.16'; Nail in 10" Cedar, S53°E, 89.60'; Nail in 6" Cedar, S58°W, 40.37'; Nail in 5" Cedar, N60°W, 42.56'.

B. Description of corner evidence found and/or method applied in restoring or reestablishing corner:
We found an existing P.K. nail and 4 bearing trees in a location as indicated in Land Corner Recordation Certificate Number 901 by William Lenca, RLS 26461. This location has been used for many years, fits existing lines of occupation, and is accepted as the best available evidence of the position of the original corner.

C. Description of monument for corner and accessories established to perpetuate locating the position of the corner:

Set 5/8" x 24" Iron Rod/3-1/4" dia. Alum. cap stamped for corner location in Monument Box:

16" dia. Cedar	N38°E	87.16 feet	Ex. BT
10" dia. Cedar	S53°E	89.60 feet	Ex. BT
8" dia. Cedar	S58°W	40.37 feet	Ex. BT
7" dia. Cedar	N60°W	42.56 feet	Ex. BT
Metal Survey Sign Post	West	29.5 feet	

NOTE: All bearings are magnetic bearings. All distances are measured with steel tape. Distances to trees are to nail in side of tree.

Signed by William Lenca
Surveyor's Michigan License No. 26461

Date June 22, 1998

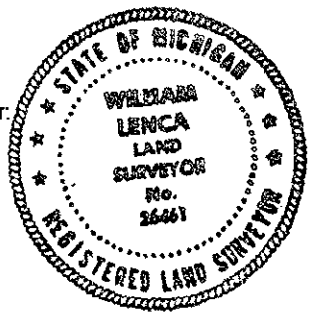

651