

APR 06 1999

Approved by Menominee County  
Land Survey Remuneration  
Peer Group Under Act 345 Of  
P.A. Of 1990 On 12/30 1998  
McDavis RLS  
Chairman

LAND CORNER RECORDATION CERTIFICATE  
Filing Requirement of Act 74, Mich. P.A. 1970

For corners in SECTION \_\_\_\_\_

<u>MENOMINEE</u> (County)	Located In:	Corner Code #
1. Public Land Survey	T36N R 27W	C-13
	T ___ R ___	_____
	T ___ R ___	_____
	T ___ R ___	_____
2. Property Controlling in Section	S ___ T ___ R ___	_____
	S ___ T ___ R ___	_____
3. Miscellaneous Property in Sec.	S ___ T ___ R ___	_____
	S ___ T ___ R ___	_____

RECEIVED FOR RECORD  
99 JAN -6 AM 8:55  
PAGE # 732 BK 5  
BARBARA MORRISON  
REGISTER OF DEEDS  
MENOMINEE, MI 49858

Register of Deeds Stamp & File Number

4. Lot No. \_\_\_\_\_, Recorded Plat \_\_\_\_\_  
5. Private Claims \_\_\_\_\_

(SAME AS CORNER C-01, T36N - R27W)

William Lenca, in a field survey on Dec. 17, 1998 do hereby state that under requirements of P.A. 74, Michigan P.A. of 1970, the corner points mentioned in lines 1 and 2 above were in conformance with regulations and rules therefore as required in the current manual of survey instructions of the United States Department of the Interior, Bureau of Land Management or by a decree of a Court of Law and /or that the corner points mentioned in lines 3, 4 and 5 above were in conformance with the rules of the Michigan Board of Land Surveyors or by a Decree of a Court of Law; established, re-established, monumented, recovered, found as expressed below:

NOTE: Not more than 2 corners, all in the same town and range, may be recorded on this certificate.

	A	B	C	D	E	F	G	H	I	J	K	L	M
1													
2		6		5		4		3		2		1	
3													
4		7		8		9		10		11		12	
5													
6		18		17		16		15		14		13	
7													
8		19		20		21		22		23		24	
9													
10		30		29		28		27		26		25	
11													
12		31		32		33		34		35		36	
13													

A. Description of original monument and accessories and/or subsequent restoration:

- 1848: Original Survey by H. Brevoort, Jr. - B.T.'s - Cedar, 10" - S80°W - 04 lks.; Tamarack, 10" - N55°E - 22 lks. All original evidence for this corner has been destroyed by logging activities.
- 1976: L.C.R.C. No. 213 by David B. Babbitt RLS No. 21558 states, "Set by prop. mea. and on line between the SE Section Corner of Sec. 32 and the S1/4 Corner of Sec. 31. Mea. to corners north and south are good and swamp calls fit well." Set 1" pipe, 4" Alum. cap. TIES: 4" Black Cherry - N87°W - 21.55'; 4" Balsam Fir - N72°E - 34.30'; 9" Cedar - S37°E - 94.50'; 5" Triple H. Maple - S40°W - 59.60'.

B. Description of corner evidence found and/or method applied in restoring or reestablishing corner:

We found a 1 inch diameter iron pipe with a 4 inch diameter aluminum cap (D.N.R. Monument) and 3 bearing trees in a location as indicated in Land Corner Recordation Certificate Number 133. This corner was re-set by single proportional measurement according to L.C.R.C. No. 213, and is accepted as a careful and faithful reestablishment of the position of the original corner.

C. Description of monument for corner and accessories established to perpetuate locating the position of the corner:

Accepted existing 1" dia. Iron Pipe/4" dia. Alum. cap (DNR monument) stamped for corner:

9" dia. Cedar	N82°E	14.14 feet	Ex. B.T.
5" dia. Cedar	S25°E	21.59 feet	"X" cut in upper & lower blazcs
9" dia. Cedar	N73°W	9.25 feet	Ex. B.T.
11" dia. Cedar	N12°W	21.53 feet	Ex. B.T.
Metal Survey Sign Post	North	1.0 feet	

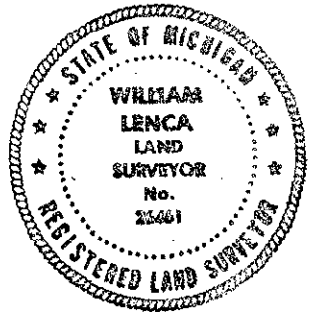

NOTE: All bearings are magnetic bearings. All distances are measured with steel tape. Distances to trees are to nail in side of tree.

Signed by William Lenca  
Surveyor's Michigan License No. 26461

Date Dec. 28, 1998