

LAND CORNER RECORDATION CERTIFICATE  
 Filing Requirement of Act 74, Mich. P.A. 1970

For corners in MENOMINEE (County) Located In: Corner Code ##

1. Public Land Survey T 35N R 27W G-1  
 T 36 R 27 G-13  
 T \_\_\_\_\_ R \_\_\_\_\_  
 T \_\_\_\_\_ R \_\_\_\_\_

2. Property Controlling in Section S \_\_\_\_\_ T \_\_\_\_\_ R \_\_\_\_\_  
 S \_\_\_\_\_ T \_\_\_\_\_ R \_\_\_\_\_

3. Miscellaneous Property in Sec. S \_\_\_\_\_ T \_\_\_\_\_ R \_\_\_\_\_  
 S \_\_\_\_\_ T \_\_\_\_\_ R \_\_\_\_\_

4. Lot No. \_\_\_\_\_, Recorded Plat \_\_\_\_\_

5. Private Claims \_\_\_\_\_

RECEIVED FOR RECORDS  
 95 NOV - 8 AM 11:30  
 PAGE # 224 BK 4  
 BARBARA JOHNSON  
 REGISTERED CLERK  
 MENOMINEE COUNTY, MICHIGAN

Register of Deeds Stamp & File Number

(Also G-13 T36N-R27W)

I, William Lenca, in a field survey on Jul 18, 19 95, do hereby certify that under requirements of P.A. 74, Michigan P.A. of 1970, the corner points mentioned in lines 1 and 2 above were in conformance with regulations and rules therefore as required in the current manual of survey instructions of the United States Department of the Interior, Bureau of Land Management or by a decree of a Court of Law and/or that the corner points mentioned in lines 3, 4 and 5 above were in conformance with the rules of the Michigan Board of Land Surveyors or by a Decree of a Court of Law; established, re-established, monumented, re-monumented, recovered, found as expressed below:

A	B	C	D	E	F	G	H	I	J	K	L	N
2	6	5	4	3	2	1						
3												
4	7	8	9	10	11	12						
5												
6	18	17	16	15	14	13						
7												
8	19	20	21	22	23	24						
9												
10	30	29	28	27	26	25						
11												
12	31	32	33	34	35	36						
13												

NOTE: Not more than 4 corners, all in the same town and range, may be recorded on this certificate.

- A. Description of original monument and accessories and/or subsequent restoration:
- 1847: Original Survey by H. Floyd (Township Exterior) - B.T.'s - Pine, 24" - N47°E - 33 lks; Pine, 22" - N52°W - 26 lks. All original evidence has been destroyed by county road improvements.
  - 1848: Original Survey by James H. Mullett (Section Subdivisions) - B.T.'s - Hemlock, 14" - S16°E - 44 lks; Hemlock, 10" - S19°W - 41 lks. All original evidence has been destroyed by county road improvements.

B. Description of corner evidence found and/or method applied in restoring or reestablishing corner:

In a field survey in March of 1995 we found a 3/4 inch diameter iron rod in the centerline of an East and West County Road and in line with an old fence line running North from this location. The measurement from this corner to the 1/4 Corner 1/2 mile East is 2660.04 feet. The distance to the 1/4 Corner 1/2 mile West is 2659.53 feet. The corner position fits well with existing lines of occupation and with other corners in the area, and is accepted as the best available evidence of the position of the original corner.

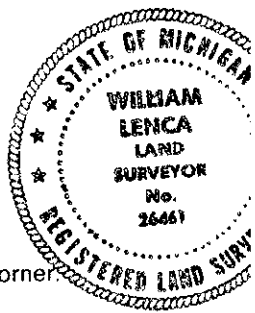

C. Description of monument for corner and accessories established to perpetuate locating the position of the corner:

Set 5/8" x 24" Iron Rod/3-1/4" dia. Alum. cap stamped for corner location in Monument Box:

18" dia. White Pine	N30°E	58.85 feet	
5/8" x 24" Iron Rod/2" dia. Alum. cap marked "WITNESS MARKER"	S05°W	34.34 feet	
8" dia. White Pine	S51°W	56.91 feet	Scr. NBT
14" dia. Cedar	S15°W	46.03 feet	Scr. NBT
Survey Sign Post	S05°W	34.7 feet	

NOTE: All bearings are magnetic bearings. All distances are measured with a steel tape. Distances to trees are to nail in side of tree.

Signed by William Lenca Date July 31, 1995  
 Surveyor's Michigan License No. 26461

224