

FEB 11 1998

Approved by Menominee County
Land Survey Remonumentation
Peer Group Under Act 345 Of

P.A. Of 1999 On 12/30, 1997

William Lenca
Chairman

SECTION

LAND CORNER RECORDATION CERTIFICATE
Filing Requirement of Act 74, Mich. P.A. 1970

For corners in MENOMINEE (County)	Located In:	Corner Code #
1. Public Land Survey	T <u>36</u> N R <u>27</u> W	K-07
	T ___ R ___	___
	T ___ R ___	___
	T ___ R ___	___
2. Property Controlling in Section	S ___ T ___ R ___	___
	S ___ T ___ R ___	___
3. Miscellaneous Property in Sec.	S ___ T ___ R ___	___
	S ___ T ___ R ___	___

RECORDED
97 DEC 30 PM 4:06
PAGE # 619
BARBARA KORTISON
REGISTER OF DEEDS
MENOMINEE, MICHIGAN

Register of Deeds Stamp & File Number

4. Lot No. _____, Recorded Plat _____
5. Private Claims _____

William Lenca, in a field survey on Dec. 01, 1997 do hereby state that under requirements of P.A. 74, Michigan P.A. of 1970, the corner points mentioned in lines 1 and 2 above were in conformance with regulations and rules therefore as required in the current manual of survey instructions of the United States Department of the Interior, Bureau of Land Management or by a decree of a Court of Law and/or that the corner points mentioned in lines 3, 4 and 5 above were in conformance with the rules of the Michigan Board of Land Surveyors or by a Decree of a Court of Law; established, re-established, monumented, recovered, found as expressed below.

	A	B	C	D	E	F	G	H	I	J	K	L	M
1													
2	6	5	4	3	2	1							
3													
4	7	8	9	10	11	12							
5													
6	18	17	16	15	14	13							
7													
8	19	20	21	22	23	24							
9													
10	30	29	28	27	26	25							
11													
12	31	32	33	34	35	36							
13													

NOTE: Not more than 2 corners, all in the same town and range, may be recorded on this certificate.

A. Description of original monument and accessories and/or subsequent restoration:

- 1852: Original Survey by Francis Coleman - B.T.'s - Hemlock, 10" - N59°E - 26 lks.; W. Pine, 24" - S51°W - 39 lks. All original evidence for this corner has been destroyed by logging and farming activities.
- 1963: L.C.R.C. No. 796, Vol. 2 by M.S.H.D. Survey Chief C.C. Lindgren states, "Found: Fe. corner, a 6" fe. post from original notes." TIES: Poplar, 5" - South - 27.74'; Thorn Apple, 3" - S80°W - 26.94'; Thorn Apple, 3" - N05°W - 17.76'.
- 1992: Certified Survey No. 760 by William Lenca, RLS No. 26461, shows this corner in relation to other corners in Section 23, T36N - R27W.

B. Description of corner evidence found and/or method applied in restoring or reestablishing corner:

We found a 2" diameter aluminum pipe / 3-1/4" aluminum cap marked "MENOMINEE RIVER 100 YEARS FLOOD" at ancient fence corner as indicated in Michigan State Highway Department records. This monument is typical of those used by George B. Wilson, RLS No. 17607. Fences run North - South, and West. This corner has been used for at least 34 years, fits existing lines of occupation, and is accepted as the best available evidence of the position of the original corner.

C. Description of monument for corner and accessories established to perpetuate locating the position of the corner:

Accepted existing 2" dia. Alum. Pipe with 3-1/4" alum. cap and stamped it for corner position:

9" dia. Cherry	North	6.84 feet	Scr. NBT
7" dia. Thorn Apple	S70°W	28.47 feet	Scr. NBT
Metal Survey Sign Post	North	0.8 feet	
Nothing else nearby			

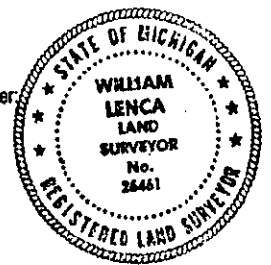

NOTE: All bearings are magnetic bearings. All distances are measured with steel tape. Distances to trees are to nail in side of tree.

Signed by William Lenca
Surveyor's Michigan License No. 26461

Date Dec. 03, 1997

619