

Approved by Menominee County
 Land Survey Reestablishment
 Pair Group Under Act 245 of
 P.A. of 1995 On 10/26 1995
Mike Davis RLS

LAND CORNER RECORDATION CERTIFICATE
 Filing Requirement of Act 74, Mich. P.A. 1970

For corners in

MENOMINEE
 (County)

Located In: _____ Corner Code: A-3

1. Public Land Survey	T	<u>36N</u>	R	<u>26W</u>	<u>A-3</u>
	T	_____	R	_____	_____
	T	<u>36</u>	R	<u>27</u>	<u>M-3</u> ✓
	T	_____	R	_____	_____
2. Property Controlling in Section	S	_____	T	_____	_____
	S	_____	T	_____	_____
3. Miscellaneous Property in Sec.	S	_____	T	_____	_____
	S	_____	T	_____	_____

RECEIVED FOR RECORD
 95 NOV - 8 AM 11:32
 PAGE 246 BK 4
 BARBARA MORRISON
 REGISTER OF DEEDS
 MENOMINEE, MI 49858
 Register of Deeds Stamp & File Number

4. Lot No. _____, Recorded Plat _____
 5. Private Claims _____

Same as M-03 T-36N, R-27W

I, William Lenca in a field survey on Apr 12, 19 95
 do hereby certify that under requirements of P.A. 74, Michigan P.A. of 1970, the corner points mentioned in lines 1 and 2 above were in conformance with regulations and rules therefore as required in the current manual of survey instructions of the United States Department of the Interior, Bureau of Land Management or by a decree of a Court of Law and/or that the corner points mentioned in lines 3, 4 and 5 above were in conformance with the rules of the Michigan Board of Land Surveyors or by a Decree of a Court of Law; established, re-established, monumented, re-monumented, recovered, found as expressed below:

A	B	C	D	E	F	G	H	I	J	K	L	M
2	6	5	4	3	2	1						
3												
4	7	8	9	10	11	12						
5												
6	18	17	16	15	14	13						
7												
8	19	20	21	22	23	24						
9												
10	30	29	28	27	26	25						
11												
12	31	32	33	34	35	36						
13												

NOTE: Not more than 4 corners, all in the same town and range, may be recorded on this certificate.

A. Description of original monument and accessories and/or subsequent restoration:

1848: Original Survey by James H. Mullett - B.T.'s - Cedar, 4" - N21°E - 16 lks; Fir, 10" - S74°W - 16 lks. All original evidence has been destroyed by logging activities.

B. Description of corner evidence found and/or method applied in restoring or reestablishing corner:

In a retracement of the West Line of Section 7 (also being the West Line of the Township) we found an ancient fence corner 1 chain North and .4 chains West of a swamp edge running northeast/southwest. This position fits GLO calls and is accepted as the best available evidence of the position of the original corner.

C. Description of monument for corner and accessories established to perpetuate locating the position of the corner:

Set AINBF30 Brnrtsen Monument stamped for corner at Ancient Fence Corner:

4" dia. Cedar	N61°E	45.81 feet	Scr. NBT
18" dia. Cedar	S06°E	15.05 feet	Scr. NBT
14" dia. Cedar	N80°W	20.42 feet	Scr. NBT
7" dia. Cedar	N13°W	18.93 feet	Scr. NBT
Survey Sign Post	S35°E	1.0 feet	

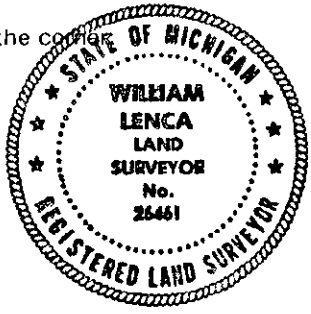

NOTE: All bearings are magnetic bearings. All distances are measured with a steel tape. Distances to trees are to nail in side of tree.

Signed by William Lenca Date May 24, 1995
 Surveyor's Michigan License No. 26461

246