

P.A. Of 1990 On 9/25 19996
McC Davis RLS
Chairman

LAND CORNER RECORDATION CERTIFICATE
Filing Requirement of Act 74, Mich. P.A. 1970

For corners in <u>MENOMINEE</u> (County)	Located in:	Corner Code #
1. Public Land Survey	<u>T36N R 28W</u>	<u>107</u>
	T ___ R ___	_____
	T ___ R ___	_____
	T ___ R ___	_____
2. Property Controlling in Section	S ___ T ___ R ___	_____
	S ___ T ___ R ___	_____
3. Miscellaneous Property in Sec.	S ___ T ___ R ___	_____

REGISTERED FOR RECORD
96 OCT -7 PM 3:25
PAGE # 352 BK. 4
BARBARA MORRISON
REGISTER OF DEEDS
MICHIGAN

Register of Deeds Stamp & File Number

4. Lot No. _____, Recorded Plat _____
5. Private Claims _____

I, William Lenca, in a field survey on July 02, 1996 do hereby state that under requirements of P.A. 74, Michigan P.A. of 1970, the corner points mentioned in lines 1 and 2 above were in conformance with regulations and rules therefore as required in the current manual of survey instructions of the United States Department of the Interior, Bureau of Land Management or by a decree of a Court of Law and for that the corner points mentioned in lines 3, 4 and 5 above were in conformance with the rules of the Michigan Board of Land Surveyors or by a Decree of a Court of Law; established, re-established, monumented, recovered, found as expressed below:

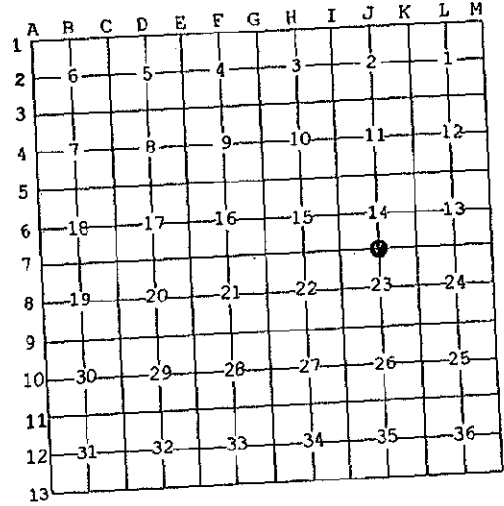

NOTE: Not more than 2 corners, all in the same town and range, may be recorded on this certificate.

A. Description of original monument and accessories and/or subsequent restoration:
1852: Original Survey by Francis Coleman - B.T.'s - Elm, 24" - N35°W - 37 lks; W. Pine, 18" - S57°E - 50 lks. All original evidence for this corner has been destroyed by farming activities.

B. Description of corner evidence found and/or method applied in restoring or reestablishing corner:
We set this corner at the base of an ancient fence corner with fences running North - South and West. This position also falls in line with the centerline of a county road running to the East. Our measured distance of 2660.00 feet East to the section corner matches well the the GLO distance of 2670.7 feet. This position also fits within 2 feet of splitting the mile. We accepted this location as the best available evidence of the position of the original corner.

C. Description of monument for corner and accessories established to perpetuate locating the position of the corner:
Set 5/8" x 24" Iron Rod/3-1/4" dia. Alum. cap stamped for corner location:

6" dia. White Ash	N15°E	55.87 feet	Scr. NBT
8" dia. Elm	S81°E	50.87 feet	Scr. NBT
Base of 4" dia. Iron Pipe - South Gate Post	S00°W	60.98 feet	
10" dia. Elm	N75°W	10.54 feet	Scr. NBT
Metal Survey Sign Post - could not set due to rocks			

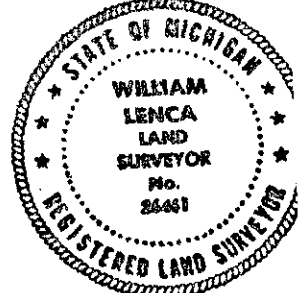

NOTE: All bearings are magnetic bearings. All distances are measured with steel tape. Distances to trees are to nail in side of tree.

Signed by William Lenca
Surveyor's Michigan License No. 26461

Date July 06, 1996