

# SURVEY & REMONUMENTATION

APR 24 1995

## LAND CORNER RECORDATION CERTIFICATE Filing Requirement of Act 74, Mich. P.A. 1970

Approved by Menominee County  
Land Survey Remonumentation  
Fee Group Under Act 345 Of  
P.A. Of 1990 On 10/19 19904

For corner of **COMMISSION**  
**MENOMINEE**  
(County)

	Located In:	Corner Code #
1. Public Land Survey	T <u>36</u> N R <u>28</u> W	<u>K-11</u>
	T _____ R _____	_____
	T _____ R _____	_____
	T _____ R _____	_____
2. Property Controlling in Section	S _____ T _____ R _____	_____
	S _____ T _____ R _____	_____
3. Miscellaneous Property in Sec.	S _____ T _____ R _____	_____
	S _____ T _____ R _____	_____

*ALYING*  
*BARBARA MORRISON*  
*REGISTER OF DEEDS*  
*MENOMINEE MI 49853*  
4 DEC 12 AM 8:58  
RECEIVED FOR RECORD  
Register of Deeds Stamp & File Number

4. Lot No. \_\_\_\_\_, Recorded Plat \_\_\_\_\_  
5. Private Claims \_\_\_\_\_

**William Lenca** Jul 18 1994

I, \_\_\_\_\_, in a field survey on \_\_\_\_\_, 19\_\_\_\_, do hereby certify that under requirements of P.A. 74, Michigan P.A. of 1970, the corner points mentioned in lines 1 and 2 above were in conformance with regulations and rules therefore as required in the current manual of survey instructions of the United States Department of the Interior, Bureau of Land Management or by a decree of a Court of Law and/or that the corner points mentioned in lines 3, 4 and 5 above were in conformance with the rules of the Michigan Board of Land Surveyors or by a Decree of a Court of Law; established, re-established, monumented, re-monumented, recovered, found as expressed below:

	A	B	C	D	E	F	G	H	I	J	K	L	M
2	6	5	4	3	2	1							
3													
4	7	8	9	10	11	12							
5													
6	18	17	16	15	14	13							
7													
8	19	20	21	22	23	24							
9													
10	30	29	28	27	26	25							
11													
12	31	32	33	34	35	36							
13													

**NOTE: Not more than 4 corners, all in the same town and range, may be recorded on this certificate.**

**A. Description of original monument and accessories and/or subsequent restoration:**

1852: Original Survey by Francis Coleman - B.T.'s - W. Pine, 24", N56°E, 29 lks & W. Pine, 24", S55°W, 30 lks - Found evidence of W. Pine, 24" - S56°W - 29 lks; the other B.T. has been destroyed by road improvements.

**B. Description of corner evidence found and/or method applied in restoring or reestablishing corner:**

We set this corner on in line with an old fence line North and in line with the centerline of a County Road running South, and at a position S56°W, 29 links (19.14 feet) from an old Pine Stump. John Starzzinski, a long time resident of the area, stated that this stump had been accepted and preserved as the corner location for many years. The measured distance between this corner and the NW Corner of the Section (where original evidence was recovered) fits within 2 feet of the GLO distance. This corner is accepted as a careful and faithful perpetuation of the position of the original corner.

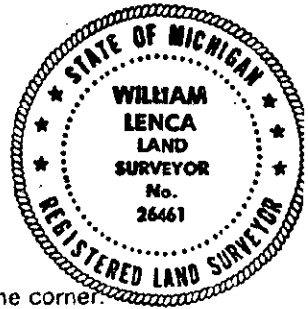

**C. Description of monument for corner and accessories established to perpetuate locating the position of the corner:**

Set 5/8" x 24" Iron Rod/3-1/4" dia. Alum. cap stamped for corner location:

8" dia. Norway Pine	N41°E	52.70 feet	Scr. NBT
10" dia. Norway Pine	S88°E	42.78 feet	Scr. NBT
6" dia. Norway Pine	S33°E	47.57 feet	Scr. NBT
5/8" x 24" Iron rod/2" dia. alum. cap - WITNESS MARKER	S78°W	49.09 feet	Scr. NBT
Survey Sign Post	East	3.5 feet	

**NOTE: All bearings are magnetic bearings. All distances are measured with steel tape. Distances to trees are to nail in side of tree.**

Signed by William Lenca Date Sep. 14, 1994  
Surveyor's Michigan License No. 26461