

SURVEY & REMONUMENTATION

OCT 27 1999

SECTION

**LAND CORNER RECORDATION CERTIFICATE P.A. of 1990 On 10/1 1999
Filing Requirement of Act 74, Mich. P.A. 1970**

Approved by Menominee County
Land Survey Remonumentation
Peer Group Under Act 345 Of

Chairman
Barbara Morrison
RECEIVED FOR RECORD
OCT 15 PM 1:41
FILE # 14 BK C
BARBARA MORRISON
REGISTER OF DEEDS
MENOMINEE MI 49858

For corners in

MENOMINEE
(County)

Located in:

Corner Code #

- | | | |
|------------------------------------|-----------------------------|-------------|
| 1. Public Land Survey | T <u>36</u> N R <u>28</u> W | <u>K-12</u> |
| | T ___ R ___ | _____ |
| | T ___ R ___ | _____ |
| | T ___ R ___ | _____ |
| 2. Property Controlling in Section | S ___ T ___ R ___ | _____ |
| | S ___ T ___ R ___ | _____ |
| 3. Miscellaneous Property in Sec. | S ___ T ___ R ___ | _____ |
| | S ___ T ___ R ___ | _____ |

Register of Deeds Stamp & File Number

4. Lot No. _____, Recorded Plat _____
5. Private Claims _____

I, William Lenca, in a field survey on July, 1999 do hereby state that under requirements of P.A. 74, Michigan P.A. of 1970, the corner points mentioned in lines 1 and 2 above were in conformance with regulations and rules therefore as required in the current manual of survey instructions of the United States Department of the Interior, Bureau of Land Management or by a decree of a Court of Law and /or that the corner points mentioned in lines 3, 4 and 5 above were in conformance with the rules of the Michigan Board of Land Surveyors or by a Decree of a Court of Law; established, re-established, monumented, recovered, found as expressed below:

NOTE: Not more than 2 corners, all in the same town and range, may be recorded on this certificate.

A	B	C	D	E	F	G	H	I	J	K	L	M
1												
2	6		5		4		3		2		1	
3												
4	7		8		9		10		11		12	
5												
6	18		17		16		15		14		13	
7												
8	19		20		21		22		23		24	
9												
10	30		29		28		27		26		25	
11												
12	31		32		33		34		35		36	
13												

A. Description of original monument and accessories and/or subsequent restoration:

- 1852: Original Survey by Francis Coleman - B.T.'s - W. Pine, 14" - N47°W - 18 lks; W. Pine, 24" - S45°E - 39 lks. All original evidence for this corner has been destroyed by county road improvements.
1999: Plat of Survey by Robert Goodreau, RLS No. 43053, shows this corner with the following ties: 10" Pine - S64°E - 79.65'; 8" Cedar - S36°W - 53.35'; 10" Maple - N44°W - 86.53'; Iron Pin w/cap - North - 81.0'.

B. Description of corner evidence found and/or method applied in restoring or reestablishing corner:

We found a P.K. Nail with brass washer in line with the centerline of a county road projected from the west and on line between the NE Corner and the NW Corner of Section 35, T36N-R28W. We also found 4 ties in location as described in part "A" above. This position fits reasonably well with measurements to corners 1/2 mile North and 1/2 mile South, and is accepted as the best available evidence of the position of the original corner.

C. Description of monument for corner and accessories established to perpetuate locating the position of the corner:

Set 5/8" x 24" Iron Rod/3-1/4" dia. Alum. cap stamped for corner location in Monument Box:

7" dia. White Pine	N61°E	71.29 feet	Scr. NBT
6" dia. White Pine	S40°E	72.31 feet	Scr. NBT
8" dia. Cedar	S36°W	53.56 feet	Scr. NBT
16" dia. White Pine	N12°W	101.00 feet	Scr. NBT
Metal Survey Sign Post	West	30.9 feet	

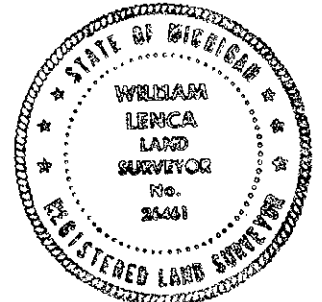

NOTE: All bearings are magnetic bearings. All distances are measured with steel tape. Distances to trees are to nail in side of tree.

Signed by William Lenca
Surveyor's Michigan License No. 26461

Date Sep. 15, 1999

14