

# SURVEY & REMONUMENTATION

APR 24 1995

## LAND CORNER RECORDATION CERTIFICATE Filing Requirement of Act 74, Mich. P.A. 1970

Approved by Menominee County  
Land Survey Remonumentation  
Peer Group Under Act 345 Of  
P.A. of 1990 On 12/9 19994  
*McDermis RLS*  
ACTING Chairman

For corner of **COMMISSION**  
MENOMINEE  
(County)

Located in: \_\_\_\_\_ Corner Code # \_\_\_\_\_

- |                                       |                           |       |       |
|---------------------------------------|---------------------------|-------|-------|
| 1. Public Land Survey                 | T <u>36N</u> R <u>28W</u> | _____ | L-9   |
|                                       | T _____ R _____           | _____ | _____ |
|                                       | T _____ R _____           | _____ | _____ |
|                                       | T _____ R _____           | _____ | _____ |
| 2. Property Controlling<br>in Section | S _____ T _____ R _____   | _____ | _____ |
|                                       | S _____ T _____ R _____   | _____ | _____ |
| 3. Miscellaneous<br>Property in Sec.  | S _____ T _____ R _____   | _____ | _____ |
|                                       | S _____ T _____ R _____   | _____ | _____ |

RECEIVED FOR RECORD  
94 DEC 12 AM 8:58  
PAGE # 101 BK 4  
BARBARA MORRISON  
REGISTER OF DEEDS  
MENOMINEE MI 49858  
Register of Deeds Stamp & File Number

4. Lot No. \_\_\_\_\_, Recorded Plat \_\_\_\_\_  
5. Private Claims \_\_\_\_\_

	A	B	C	D	E	F	G	H	I	J	K	L	N
2	6		5		4		3		2		1		
3													
4	7		8		9		10		11		12		
5													
6	16		17		18		15		14		13		
7													
8	19		20		21		22		23		24		
9													
10	30		29		28		27		26		25		
11													
12	31		32		33		34		35		36		
13													

I, William Lenca, in a field survey on June 27, 1994, do hereby certify that under requirements of P.A. 74, Michigan P.A. of 1970, the corner points mentioned in lines 1 and 2 above were in conformance with regulations and rules therofore as required in the current manual of survey instructions of the United States Department of the Interior, Bureau of Land Management or by a decree of a Court of Law and/or that the corner points mentioned in lines 3, 4 and 5 above were in conformance with the rules of the Michigan Board of Land Surveyors or by a Decree of a Court of Law: established, re-established, monumented, re-monumented, recovered, found as expressed below:

**NOTE: Not more than 4 corners, all in the same town and range, may be recorded on this certificate.**

A. Description of original monument and accessories and/or subsequent restoration:  
1852: Original Survey by Francis Coleman - B.T.'s - Tamarack, 18", N40°E, 16 lks & Fir, 6", S45°W, 15 lks - All original evidence for this corner has been destroyed by wood harvesting activities.

B. Description of corner evidence found and/or method applied in restoring or reestablishing corner:  
Set corner on line and midway between the Northwest Corner and the Northeast Corner of Section 25, T36N-R28W, and is accepted as a careful and faithful re-establishment of the position of the original corner.

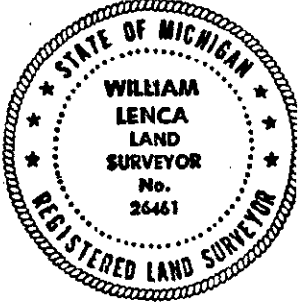

C. Description of monument for corner and accessories established to perpetuate locating the position of the corner:  
Set 2-1/2" dia. Alum. Pipe 30" long/3-1/4" dia. Alum cap stamped for corner location:

12" dia. Cedar	N89°E	17.34 feet	Scr. NBT
9" dia. Cedar	S10°W	7.74 feet	Scr. NBT
8" dia. Twin Cedar	N81°W	8.72 feet	Scr. NBT
6" dia. Cedar	North	26.17 feet	Scr. NBT
Carsonite Marker	S46°W	1.7 feet	

NOTE: All bearings are magnetic bearings. All distances are measured with steel tape. Distances to trees are to nail in side of tree.

Signed by William Lenca Date Sep. 14, 1994  
Surveyor's Michigan License No. 26461