

APR 06 1999

Approved _____ ee County
Land Survey Remonumentation
Peer Group Under Act 345 Of
P.A. OF 1980 G.S. 647 1998
McL Davis RLS
Chairman

SECTION

LAND CORNER RECORDATION CERTIFICATE
Filing Requirement of Act 74, Mich. P.A. 1970

For corners in

| <u>MENOMINEE</u> (County) | Located In: | Corner Code # |
|------------------------------------|-----------------------------|---------------|
| 1. Public Land Survey | T <u>36</u> N R <u>27</u> W | <u>A-03</u> |
| | T _____ R _____ | _____ |
| | T _____ R _____ | _____ |
| | T _____ R _____ | _____ |
| 2. Property Controlling in Section | S _____ T _____ R _____ | _____ |
| | S _____ T _____ R _____ | _____ |
| 3. Miscellaneous Property in Sec. | S _____ T _____ R _____ | _____ |
| | S _____ T _____ R _____ | _____ |

RECEIVED FOR RECORD
98 DEC -4 PM 3:48
PAGE # 647 BCL-5
BARBARA MORRISON
REGISTER OF DEEDS
MENOMINEE MI 49858

Register of Deeds Stamp & File Number

4. Lot No. _____, Recorded Plat _____
5. Private Claims _____

(SAME AS CORNER M-03 T36N - R28W)

I, William Lenca, in a field survey on June 01, 19 98 do hereby state that under requirements of P.A. 74, Michigan P.A. of 1970, the corner points mentioned in lines 1 and 2 above were in conformance with regulations and rules therefore as required in the current manual of survey instructions of the United States Department of the Interior, Bureau of Land Management or by a decree of a Court of Law and/or that the corner points mentioned in lines 3, 4 and 5 above were in conformance with the rules of the Michigan Board of Land Surveyors or by a Decree of a Court of Law; established, re-established, monumented, recovered, found as expressed below:

NOTE: Not more than 2 corners, all in the same town and range, may be recorded on this certificate.

| | A | B | C | D | E | F | G | H | I | J | K | L | M |
|----|----|---|---|----|---|---|----|---|---|----|---|----|----|
| 1 | | | | | | | | | | | | | |
| 2 | 6 | | | 5 | | | 4 | | | 3 | | 2 | 1 |
| 3 | | | | | | | | | | | | | |
| 4 | 7 | | | 8 | | | 9 | | | 10 | | 11 | 12 |
| 5 | | | | | | | | | | | | | |
| 6 | 18 | | | 17 | | | 16 | | | 15 | | 14 | 13 |
| 7 | | | | | | | | | | | | | |
| 8 | 19 | | | 20 | | | 21 | | | 22 | | 23 | 24 |
| 9 | | | | | | | | | | | | | |
| 10 | 30 | | | 29 | | | 28 | | | 27 | | 26 | 25 |
| 11 | | | | | | | | | | | | | |
| 12 | 31 | | | 32 | | | 33 | | | 34 | | 35 | 36 |
| 13 | | | | | | | | | | | | | |

A. Description of original monument and accessories and/or subsequent restoration:

- 1848: Original Survey - Township Boundary - by H. Brevoort, Jr. - B.T.'s - Beech, 14" - S82°W - 27 lks.; Beech, 13" - N61°W - 42 lks. All original evidence for this corner has been destroyed by logging activities.
- 1852: Sectional Subdivision by Francis Coleman - B.T.'s - Sugar, 12" - N58°E - 57 lks.; Sugar, 10" - S35°E - 40 lks. All original evidence for this corner has been destroyed by logging activities.
- 1983: Certified Survey Number 334 by George B. Wilson, RLS No. 17607, shows this corner as it relates to other corners in the SE1/4 of Section 1, T36N-R28W. No B.T.'s are given and no monument is described.

B. Description of corner evidence found and/or method applied in restoring or reestablishing corner:

We found a 3/4" diameter Aluminum rod with a 3-1/4" Aluminum cap at an ancient fence corner with fences running North, East, and West. This position has been used for many years, fits existing lines of occupation, and is accepted as the best available evidence of the position of the original corner.

C. Description of monument for corner and accessories established to perpetuate locating the position of the corner:

Accepted existing 3/4" Aluminum Rod/3-1/4" dia. Aluminum cap - Stamped cap for corner location:

| | | | |
|------------------------|-------|------------|----------|
| 5" dia. Maple | N24°E | 17.63 feet | Scr. NBT |
| 9" dia. Maple | S72°E | 9.88 feet | Scr. NBT |
| 9" dia. Maple | S32°W | 15.64 feet | Scr. NBT |
| 5" dia. Maple | N53°W | 36.14 feet | Scr. NBT |
| Metal Survey Sign Post | North | 1.0 feet | |

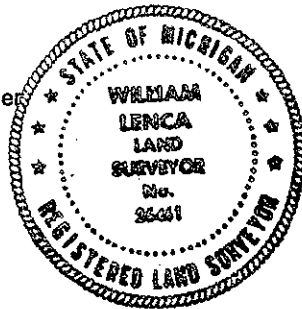

NOTE: All bearings are magnetic bearings. All distances are measured with steel tape. Distances to trees are to nail in side of tree.

Signed by William Lenca
Surveyor's Michigan License No. 26461

Date June 11, 1998

647