

LAND CORNER RECORDATION CERTIFICATE  
Filing Requirement of Act 74, Mich. P.A. 1970

Mc Davis RLS  
Chairman

RECEIVED FOR RECORD  
95 DEC 27 PM 3:32  
PAGE # 310 BK 4  
BARBARA JOHNSON  
REGISTERED LAND SURVEYOR  
MENOMINEE, MICHIGAN

Register of Deeds Stamp & File Number

For corners in  
MENOMINEE  
(County)

Located In: 37N 26W Corner Code M-3

- |                                    |   |   |              |
|------------------------------------|---|---|--------------|
| 1. Public Land Survey              | T | R |              |
|                                    | T | R |              |
|                                    | T | R | <u>A-3</u> ✓ |
|                                    | T | R |              |
| 2. Property Controlling in Section | S | T | R            |
|                                    | S | T | R            |
| 3. Miscellaneous Property in Sec.  | S | T | R            |
|                                    | S | T | R            |

4. Lot No. \_\_\_\_\_, Recorded Plat \_\_\_\_\_  
5. Private Claims \_\_\_\_\_  
(SAME AS A-3 T37N-R25W)

William Lenca July 31 1995

I, \_\_\_\_\_, in a field survey on \_\_\_\_\_, 19\_\_\_\_, do hereby certify that under requirements of P.A. 74, Michigan P.A. of 1970, the corner points mentioned in lines 1 and 2 above were in conformance with regulations and rules therefore as required in the current manual of survey instructions of the United States Department of the Interior, Bureau of Land Management or by a decree of a Court of Law and/or that the corner points mentioned in lines 3, 4 and 5 above were in conformance with the rules of the Michigan Board of Land Surveyors or by a Decree of a Court of Law; established, re-established, monumented, re-monumented, recovered, found as expressed below:

NOTE: Not more than 4 corners, all in the same town and range, may be recorded on this certificate.

A	B	C	D	E	F	G	H	I	J	K	L
2	6	5	4	3	2	1					
3											
4	7	8	9	10	11	12					
5											
6	18	17	16	15	14	13					
7											
8	19	20	21	22	23	24					
9											
10	30	29	28	27	26	25					
11											
12	31	32	33	34	35	36					
13											

A. Description of original monument and accessories and/or subsequent restoration:

- 1848: Original Survey by James H. Mullett - B.T.'s - Sugar Maple, 10" - S41°W - 81 lks; Sugar Maple, 10" - N69°W - 31 lks. All original evidence has been destroyed by county road improvements.
- 1899: Survey by Albert Hass, County Surveyor, shows subdivision of Section 7, T37N-R25W. His record states that the original corner was found, bearing trees standing. No new monument or witnesses are described.

B. Description of corner evidence found and/or method applied in restoring or reestablishing corner:

In a 1995 Survey in Section 12, T37N-R26W, we found a P.K. Nail in the centerline of county roads running North - South and East - West. The position of the P.K. fits closely with record measurements to the N1/4 Corner of Section 7, T37N-R25W. GLO record measurement = 37.47 chains or 2473 feet. Hass record measurement = 37.39 chains or 2467.7 feet. Our measurement = 2466.92 feet. This corner has been used by local surveyors for at least 13 years, and is accepted as the best available evidence of the position of the original corner.

C. Description of monument for corner and accessories established to perpetuate locating the position of the corner:  
Set 5/8" x 24" Iron Rod/3-1/4" dia. Alum. cap stamped for corner location in Monument Box:

- |   |       |             |          |
|---|-------|-------------|----------|
| SW Corner of Building Foundation                              | N70°E | 109.21 feet |          |
| 5/8" x 24" Iron Rod/2" dia. Alum. cap marked "WITNESS MARKER" | S44°E | 46.75 feet  |          |
| 8" dia. Elm   | S34°W | 66.31 feet  | Scr. NBT |
| 5/8" x 24" Iron Rod/2" dia. Alum. cap marked "WITNESS MARKER" | N29°W | 46.48 feet  |          |
| Metal Survey Sign Post  | N29°W | 47.0 feet   |          |

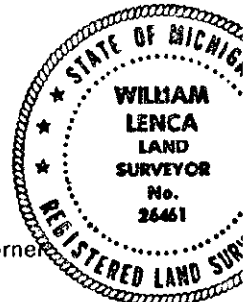

NOTE: All bearings are magnetic bearings. All distances are measured with a steel tape. Distances to trees are to nail in side of tree.

Signed by William Lenca Date Nov. 17, 1995  
Surveyor's Michigan License No. 26461

310