

**SURVEY &  
REMONUMENTATION**

MAY 28 1997

**COMMISSION**

**LAND CORNER RECORDATION CERTIFICATE**  
Filing Requirement of Act 74, Mich. P.A. 1970

Approved by Menominee County  
Land Survey Remonumentation  
Peer Group Under Act 345 Of  
P.A. Of 1990 On 12/27, 1996  
*Mr. Davis RLS*  
Chairman

For corners in

<u>MENOMINEE</u> (County)	Located In:	Corner Code #
1. Public Land Survey	T <u>37N</u> R <u>25W</u>	<u>A07</u>
	T _____ R _____	_____
	T _____ R _____	_____
	T _____ R _____	_____
2. Property Controlling in Section	S _____ T _____ R _____	_____
	S _____ T _____ R _____	_____
3. Miscellaneous Property in Sec.	S _____ T _____ R _____	_____
	S _____ T _____ R _____	_____

RECEIVED FOR RECORD  
97 JAN 17 AM 8 45  
PAGE # 479, BKS  
BARBARA MORRISON  
REGISTER OF DEEDS  
MENOMINEE, MI 49838  
Register of Deeds Stamp & File Number

4. Lot No. \_\_\_\_\_, Recorded Plat \_\_\_\_\_

5. Private Claims \_\_\_\_\_

SAME AS CORNER M-7, T37N-R26W

I, William Lenca, in a field survey on Dec. 16, 19 96 do hereby state that under requirements of P.A. 74, Michigan P.A. of 1970, the corner points mentioned in lines 1 and 2 above were in conformance with regulations and rules therefore as required in the current manual of survey instructions of the United States Department of the Interior, Bureau of Land Management or by a decree of a Court of Law and /or that the corner points mentioned in lines 3, 4 and 5 above were in conformance with the rules of the Michigan Board of Land Surveyors or by a Decree of a Court of Law; established, re-established, monumented, recovered, found as expressed below:

	A	B	C	D	E	F	G	H	I	J	K	L	M
1													
2		6		5		4		3		2		1	
3													
4		7		8		9		10		11		12	
5													
6		18		17		16		15		14		13	
7													
8		19		20		21		22		23		24	
9													
10		30		29		28		27		26		25	
11													
12		31		32		33		34		35		36	
13													

NOTE: Not more than 2 corners, all in the same town and range, may be recorded on this certificate.

A. Description of original monument and accessories and/or subsequent restoration:

- 1847: Original Survey (Twp Bdy) by James H. Mullett - B.T.'s - Tamarack, 12" - S85°W - 23 lks.; Tamarack, 7" - N67°W - 17 lks. No original evidence was evident.
- 1852: Original Survey (Sec Subd) by George Adair - B.T.'s - Tamarack, 10" - N66°W - 14 lks.; Tamarack, 12" - S44°E - 25 lks. Original evidence was destroyed by farming activities.
- 1986: L.C.R.C. No. 744, recorded by William Lenca, RLS No. 26461, states: "Set corner on line and proportionately between Township Corners - NW Corner Section 18 and SW Corner Section 19." Set 3/4" x 60" aluminum rod/3" dia. cap marked MENOMINEE COUNTY SURVEY MARKER - B.T.'s: 6" Cedar - S67°E - 52.12' (found); 5" Ash - S04°W - 55.66' (found); 6" Black Spruce - S63°W - 17.11' (gone); 6" Cedar - N20°W - 23.32' (found).

B. Description of corner evidence found and/or method applied in restoring or reestablishing corner:

We found that the corner monument described in L.C.R.C. No. 744 (see part A) had been destroyed by road improvements, however, we recovered 3 of the B.T.'s described in L.C.R.C. No. 744, and replaced the corner from these witnesses. This position fits with a single proportional location between the NW Corner of Section 18 (A-7) and the Southwest Corner of Section 19 (A-9), and is accepted as a careful and faithful reestablishment of the position of the original corner.

C. Description of monument for corner and accessories established to perpetuate locating the position of the corner:  
Set 2" dia. Aluminum Pipe/3-1/4" dia. Alum cap stamped for corner location:

6" dia. Cedar (Existing B.T.)	S67°E	52.12 feet	Scr. NBT
5" dia. White Ash (Existing B.T.)	S04°W	55.66 feet	Scr. NBT
Base of S. 2" dia. Iron Pipe Gate Post	West	41.02 feet	
6" dia. Cedar (Existing B.T.)	N20°W	23.32 feet	Scr. NBT
Metal Survey Sign Post	S60°W	2.7 feet	

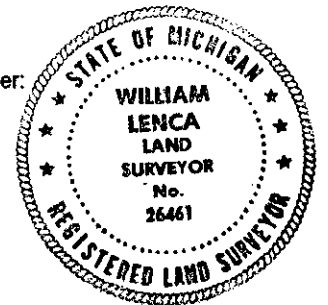

NOTE: All bearings are magnetic bearings. All distances are measured with steel tape. Distances to trees are to nail in side of tree.

Signed by William Lenca  
Surveyor's Michigan License No. 26461

Date Dec. 26, 1996