

PA. Of 1990 On 9/25 19926
McDawis RLS
Chairman

LAND CORNER RECORDATION CERTIFICATE
Filing Requirement of Act 74, Mich. P.A. 1970

For corners in
MENOMINEE
(County)

Located In:	Corner Code #
<u>T37N R 25W</u>	<u>A09</u>
T ___ R ___	_____
T ___ R ___	_____
T ___ R ___	_____
S ___ T ___	_____
S ___ T ___	_____
S ___ T ___	_____
S ___ T ___	_____

1. Public Land Survey

2. Property Controlling
in Section

3. Miscellaneous
Property in Sec.

RECEIVED FOR RECORDS
95 OCT - 7 PM 3:27
PAGE # 365 BK. 4
BARBARA MORRISON
REGISTER OF DEEDS
MENOMINEE COUNTY

Register of Deeds Stamp & File Number

4. Lot No. _____, Recorded Plat _____
5. Private Claims _____

SAME AS CORNER M-9 T37N-R26W

I, William Lenca, in a field survey on Jun. 19, 1996 do hereby state that under requirements of P.A. 74, Michigan P.A. of 1970, the corner points mentioned in lines 1 and 2 above were in conformance with regulations and rules therefore as required in the current manual of survey instructions of the United States Department of the Interior, Bureau of Land Management or by a decree of a Court of Law and for that the corner points mentioned in lines 3, 4 and 5 above were in conformance with the rules of the Michigan Board of Land Surveyors or by a Decree of a Court of Law; established, re-established, monumented, recovered, found as expressed below:

NOTE: Not more than 2 corners, all in the same town and range, may be recorded on this certificate.

	A	B	C	D	E	F	G	H	I	J	K	L	I
1													
2	6			5			4			3			2
3													
4	7			8			9			10			11
5													
6	18			17			16			15			14
7													
8	19			20			21			22			23
9													
10	30			29			28			27			26
11													
12	31			32			33			34			35
13													

- A. Description of original monument and accessories and/or subsequent restoration:
 1847: Original Survey (Twp Bdy) by James H. Mullett - B.T.'s - Birch, 16" - S73°W - 13 lks.; Black Ash, 10" - N38°W - 42 lks.
 All original evidence for this corner has been destroyed by fire & logging activities.
 1986: L.C.R.C. No. 743 recorded by William Lenca, RLS No. 26461, states that a 3/4" x 60" Iron/3" Alum. cap was set in place of very old squared wood post found matching GLO terrain calls. Ties: 8" Maple - S12°E - 40.00'; 9" Balsam - West - 17.85'; 20" W. Pine - N20°E - 25.55'; 24" W. Pine - N78°E - 39.00'.

B. Description of corner evidence found and/or method applied in restoring or reestablishing corner:
 We recovered a 3/4" diameter aluminum rod/3-1/4" aluminum cap and 4 Bearing Trees as described in L.C.R.C. No. 743 (See part "A"). This corner has been used for several years by local surveyors, and is accepted as the best available evidence of the position of the original corner.

C. Description of monument for corner and accessories established to perpetuate locating the position of the corner:
 Accepted existing 3/4" x 60" aluminum rod/3-1/4" Alum. cap stamed for corner location:

8" dia. Maple - Ex. B.T.	S12°E	40.00 feet	Scr. B.T.
9" dia. Balsam - Ex. B.T.	West	17.85 feet	Scr. B.T.
20" dia. White Pine - Ex. B.T.	N20°E	25.55 feet	Scr. B.T.
24" dia. White Pine - Ex. B.T.	N78°E	39.00 feet	Scr. B.T.
Metal Survey Sign Post	South	1.0 feet	

NOTE: All bearings are magnetic bearings. All distances are measured with steel tape. Distances to trees are to nail in side of tree.

Signed by William Lenca
Surveyor's Michigan License No. 26461

Date Sep. 24, 1996

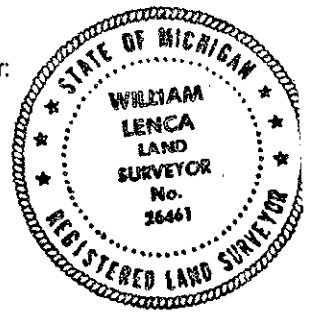

365