

McAvail DLS
Chairman

LAND CORNER RECORDATION CERTIFICATE
Filing Requirement of Act 74, Mich. P.A. 1970

For corners in

<u>MENOMINEE</u> (County)	Located In:	Corner Code #
1. Public Land Survey	T <u>37N</u> R <u>25W</u>	<u>A-11</u>
	T___ R___	_____
	T___ R___	_____
	T___ R___	_____
2. Property Controlling in Section	S___ T___ R___	_____
	S___ T___ R___	_____
3. Miscellaneous Property in Sec.	S___ T___ R___	_____
	S___ T___ R___	_____

RECEIVED FOR RECORD
96 OCT -7 PM 3:27
PAGE # 367 BK 4
BARBARA MORRISON
REGISTER OF DEEDS
MENOMINEE COUNTY

Register of Deeds Stamp & File Number

4. Lot No. _____, Recorded Plat _____
5. Private Claims _____

SAME AS CORNER M-11 T37N-R26W.

I, William Lenca, in a field survey on Nov. 06, 19 96 do hereby state that under requirements of P.A. 74, Michigan P.A. of 1970, the corner points mentioned in lines 1 and 2 above were in conformance with regulations and rules therefore as required in the current manual of survey instructions of the United States Department of the Interior, Bureau of Land Management or by a decree of a Court of Law and /or that the corner points mentioned in lines 3, 4 and 5 above were in conformance with the rules of the Michigan Board of Land Surveyors or by a Decree of a Court of Law; established, re-established, monumented, recovered, found as expressed below:

NOTE: Not more than 2 corners, all in the same town and range, may be recorded on this certificate.

	A	B	C	D	E	F	G	H	I	J	K	L	M
1													
2		6		5		4		3		2		1	
3													
4		7		8		9		10		11		12	
5													
6		18		17		16		15		14		13	
7													
8		19		20		21		22		23		24	
9													
10		30		29		28		27		26		25	
11													
12		31		32		33		34		35		36	
13													

A. Description of original monument and accessories and/or subsequent restoration:
1847: Original Survey (Twp Bdy) by James H. Mullett - B.T.'s - Cedar, 14" - S63°W - 22 lks.; Cedar, 9" - N50°W - 07 lks.
1852: Original Survey (Sec Subd) by George Adair - B.T.'s - White Pine, 12" - N63°E - 22 lks.; Cedar, 10" - S57°E - 29 lks. All original evidence for this corner has been destroyed by logging activities and fire.

B. Description of corner evidence found and/or method applied in restoring or reestablishing corner:

We set this corner on line and proportionately between the West Quarter Corner of Section 30 (A-10) and the Southwest Corner of Section 31 (A-13) of T37N-R25W. This location fits well with a GLO terrain call to a swamp edges 3 chains East and 2.5 chains South, and is accepted as a careful and faithful reestablishment of the position of the original corner.

C. Description of monument for corner and accessories established to perpetuate locating the position of the corner:
Set 2" dia. Aluminum Pipe/3-1/4" dia. Alum cap stamped for corner location:

7" dia. Cedar	N28°E	22.07 feet	Scr. NBT
6" dia. White Ash	S84°E	8.73 feet	Scr. NBT
10" dia. Cedar	S40°W	5.73 feet	Scr. NBT
9" dia. Cedar	N77°W	12.15 feet	Scr. NET
Metal Survey Sign Post	North	0.8 feet	

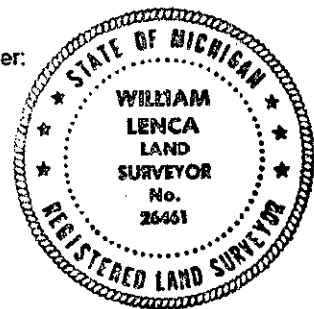

NOTE: All bearings are magnetic bearings. All distances are measured with steel tape. Distances to trees are to nail in side of tree.

Signed by William Lenca
Surveyor's Michigan License No. 26461

Date Sep. 24, 1996