

Mr. David RLS
Chairman

LAND CORNER RECORDATION CERTIFICATE
Filing Requirement of Act 74, Mich. P.A. 1970

For corners in

MENOMINEE

(County)

Located In:

Corner Code #

1. Public Land Survey

T37N R 25W

C03

T R

T R

T R

2. Property Controlling
in Section

S T

T R

S T

T R

3. Miscellaneous
Property in Sec.

S T

T R

S T

T R

RECEIVED FOR RECORD
96 OCT -7 PM 3:27
PAGE # 375 BR 4
BARBARA MORRISON
REGISTER OF DEEDS
MENOMINEE, MICHIGAN

Register of Deeds Stamp & File Number

4. Lot No. _____, Recorded Plat _____
5. Private Claims _____

I, William Lenca, in a field survey on July 24, 1996 do hereby state that under requirements of P.A. 74, Michigan P.A. of 1970, the corner points mentioned in lines 1 and 2 above were in conformance with regulations and rules therefore as required in the current manual of survey instructions of the United States Department of the Interior, Bureau of Land Management or by a decree of a Court of Law and /or that the corner points mentioned in lines 3, 4 and 5 above were in conformance with the rules of the Michigan Board of Land Surveyors or by a Decree of a Court of Law; established, re-established, monumented, recovered, found as expressed below:

NOTE: Not more than 2 corners, all in the same town and range, may be recorded on this certificate.

1	A	B	C	D	E	F	G	H	I	J	K	L
2		6		5		4		3		2		1
3			●									
4		7		8		9		10		11		12
5												
6		18		17		16		15		14		13
7												
8		19		20		21		22		23		24
9												
10		30		29		28		27		26		25
11												
12		31		32		33		34		35		36
13												

A. Description of original monument and accessories and/or subsequent restoration:

1852: Original Survey by George Adair - B.T.'s - Balm of Giliad, 10" - N70°W - 61 lks.; White Birch, 8" - S27°E - 87 lks. All original evidence for this corner has been destroyed by county road improvements.

1899: Subdivision of Section 7, T37N-R25W by Albert Haas, County Surveyor, states "Set Cedar Post from Government B.T." No new B.T.'s are given.

B. Description of corner evidence found and/or method applied in restoring or reestablishing corner:

A 1 inch square iron bolt was found in line with the centerline of county roads running North - South and West. The position of the bolt fits existing lines of occupation very closely, indicating that it has been used to establish property lines in the area. We accepted the iron bolt as the best available evidence of the position of the original corner.

C. Description of monument for corner and accessories established to perpetuate locating the position of the corner:
Set 2" dia. Aluminum Pipe/3-1/4" dia. Alum cap stamped for corner location:

10" dia. Elm	N11°E	49.08 feet	Scr. NBT
16" dia. Elm	S01°E	51.62 feet	Scr. NBT
6" dia. Elm	N82°W	93.94 feet	Scr. NBT
Metal Survey Sign Post	West	1.8 feet	
Nothing else nearby			

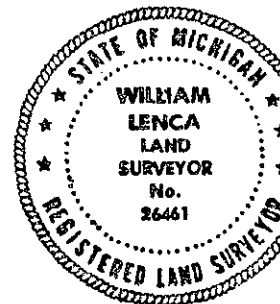

NOTE: All bearings are magnetic bearings. All distances are measured with steel tape. Distances to trees are to nail in side of tree.

Signed by William Lenca
Surveyor's Michigan License No. 26461

Date Sep. 24, 1996