

P.A. of 1990 On 12/20 19995
William Lenca
Chairman

LAND CORNER RECORDATION CERTIFICATE
Filing Requirement of Act 74, Mich. P.A. 1970

For corners in

<u>MENOMINEE</u> (County)	Located In:	Corner Code #
1. Public Land Survey	T <u>37</u> N R <u>25</u> W	C-5
	T _____ R _____	_____
	T _____ R _____	_____
	T _____ R _____	_____
2. Property Controlling in Section	S _____ T _____ R _____	_____
	S _____ T _____ R _____	_____
3. Miscellaneous Property in Sec.	S _____ T _____ R _____	_____
	S _____ T _____ R _____	_____

REGISTERED FOR RECORD
95 DEC 27 PM 3:30
PAGE # 291 BK 1
BUREAU OF LAND SURVEY
REGISTERED DEEDS
HERBERT W. HARRIS

Register of Deeds Stamp & File Number

4. Lot No. _____, Recorded Plat _____
5. Private Claims _____

I, William Lenca, in a field survey on Dec. 04, 1995 do hereby state that under requirements of P.A. 74, Michigan P.A. of 1970, the corner points mentioned in lines 1 and 2 above were in conformance with regulations and rules therefore as required in the current manual of survey instructions of the United States Department of the Interior, Bureau of Land Management or by a decree of a Court of Law and/or that the corner points mentioned in lines 3, 4 and 5 above were in conformance with the rules of the Michigan Board of Land Surveyors or by a Decree of a Court of Law; established, re-established, monumented, recovered, found as expressed below.

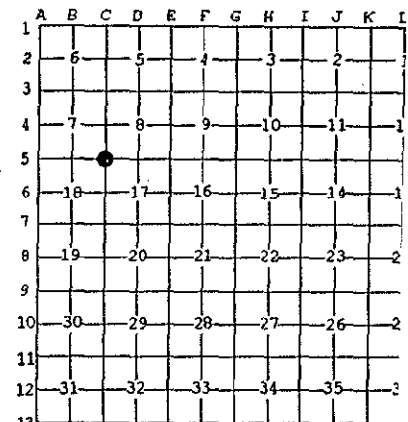

NOTE: Not more than 2 corners, all in the same town and range, may be recorded on this certificate.

A. Description of original monument and accessories and/or subsequent restoration:

- 1852: Original Survey by George Adair - B.T.'s - Sugar, 12" - S77.5°W - 21 lks; Cedar, 14" - N70°E - 27 lks. All original evidence has been destroyed by county road improvements.
- 1899: Plat of Survey by Albert Hass, County Surveyor, shows a subdivision of Section 7, T37N-R25W, and states "Original Gov't Corner found & Bearing Trees plain". No description of the monument is given and no new ties are given.
- 1899: Plat of Survey by Albert Hass, County Surveyor, shows a subdivision of Section 7, T37N-R25W, and states "Set Cedar Post from Gov't B.T.". No new ties are given.

B. Description of corner evidence found and/or method applied in restoring or reestablishing corner:

In our 1995 Remonumentation Survey in T37N-R25W, we recovered a 1/2 inch diameter iron 6' North of the centerline of an East - West gravel surface county road, and in line with an old fence North & field furrow South. Our measured distance to the Section Corner 1 mile East is 5262.19 feet, compared to Albert Hass' record distance of 5273.4 feet. Our measured distance 1/2 mile West to the 1/4 Corner is 2635.88 feet compared to Albet Hass' record distance of 2640 feet. We accepted the position of the 1/2 inch diameter iron as the best available evidence of the position of the original corner.

C. Description of monument for corner and accessories established to perpetuate locating the position of the corner:

Set 5/8" x 24" Iron Rod/3-1/4" dia. Alum. cap stamped for corner location:

18" dia. Maple	N86°E	69.88 feet	Scr. NBT
16" dia. Tamarack	S63°W	150.75 feet	Scr. NBT
5/8" x 24" Iron Rod/2" dia. Alum. cap marked "WITNESS MARKER"	South	31.81 feet	
5" dia. Cedar	N03°E	70.98 feet	Scr. NBT
Metal Survey Sign Post	South	32.2 feet	

NOTE: All bearings are magnetic bearings. All distances are measured with EDM. Distances to trees are to nail in side of tree.

Signed by William Lenca
Surveyor's Michigan License No. 26461

Date Dec. 13, 1995

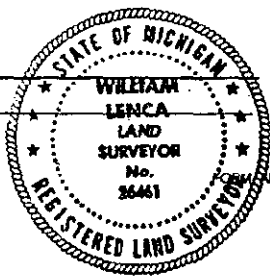

APPROVED BY MICHIGAN STATE BOARD OF PROFESSIONAL SURVEYORS, JAN. 1995
REVISED MAY
REVISED JA
REVISED OC