

LAND CORNER RECORDATION CERTIFICATE
 Filing Requirement of Act 74, Mich. P.A. 1970

For corners in
MENOMINEE
 (County)

Located In: Corner Code #

1. Public Land Survey T37N R 25W C-7
 T R
 T R
 T R

2. Property Controlling in Section S T R
 S T R
 S T R

3. Miscellaneous Property in Sec. S T R
 S T R

4. Lot No. _____, Recorded Plat _____
 5. Private Claims _____

RECEIVED FOR RECORD
 95 DEC 27 PM 3:31
 PAGE # 293 BK 4
 BARBARA HORNINSON
 REGISTERED CLERK
 REGISTERED LAND SURVEYOR

Register of Deeds Stamp & File Number

I, William Lenca, in a field survey on Dec. 04, 1995, do hereby state that under requirements of P.A. 74, Michigan P.A. of 1970, the corner points mentioned in lines 1 and 2 above were in conformance with regulations and rules therefore as required in the current manual of survey instructions of the United States Department of the Interior, Bureau of Land Management or by a decree of a Court of Law and for that the corner points mentioned in lines 3, 4 and 5 above were in conformance with the rules of the Michigan Board of Land Surveyors or by a Decree of a Court of Law, established, re-established, monumented, recovered, found as expressed below:

NOTE: Not more than 2 corners, all in the same town and range, may be recorded on this certificate.

A	B	C	D	E	F	G	H	I	J	K	L
1											
2	6	5	4	3	2	1					
3											
4	7	8	9	10	11	12					
5											
6	18	17	16	15	14	13					
7											
8	19	20	21	22	23	24					
9											
10	30	29	28	27	26	25					
11											
12	31	32	33	34	35	36					
13											

A. Description of original monument and accessories and/or subsequent restoration:

- 1852: Original Survey by George Adair - B.T.'s - W. Pine, 34" - S44°W - 30 lks; Hemlock, 13" - N52°E - 53 lks. All original evidence has been destroyed by farming activities.
- 1986: LCRC No. 744, by William Lenca, RLS No. 26461, states that a 3/4" x 60" Alum. Rod/3" dia. cap marked "MENOMINEE COUNTY SURVEY MARKER" was set on old E-W Fence at a proportional distance between the NW Corner of Section 19 and the N1/4 Corner of Section 17 (should be N1/4 Cor. of Sec. 20). This location fits very closely with GLO call to a stream to the East. No ties.

B. Description of corner evidence found and/or method applied in restoring or reestablishing corner:

In our 1995 Remonumentation Survey in T37N-R25W, we recovered a 3/4" diameter aluminum rod with a 3-1/4 inch diameter cap in an old East - West Fence Line and at a proportional location between the NW Corner of Section 19 and the N1/4 Corner of Section 20. This location also agrees with the GLO distance North to the W1/4 Corner of Section 17, and is accepted as the best available evidence of the position of the original corner.

C. Description of monument for corner and accessories established to perpetuate locating the position of the corner:
 Accepted 3/4" diameter aluminum rod/3-1/4" dia. alum. cap stamped for corner location:

Metal Survey Sign Post North 1.0 feet
 Farm Field - Nothing else nearby

NOTE: All bearings are magnetic bearings. All distances are measured with steel tape. Distances to trees are to nail in side of tree.

Signed by William Lenca
 Surveyor's Michigan License No. 26461

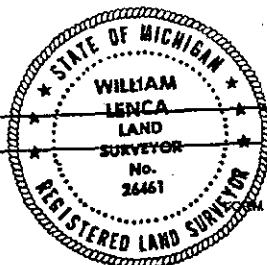

Date Dec. 13, 1995