

LAND CORNER RECORDATION CERTIFICATE  
Filing Requirement of Act 74, Mich. P.A. 1970

P.A. Of 1990 On 12/19 1996  
Mr. Davis RLS

For corners in

<u>MENOMINEE</u> (County)	Located In:	Corner Code #
1. Public Land Survey	T <u>37</u> N R <u>25</u> W	<u>C08</u>
	T _____ R _____	_____
	T _____ R _____	_____
	T _____ R _____	_____
2. Property Controlling in Section	S _____ T _____ R _____	_____
	S _____ T _____ R _____	_____
3. Miscellaneous Property in Sec.	S _____ T _____ R _____	_____

Chairman  
DEC 30 AM 9:08  
460  
R.L.S.

Register of Deeds Stamp & File Number

4. Lot No. \_\_\_\_\_, Recorded Plat \_\_\_\_\_  
5. Private Claims \_\_\_\_\_

I, William Lenca, in a field survey on Apr 16, 19 96 do hereby state that under requirements of P.A. 74, Michigan P.A. of 1970, the corner points mentioned in lines 1 and 2 above were in conformance with regulations and rules therefore as required in the current manual of survey instructions of the United States Department of the Interior, Bureau of Land Management or by a decree of a Court of Law and/or that the corner points mentioned in lines 3, 4 and 5 above were in conformance with the rules of the Michigan Board of Land Surveyors or by a Decree of a Court of Law; established, re-established, monumented, recovered, found as expressed below:

A	B	C	D	E	F	G	H	I	J	K	L	M
1												
2	6		5		4		3		2		1	
3												
4	7		8		9		10		11		12	
5												
6	18		17		16		15		14		13	
7												
8	19		20		21		22		23		24	
9												
10	30		29		28		27		26		25	
11												
12	31		32		33		34		35		36	
13												

NOTE: Not more than 2 corners, all in the same town and range, may be recorded on this certificate.

A. Description of original monument and accessories and/or subsequent restoration:

- 1852: Original Survey by George Adair - B.T.'s - Hemlock, 12" - N33°W - 21 lks.; Ironwood, 10" - S19°W - 25 lks. Original evidence was destroyed by county road improvements.
- 1982: L.C.R.C. No. 524 by George B. Wilson, RLS No. 17607, states: Set W-1-B Monument in center of roadway South, East and West. No B.T.'s are givc.
- 1982: CERTIFIED SURVEY No. 300 by George B. Wilson, RLS No. 17607, shows this corner as it relates to other corners in Section 20, T37N-R25W.

B. Description of corner evidence found and/or method applied in restoring or reestablishing corner:

The Center Quarter Corner and the East Quarter Corner of Section 20, T37N-R25W, were monumented and shown in Certified Survey No. 300. We projected the line between these corners to the West a distance of 2608.26 feet to arrive at the position as shown in said certified survey. We were unable to locate any monumentation at this location, however the position fits with the description in L.C.R.C. No. 524. This corner location has been accepted and used by local surveyors for several years, and is accepted as the best available evidence of the position of the original corner.

C. Description of monument for corner and accessories established to perpetuate locating the position of the corner:  
Set 5/8" x 24" Iron Rod/3-1/4" dia. Alum. cap stamped for corner location in Monument Box:

- |   |       |            |          |
|---|-------|------------|----------|
| 5/8" x 24" Iron Rod/2" dia. Alum. cap marked "WITNESS MARKER" | North | 32.34 feet |          |
| 5/8" x 24" Iron Rod/2" dia. Alum. cap marked "WITNESS MARKER" | S30°E | 45.26 feet |          |
| 12" dia. Maple  | S40°W | 62.58 feet | Scr. NBT |
| Metal Survey Sign Post  | North | 33.30 feet |          |

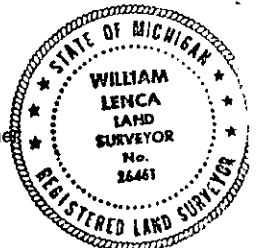

NOTE: All bearings are magnetic bearings. All distances are measured with steel tape. Distances to trees are to nail in side of tree.

Signed by William Lenca  
Surveyor's Michigan License No. 26461

Date Dec. 19, 1996

460