

LAND CORNER RECORDATION CERTIFICATE
 Filing Requirement of Act 74, Mich. P.A. 1970

For corners in

MENOMINEE
 (County)

Located in:

Corner Code #

- | | | |
|------------------------------------|---------------------------|------------|
| 1. Public Land Survey | T <u>37N</u> R <u>25W</u> | <u>C09</u> |
| | T ___ R ___ | ___ |
| | T ___ R ___ | ___ |
| | T ___ R ___ | ___ |
| 2. Property Controlling in Section | S ___ T ___ R ___ | ___ |
| | S ___ T ___ R ___ | ___ |
| 3. Miscellaneous Property in Sec. | S ___ T ___ R ___ | ___ |
| | S ___ T ___ R ___ | ___ |

REGISTERED LAND SURVEYOR
 WILLIAM LENCA
 No. 26461
 95 DEC 30 AM 9:09
 459 BK 5

Register of Deeds Stamp & File Number

4. Lot No. _____, Recorded Plat _____
 5. Private Claims _____

I, William Lenca, in a field survey on Dec 05, 1996 do hereby state that under requirements of P.A. 74, Michigan P.A. of 1970, the corner points mentioned in lines 1 and 2 above were in conformance with regulations and rules therefore as required in the current manual of survey instructions of the United States Department of the Interior, Bureau of Land Management or by a decree of a Court of Law and /or that the corner points mentioned in lines 3, 4 and 5 above were in conformance with the rules of the Michigan Board of Land Surveyors or by a Decree of a Court of Law; established, re-established, monumented, recovered, found as expressed below:

NOTE: Not more than 2 corners, all in the same town and range, may be recorded on this certificate.

A	B	C	D	E	F	G	H	I	J	K	L	M
1												
2	6	5	4	3	2							
3												
4	7	8	9	10	11	12						
5												
6	18	17	16	15	14	13						
7												
8	19	20	21	22	23	24						
9												
10	30	29	28	27	26	25						
11												
12	31	32	33	34	35	36						
13												

A. Description of original monument and accessories and/or subsequent restoration:

1852: Original Survey by George Adair - B.T.'s - Sugar Maple, 13" - N46°E - 30 lks.; Ironwood, 10" - S78°W - 10 lks. Original corner evidence was destroyed by county road improvements.

B. Description of corner evidence found and/or method applied in restoring or reestablishing corner:

We recovered a 1/2 inch diameter x 18 inch long iron rod in the centerline of North - South County Road and in Line with ancient fences running East and West. This corner has been used by local surveyors for several years, and is accepted as the best available evidence of the position of the original corner.

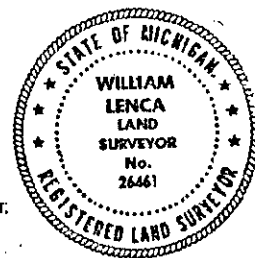

C. Description of monument for corner and accessories established to perpetuate locating the position of the corner.
 Set 5/8" x 24" Iron Rod/3-1/4" dia. Alum. cap stamped for corner location.

Twin 10" dia. Maple	N25°W	35.93 feet	Scr. NBT
6" dia. Balsam	S74°E	71.24 feet	Scr. NBT
5/8" x 24" Iron Rod/2" dia. Alum. cap marked "WITNESS MARKER"	S86°W	28.33 feet	
Metal Survey Sign Post	S86°W	29.60 feet	

NOTE: All bearings are magnetic bearings. All distances are measured with steel tape. Distances to trees are to nail in side of tree.

Signed by William Lenca
 Surveyor's Michigan License No. 26461

Date Dec. 19, 1996

459