

LAND CORNER RECORDATION CERTIFICATE
Filing Requirement of Act 74, Mich. P.A. 1970

Mc Dowell DLS
Chairman

For corners in

MENOMINEE
(County)

Located in:

Corner Code #

1. Public Land Survey

T 37N R 25W D01

T R

T R

T R

2. Property Controlling
in Section

S T R

S T R

3. Miscellaneous
Property in Sec.

S T R

S T R

96 DEC 30 PM 9 08
PAGE 455 BK 5
REGISTERED LAND SURVEYOR

Register of Deeds Stamp & File Number

4. Lot No. _____, Recorded Plat _____

5. Private Claims _____

SAME AS CORNER D-13, T38N-R25W

I, William Lenca, in a field survey on Jun 11, 1996, do hereby state that under requirements of P.A. 74, Michigan P.A. of 1970, the corner points mentioned in lines 1 and 2 above were in conformance with regulations and rules therefore as required in the current manual of survey instructions of the United States Department of the Interior, Bureau of Land Management or by a decree of a Court of Law and /or that the corner points mentioned in lines 3, 4 and 5 above were in conformance with the rules of the Michigan Board of Land Surveyors or by a Decree of a Court of Law, established, re-established, monumented, recovered, found as expressed below:

NOTE: Not more than 2 corners, all in the same town and range, may be recorded on this certificate.

A	B	C	D	E	F	G	H	I	J	K	L	M
1												
2	6		5		4		3		2		1	
3												
4	7		8		9		10		11		12	
5												
6	18		17		16		15		14		13	
7												
8	19		20		21		22		23		24	
9												
10	30		29		28		27		26		25	
11												
12	31		32		33		34		35		36	
13												

A. Description of original monument and accessories and/or subsequent restoration:

1847: Original Survey by James H. Mullett - B.T.'s - Cedar, 4" - N36°W - 09 lks.; Cedar, 6" - N69°E - 29 lks. All original evidence for this corner has been destroyed by farming activities.

B. Description of corner evidence found and/or method applied in restoring or reestablishing corner:

We set this corner in line with the centerline of county roads running North and West, and with an ancient fence line running East. This corner fits reasonably well with measurements to corners 1/2 mile East and 1/2 mile West, and is accepted as the best available evidence of the position of the original corner.

C. Description of monument for corner and accessories established to perpetuate locating the position of the corner:

Set 2" dia. Aluminum Pipe/3-1/4" dia. Alum. cap stamped for corner location:

5/8" x 24" Iron Rod/2" dia. Alum. cap marked "WITNESS MARKER"	N39°E	48.98 feet
5/8" x 24" Iron Rod/2" dia. Alum. cap marked "WITNESS MARKER"	S82°W	100.97 feet
5/8" x 24" Iron Rod/2" dia. Alum. cap marked "WITNESS MARKER"	N64°W	76.83 feet
Metal Survey Sign Post	East	33.80 feet

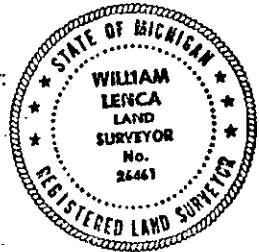

NOTE: All bearings are magnetic bearings. All distances are measured with steel tape. Distances to trees are to nail in side of tree.

Signed by William Lenca
Surveyor's Michigan License No. 26461

Date Dec. 19, 1996

455