

LAND CORNER RECORDATION CERTIFICATE  
 Filing Requirement of Act 74, Mich. P.A. 1970

For corners in  
MENOMINEE  
 (County)

Located In:	Corner Code #
1. Public Land Survey	T37N R 25W D-7
	T___ R___
	T___ R___
	T___ R___
2. Property Controlling in Section	S___ T___ R___
	S___ T___ R___
3. Miscellaneous Property in Sec.	S___ T___ R___
	S___ T___ R___

RECEIVED FOR RECORD  
 95 DEC 27 PM 3:31  
 PAGE # 295 BK 4  
 BARBARA JOHNSON  
 REGISTER OF DEEDS  
 MENOMINEE, MI 49858  
 Register of Deeds Stamp & File Number

4. Lot No. \_\_\_\_\_, Recorded Plat \_\_\_\_\_  
 5. Private Claims \_\_\_\_\_

I, William Lenca, in a field survey on Jan. 19, 1995 do hereby state that under requirements of P.A. 74, Michigan P.A. of 1970, the corner points mentioned in lines 1 and 2 above were in conformance with regulations and rules therefore as required in the current manual of survey instructions of the United States Department of the Interior, Bureau of Land Management or by a decree of a Court of Law and /or that the corner points mentioned in lines 3, 4 and 5 above were in conformance with the rules of the Michigan Board of Land Surveyors or by a Decree of a Court of Law, established, re-established, monumented, recovered, found as expressed below.

NOTE: Not more than 2 corners, all in the same town and range, may be recorded on this certificate.

A	B	C	D	E	F	G	H	I	J	K	L
1											
2	6	5	4	3	2	1					
3											
4	7	8	9	10	11	12					
5											
6	10	17	16	15	14	13					
7		●									
8	19	20	21	22	23	24					
9											
10	30	29	28	27	26	25					
11											
12	31	32	33	34	35	36					
13											

A. Description of original monument and accessories and/or subsequent restoration:

- 1852: Original Survey by George Adair - B.T.'s - Cedar, 11" - S23° W - 94 lks (found in poor condition); Cedar, 10" - S25.5°W - 90 lks (found in poor condition).
- 1982: L.C.R.C. No. 525 by George B. Wilson, RLS No. 17607, states that a "HDR" monument was set from 2 original B.T.'s with blaze marks. TIES: Deep - 1 - 2 feet North and 2 feet East.

B. Description of corner evidence found and/or method applied in restoring or reestablishing corner:

In our 1995 Remonumentation Survey in T37N-R25W, we recovered a 3/4 inch diameter aluminum rod with 3-1/4 inch diameter aluminum cap marked "MENOMINEE COUNTY SURVEY CORNER" (Bernsen "HDR" Monument). We also found 2 badly decayed Cedar stumps in proper location to match original B.T.'s. We accepted the HDR Monument as a careful and faithful perpetuation of the position of the original corner.

C. Description of monument for corner and accessories established to perpetuate locating the position of the corner:  
 Accepted 3/4" dia. Aluminum Rod with 3-1/4" dia. Alum. cap marked stamped for corner location:

5" dia. Elm	N10°E	61.54 feet	Scr. NBT
9" dia. Elm	S78°E	60.01 feet	Scr. NBT
8" dia. Elm	S17°W	56.15 feet	Scr. NBT
6" dia. White Ash	N75°W	48.23 feet	Scr. NBT
Metal Survey Sign Post	North	1.1 feet	

NOTE: All bearings are magnetic bearings. All distances are measured with steel tape. Distances to trees are to nail in side of tree.

Signed by William Lenca  
 Surveyor's Michigan License No. 26461

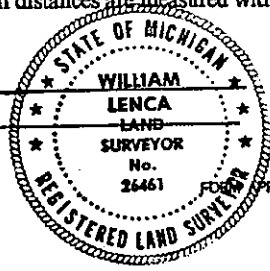

Date Dec. 13, 1995