

LAND CORNER RECORDATION CERTIFICATE  
Filing Requirement of Act 74, Mich. P.A. 1970

*Mc Davis RLS*

For corners in

<u>MENOMINEE</u> (County)	Located in:	Corner Code #
1. Public Land Survey	T <u>37N</u> R <u>25W</u>	<u>E 6</u>
	T _____ R _____	_____
	T _____ R _____	_____
	T _____ R _____	_____
2. Property Controlling in Section	S _____ T _____ R _____	_____
	S _____ T _____ R _____	_____
3. Miscellaneous Property in Sec.	S _____ T _____ R _____	_____
	S _____ T _____ R _____	_____

Chairman  
PAGE # 298 844  
95 DEC 27 PM 3:31  
RECEIVED FOR RECORD  
BARBARA HORTONSON  
REGISTERED DEEDS  
MENOMINEE COUNTY

Register of Deeds Stamp & File Number

4. Lot No. \_\_\_\_\_, Recorded Plat \_\_\_\_\_  
5. Private Claims \_\_\_\_\_

I, William Lenca, in a field survey on Jan 30, 19 95 do hereby state that under requirements of P.A. 74, Michigan P.A. of 1970, the corner points mentioned in lines 1 and 2 above were in conformance with regulations and rules therefore as required in the current manual of survey instructions of the United States Department of the Interior, Bureau of Land Management or by a decree of a Court of Law and /or that the corner points mentioned in lines 3, 4 and 5 above were in conformance with the rules of the Michigan Board of Land Surveyors or by a Decree of a Court of Law; established, re-established, monumented, recovered, found as expressed below:

NOTE: Not more than 2 corners, all in the same town and range, may be recorded on this certificate.

1	A	B	C	D	E	F	G	H	I	J	K	L
2		6		5		4		3		2		1
3												
4		7		8		9		10		11		12
5												
6		18		17		16		15		14		13
7												
8		19		20		21		22		23		24
9												
10		30		29		28		27		26		25
11												
12		31		32		33		34		35		36
13												

A. Description of original monument and accessories and/or subsequent restoration:

- 1852: Original Survey by George Adair - B.T.'s - Y. Birch, 30" - N39°W - 9 lks (found stump); Sugar, 8" - S63.5°E - 20 lks (not evident).
- 1982: L.C.R.C. No. 521 by George B. Wilson, RLS No 17607, states that he found the stump of Yellow Birch and mark of old blaze and found mound of ground where sugar maple was located. He set a "HDR Monument" at corner. TIES: Deep-1 - 2 feet North and 2 feet East.

B. Description of corner evidence found and/or method applied in restoring or reestablishing corner:

In our 1995 Remonumentation Survey in T37N-R25W, we recovered a 3/4 inch diameter aluminum rod with 3-1/4 inch diameter aluminum cap marked "MENOMINEE COUNTY SURVEY CORNER" (Bernitsen "HDR" Monument) at a newer fence corner. We also found the stump of the 30" Yellow Birch Original Bearing Tree. Since Wilson set this corner in 1982, a new fence has been constructed and the area to the SE of the corner is used for pasturing cows. We were unable to identify the location of the Maple B.T. We accepted the HDR Monument as a careful and faithful perpetuation of the position of the original corner.

C. Description of monument for corner and accessories established to perpetuate locating the position of the corner:

Accepted existing 3/4 inch diameter aluminum rod with 3-1/4 inch diameter aluminum cap:

5" dia. Cedar	N50°E	10.07 feet	Scr. NBT
10" dia. Cedar	S51°E	42.99 feet	Scr. NBT
12" dia. Cedar	S73°W	41.70 feet	Scr. NBT
24" dia. White Spruce	N15°W	31.24 feet	Scr. NBT

NOTE: All bearings are magnetic bearings. All distances are measured with steel tape. Distances to trees are to nail in side of tree.

Signed by William Lenca  
Surveyor's Michigan License No. 26461

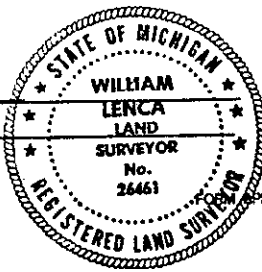

Date Dec. 13, 1995