

Approved by Menominee County
 Land Survey Remonumentation
 Peer Group Under Act 345 Of
 P.A. Of 1990 On 12/27 1996
Mr. Davis RLS
 Chairman

LAND CORNER RECORDATION CERTIFICATE
 Filing Requirement of Act 74, Mich. P.A. 1970

For corners in
MENOMINEE
 (County)

Located In: Corner Code #

1. Public Land Survey T37N R 25W E08
 T R
 T R
 T R

2. Property Controlling S T R
 in Section S T R

3. Miscellaneous S T R
 Property in Sec. S T R

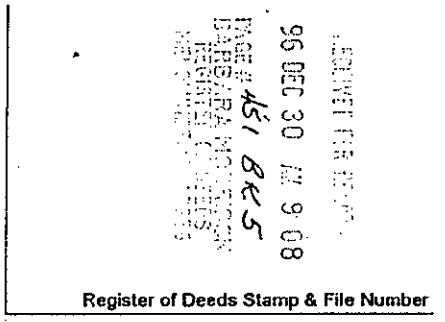

4. Lot No. _____, Recorded Plat _____
 5. Private Claims _____

I, William Lenca, in a field survey on Jun. 19, 1996 do hereby state that under requirements of P.A. 74, Michigan P.A. of 1970, the corner points mentioned in lines 1 and 2 above were in conformance with regulations and rules therefore as required in the current manual of survey instructions of the United States Department of the Interior, Bureau of Land Management or by a decree of a Court of Law and/or that the corner points mentioned in lines 3, 4 and 5 above were in conformance with the rules of the Michigan Board of Land Surveyors or by a Decree of a Court of Law, established, re-established, monumented, recovered, found as expressed below.

A	B	C	D	E	F	G	H	I	J	K	L	M
2	6	5	4	3	2	1						
3												
4	7	8	9	10	11	12						
5												
6	18	17	16	15	14	13						
7												
8	19	20	21	22	23	24						
9												
10	30	29	28	27	26	25						
11												
12	31	32	33	34	35	36						
13												

NOTE: Not more than 2 corners, all in the same town and range, may be recorded on this certificate.

A. Description of original monument and accessories and/or subsequent restoration:

- 1852: Original Survey by George Adair - B.T.'s - Cedar, 16" - N67°E - 28 lks.; Cedar, 15" - S38°W - 13 lks. All original evidence for this corner has been destroyed by county road improvements.
- 1982: L.C.R.C. No. 520 by George B. Wilson, RLS No. 17607, states: "Found iron pin under pavement in line with fences North and South - Set W-1-B Berntsen Monument at Corner." No B.T.'s given.
- 1982: Certified Survey No. 300 recorded by George B. Wilson, RLS No. 17607, shows this corner as it relates to other corners in Section 20, T37N-R25W. The Monument is described in the Legend as a W-1-B Mon. Recorded.

B. Description of corner evidence found and/or method applied in restoring or reestablishing corner:

We recovered a broken W-1-B Berntsen Monument in the centerline of County Road No. 374 East - West and in line with ancient fences running North and South. The position of the monument matched with distances given to adjoining corners in Certified Survey No. 300, fits with existing lines of occupation, and is accepted as the best available evidence of the position of the original corner.

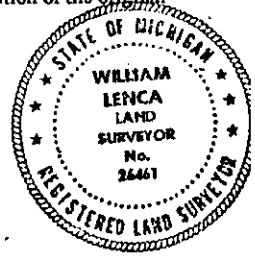

C. Description of monument for corner and accessories established to perpetuate locating the position of the corner:
 Set 5/8" x 24" Iron Rod/3-1/4" dia. Alum. cap stamped for corner location in Monument Box:

5/8" x 24" Iron Rod/2" dia. Alum. cap marked "WITNESS MARKER"	N06°E	32.96 feet	2' S.of Fence Post
5/8" x 24" Iron Rod/2" dia. Alum. cap marked "WITNESS MARKER"	S65°E	70.02 feet	1' N.of Tel. Box
6" dia. Pine	S01°W	47.09 feet	Scr. NBT
22" dia. Pine	N33°W	60.18 feet	Scr. NBT
Metal Survey Sign Post	N06°E	33.80 feet	

NOTE: All bearings are magnetic bearings. All distances are measured with steel tape. Distances to trees are to nail in side of tree.

Signed by William Lenca Date Dec. 23, 1996
 Surveyor's Michigan License No. 26461

451