

LAND CORNER RECORDATION CERTIFICATE
Filing Requirement of Act 74, Mich. P.A. 1970

P.A. Of 1996 On 12/27, 1996
Mer. Davis
Chairman

For corners in

MENOMINEE (County)	Located In:	Corner Code #
1. Public Land Survey	T <u>37N</u> R <u>25W</u>	<u>E03</u>
	T <u> </u> R <u> </u>	<u> </u>
	T <u> </u> R <u> </u>	<u> </u>
	T <u> </u> R <u> </u>	<u> </u>
2. Property Controlling in Section	S <u> </u> T <u> </u> R <u> </u>	<u> </u>
	S <u> </u> T <u> </u> R <u> </u>	<u> </u>
3. Miscellaneous Property in Sec.	S <u> </u> T <u> </u> R <u> </u>	<u> </u>
	S <u> </u> T <u> </u> R <u> </u>	<u> </u>

56 DEC 30 AM 9:07
PAGE # 449 BK 5
DARRELLA MORGANSON
REGISTERED LAND SURVEYOR
REGISTERED LAND SURVEYOR
Register of Deeds Stamp & File Number

4. Lot No. _____, Recorded Plat _____
5. Private Claims _____

I, William Lenca, in a field survey on Aug 20, 19 96 do hereby state that under requirements of P.A. 74, Michigan P.A. of 1970, the corner points mentioned in lines 1 and 2 above were in conformance with regulations and rules therefore as required in the current manual of survey instructions of the United States Department of the Interior, Bureau of Land Management or by a decree of a Court of Law and /or that the corner points mentioned in lines 3, 4 and 5 above were in conformance with the rules of the Michigan Board of Land Surveyors or by a Decree of a Court of Law, established, re-established, monumented, recovered, found as expressed below:

NOTE: Not more than 2 corners, all in the same town and range, may be recorded on this certificate.

	A	B	C	D	E	F	G	H	I	J	K	L	M
1													
2	6					4		3		2			1
3													
4	7					9		10		11			12
5													
6	18					16		15		14			13
7													
8	19					21		22		23			24
9													
10	30					28		27		26			25
11													
12	31					33		34		35			36
13													

A. Description of original monument and accessories and/or subsequent restoration:

1852: Original Survey by George Adair - B.T.'s - Sugar Maple, 16" - S64.5°W - 29 lks.; Hemlock, 16" - N62°E - 25 lks. All original evidence for this corner has been destroyed by logging operations.

B. Description of corner evidence found and/or method applied in restoring or reestablishing corner:

We computed the single proportional location for this corner, traversed in to it and searched the area. We found no evidence of the original corner accessories, or evidence of subsequent restoration. This location fits reasonably well with GLO terrain calls to the top of a ridge 7.9 chains East and to a swamp edge 6.1 chains West, and is accepted as a careful and faithful reestablishment of the position of the original corner.

C. Description of monument for corner and accessories established to perpetuate locating the position of the corner:
Set 2" dia. Aluminum Pipe/3-1/4" dia. Alum. cap stamped for corner location:

9" dia. Maple	N04°E	29.12 feet	Scr. NBT
5" dia. Maple	S73°E	10.31 feet	Scr. NBT
5" dia. Maple	S10°W	10.74 feet	Scr. NBT
9" dia. Maple	N81°W	20.93 feet	Scr. NBT
Metal Survey Sign Post	S35°E	1.00 foot	

NOTE: All bearings are magnetic bearings. All distances are measured with steel tape. Distances to trees are to nail in side of tree.

Signed by William Lenca
Surveyor's Michigan License No. 26461

Date Dec. 26, 1996

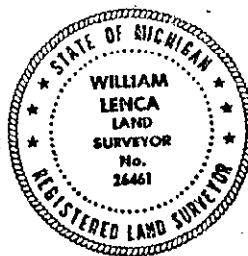

449